

PRESSURE REDUCING VALVES

Service Parts Information

X(C)G-10-**-30

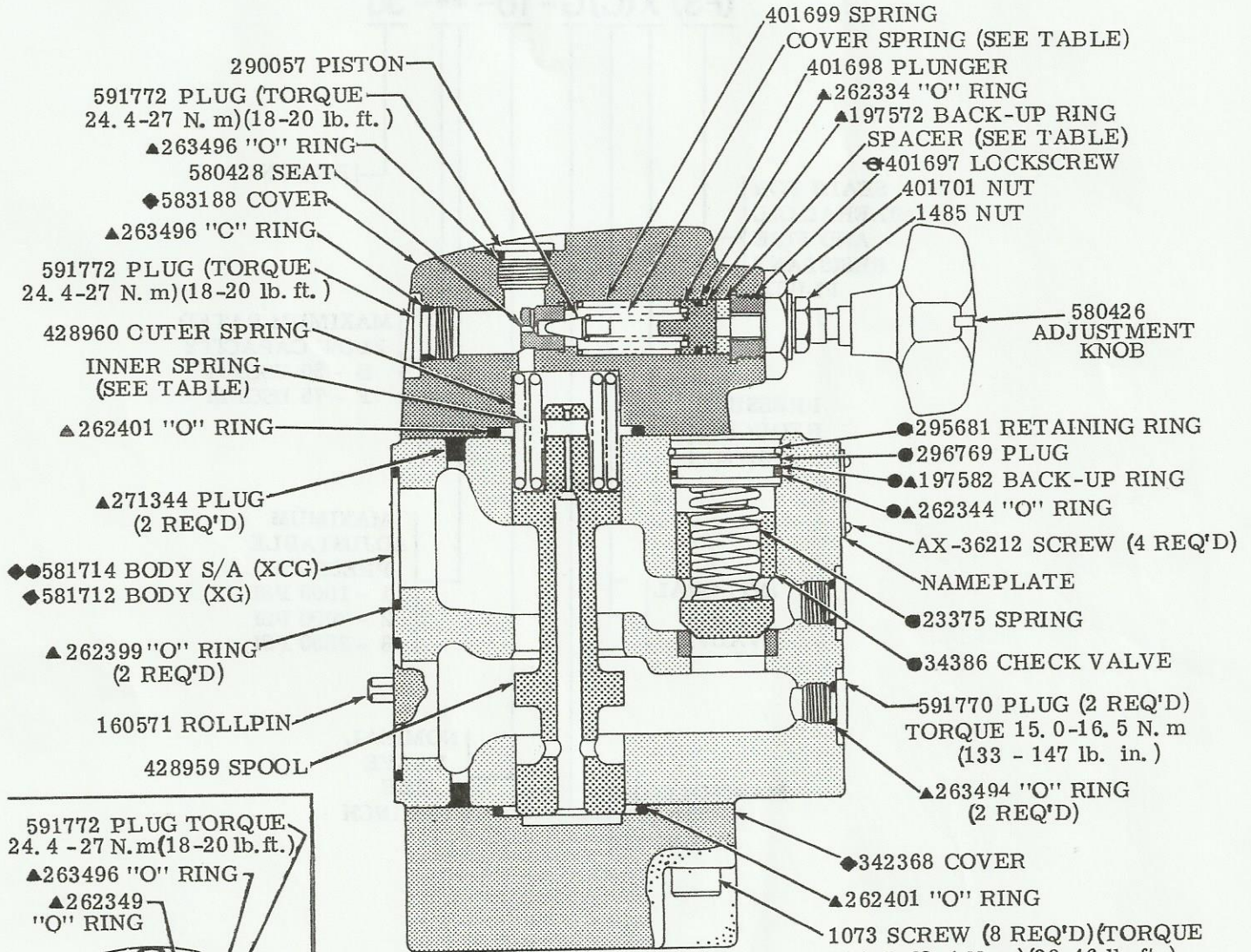

591772 PLUG TORQUE
 24.4 - 27 N.m(18-20 lb. ft.)
 ▲263496 "O" RING
 ▲262349 "O" RING

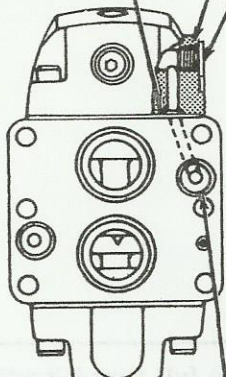

●XCG MODELS ONLY

◆NOT AVAILABLE FOR SALE

MODEL	INNER SPRING	COVER SPRING	SPACER	PRESS RANGE PSI	FLOW RATE GPM
X(C)G-10-1B-30	—	2280	—	100-1000	25
X(C)G-10-1F-30	428961	—	—	165-1000	50
X(C)G-10-2B-30	—	583937	—	225-1000	75
X(C)G-10-2F-30	428961	—	—	100-2000	25
X(C)G-10-3F-30	—	401700	386715	165-2000	50
				225-2000	75
				225-2850	75

▲SERVICE ALL UNITS W/F3 SEAL KIT 919852

⊕INSTALL LOCKSCREW WITH STEPPED O. D. END TOWARD SPACER OR PLUNGER

MODEL CODE BREAKDOWN

(F3) X(C)G-10-**-30

SEALS FOR
MINERAL OIL
AND FIRE
RESISTANT
FLUIDS

PRESSURE
REDUCING
VALVE

INTEGRAL
CHECK
VALVE

MANIFOLD OR
SUBPLATE
MOUNTED

DESIGN

MAXIMUM RATED
FLOW CAPACITY
B - 50 USGPM
F - 75 USGPM

MAXIMUM
ADJUSTABLE
PRESSURE
1 - 1000 PSI
2 - 2000 PSI
3 - 2850 PSI

NOMINAL
VALVE
SIZE
1 - 1/4 INCH

MODEL	SEALING METHOD	SEALING MATERIAL	SEALING METHOD	SEALING MATERIAL
10-10-10-10-10	10-10-10-10-10	10-10-10-10-10	10-10-10-10-10	10-10-10-10-10
10-10-10-10-10	10-10-10-10-10	10-10-10-10-10	10-10-10-10-10	10-10-10-10-10
10-10-10-10-10	10-10-10-10-10	10-10-10-10-10	10-10-10-10-10	10-10-10-10-10
10-10-10-10-10	10-10-10-10-10	10-10-10-10-10	10-10-10-10-10	10-10-10-10-10
10-10-10-10-10	10-10-10-10-10	10-10-10-10-10	10-10-10-10-10	10-10-10-10-10

For satisfactory service life of these components in industrial applications, use full flow filtration to provide fluid which meets ISO cleanliness code 18/15 or cleaner. Selections from Vickers OFP, OFR, and OFRS series are recommended.