

VICKERS

Service Parts Information

Single
Transmission
Pump With
Single
Vane Pump

TA19V20*-21

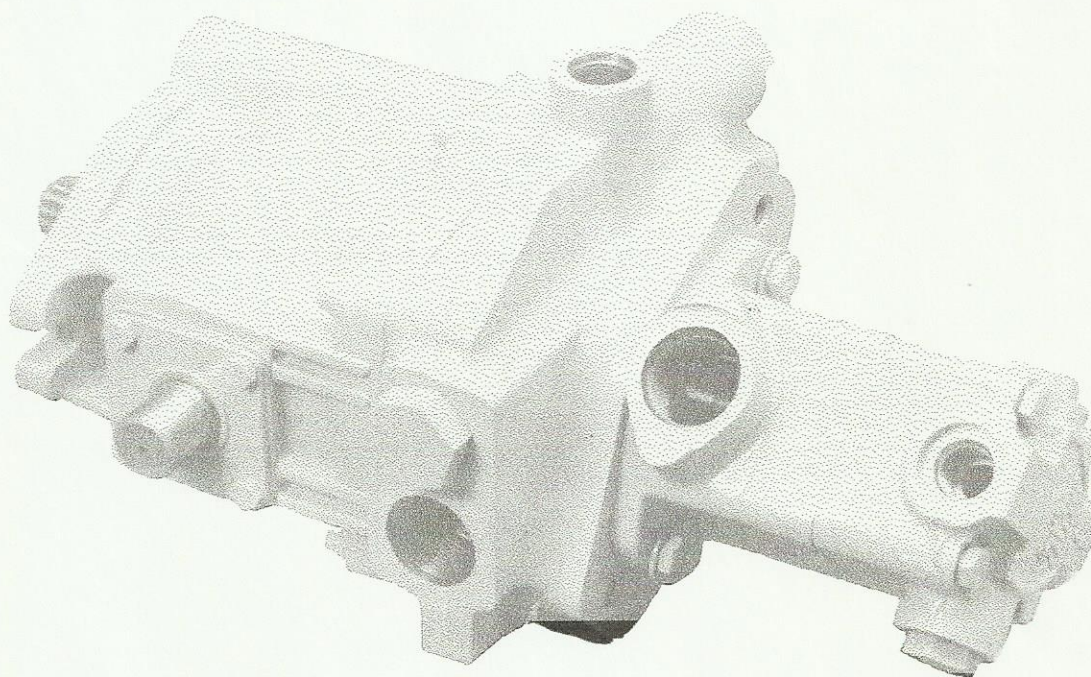

Vickers, Incorporated

1401 Crooks Road
Troy, Michigan 48084

Revised 8-1-87

M-2846-S

- 433026 PLUG
- ▲154129 "O" RING (2 REQ'D)
- 433025 SPRING
- 433024 PISTON

COVER	MODEL
433030	TA19V20P-***T-***2*-21

DETERMINE COVER POSITION WITH THIS PORT

MODEL	SCREW (4 REQ'D) TORQUE 80 [±] 5 lb. ft.
TA19V20P-** 7*-****-21	9431
TA19V20P-** 8*-****-21	
TA19V20P-** 9*-****-21	
TA19V20P-**10*-****-21	96168
TA19V20P-**11*-****-21	
TA19V20P-**12*-****-21	
TA19V20P-**13*-****-21	

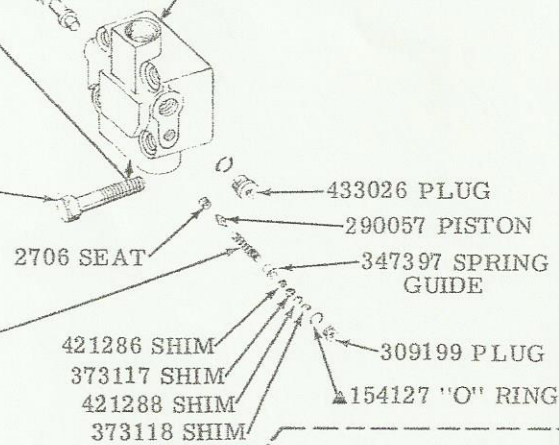

MODEL	PRESSURE SETTING	SPRING
TA19V20P-****-***A-21	250	252886
TA19V20P-****-***B-21	500	2280
TA19V20P-****-***C-21	750	
TA19V20P-****-***D-21	1000	435626
TA19V20P-****-***E-21	1250	
TA19V20P-****-***F-21	1500	
TA19V20P-****-***G-21	1750	2281
TA19V20P-****-***H-21	2000	
TA19V20P-****-***J-21	2250	
TA19V20P-****-***K-21	2500	

SCREW (4 REQ'D) TORQUE 80 [±] 5 lb. ft.	MODEL
9431	TA19V20F-** 7*-
	TA19V20F-** 8*-
	TA19V20F-** 9*-
96168	TA19V20F-**10*-
	TA19V20F-**11*-
	TA19V20F-**12*-
	TA19V20F-**13*-

239766 SPRING

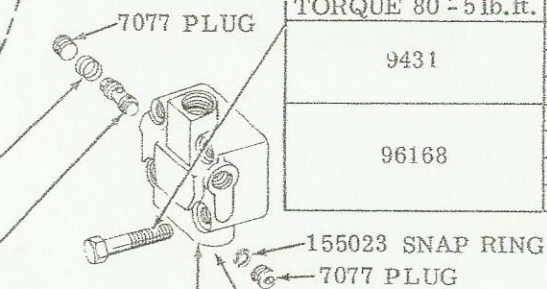

DETERMINE COVER POSITION WITH THIS PORT

COVER	MODEL
306314	TA19V20F-***T-***2*-21

MODEL	PRESSURE SETTING	CONTROL VALVES/A
TA19V20F-****-***C-21	750	232794
TA19V20F-****-***D-21	1000	232795
TA19V20F-****-***E-21	1250	232796
TA19V20F-****-***F-21	1500	232797
TA19V20F-****-***G-21	1750	232798
TA19V20F-****-***H-21	2000	232799
TA19V20F-****-***J-21	2250	233019
TA19V20F-****-***K-21	2500	233020

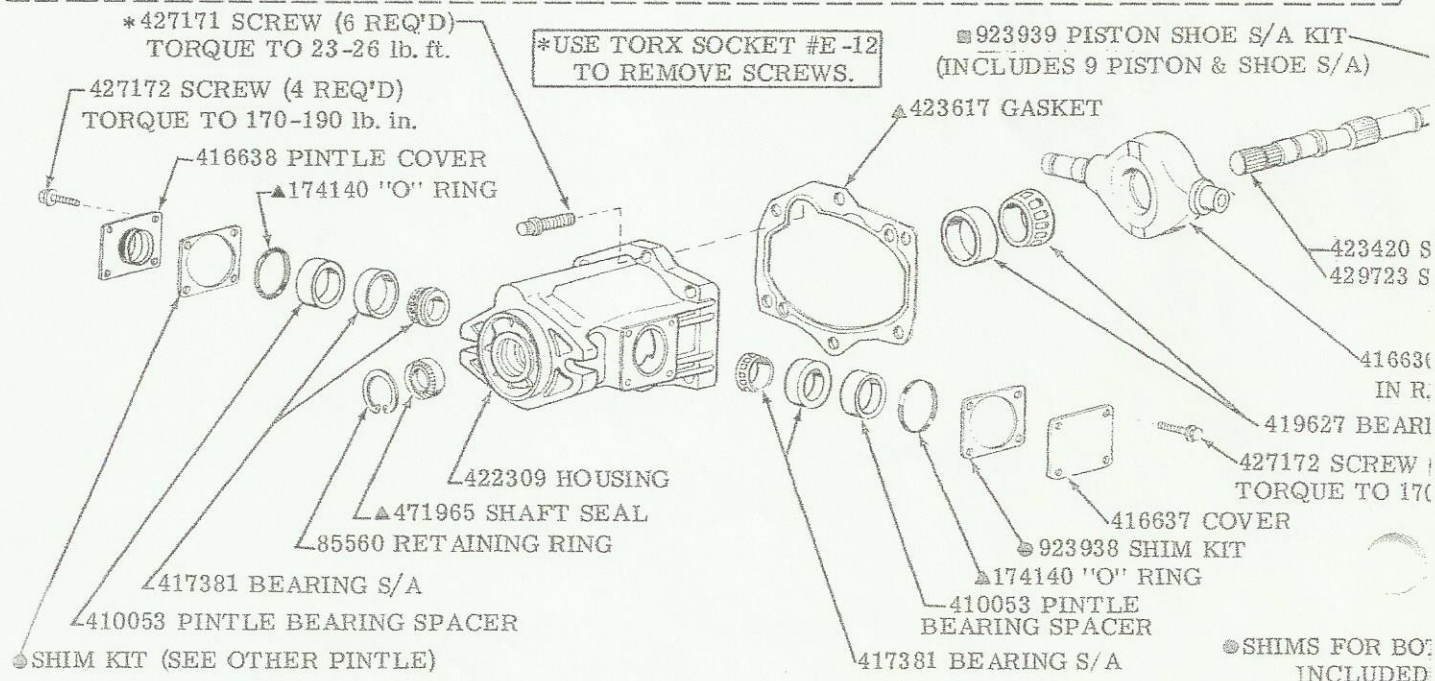

*USE TORX SOCKET #E-12 TO REMOVE SCREWS.

SHIMS FOR BO: INCLUDED

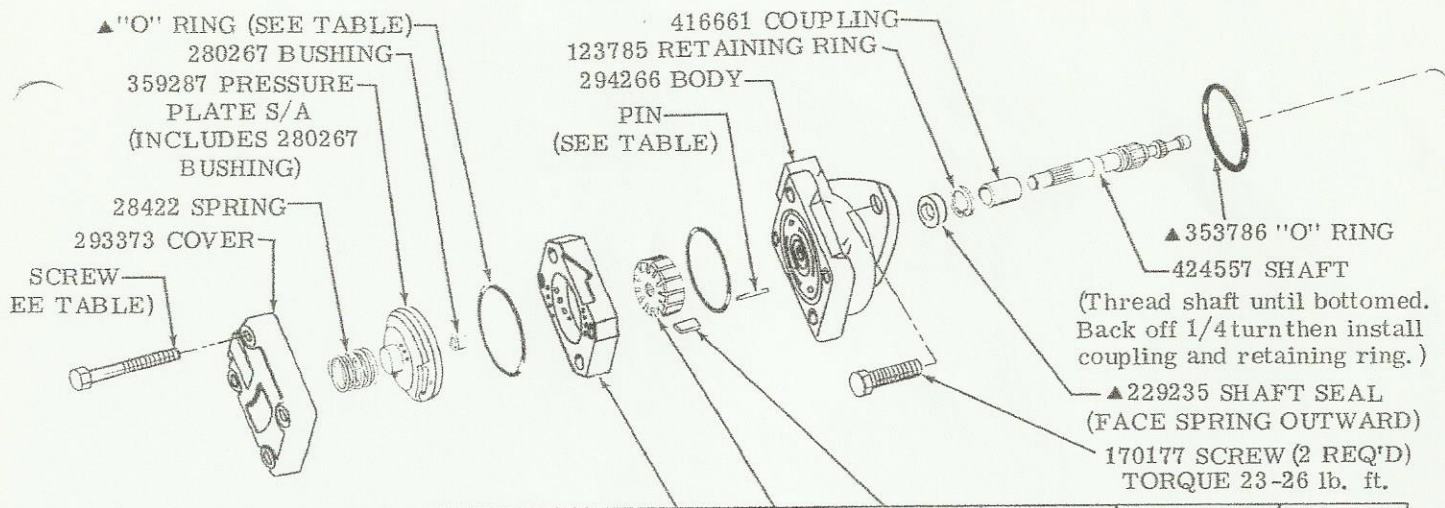

MODEL	SCREW (4 REQ'D) TORQUE TO 80 ± 5 lb. ft.	RING	ROTOR	VANE KIT (12 VANES)	▲ "O" RING (2 REQ'D)	CARTRIDGE KIT	PIN (2 REQ'D)
TA19V20*_** 7*_****-21	131486	328152	358330	923493	154090	923481	2478
TA19V20*_** 8*_****-21		331791				923483	
TA19V20*_** 9*_****-21		331789				923484	
TA19V20*_** 10*_****-21		374309				923620	
TA19V20*_** 11*_****-21	1319	328156	358332	923478	154090	923482	16662
TA19V20*_** 12*_****-21		331806				923486	
TA19V20*_** 13*_****-21		331807				923487	

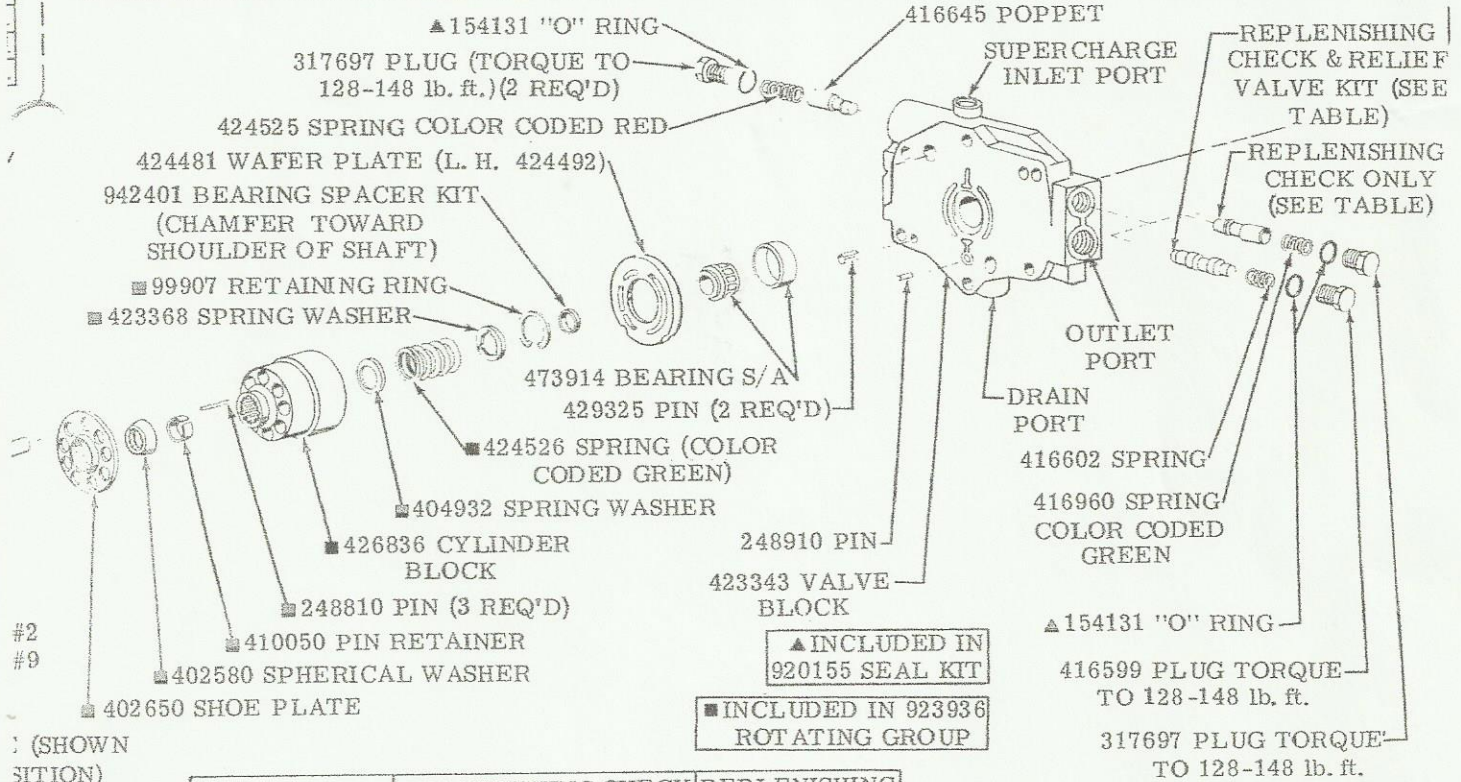

MODEL	REPLENISHING CHECK AND RELIEF VALVE KIT (2 REQ'D)	REPLENISHING CHECK (2 REQ'D)
TA19V20**_**R	942429 - 5000 PSI	—
TA19V20**_001	942430 - 3500 PSI	—
TA19V20**_**0	NONE	416645
TA19V20**_014	942428 - 3000 PSI	—
TA19V20**_016	942427 - 4000 PSI	—
TA19V20**_53	941189 - 4500 PSI	—

CAUTION
Replenishing check/reliefs and replenishing check valves are used in any combination in this equipment. The combinations are determined by the application. DO NOT interchange valve positions or a major malfunction of the equipment may result.

#2
#9
(SHOWN POSITION)
A
(D)
b. in.
VERS

MODEL CODE BREAKDOWN

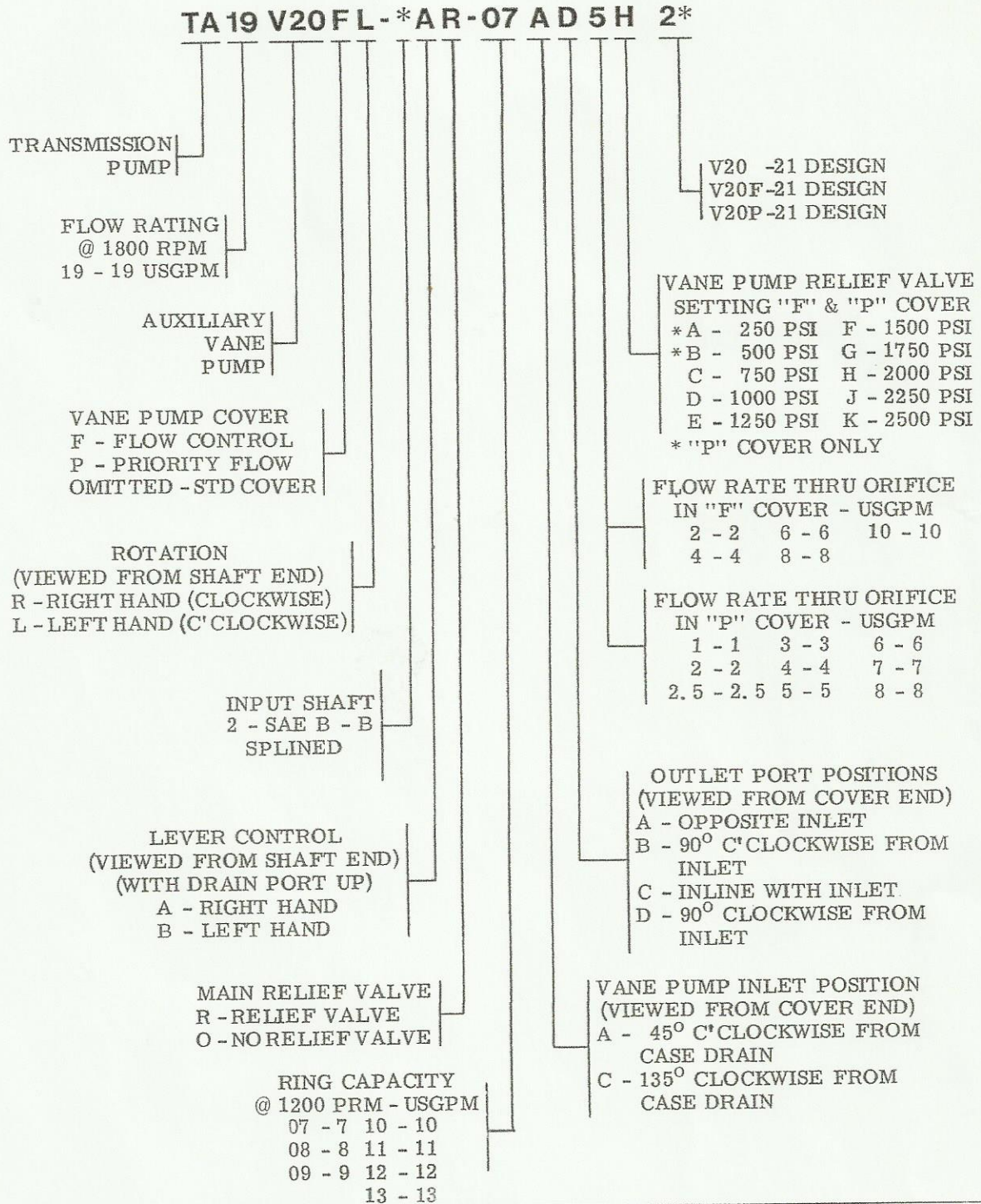

For satisfactory service life of these components, use full flow filtration to provide fluid which meets ISO cleanliness code 19/15 or cleaner. Selections from Vickers OFF, OFR, and OFRS series are recommended.