

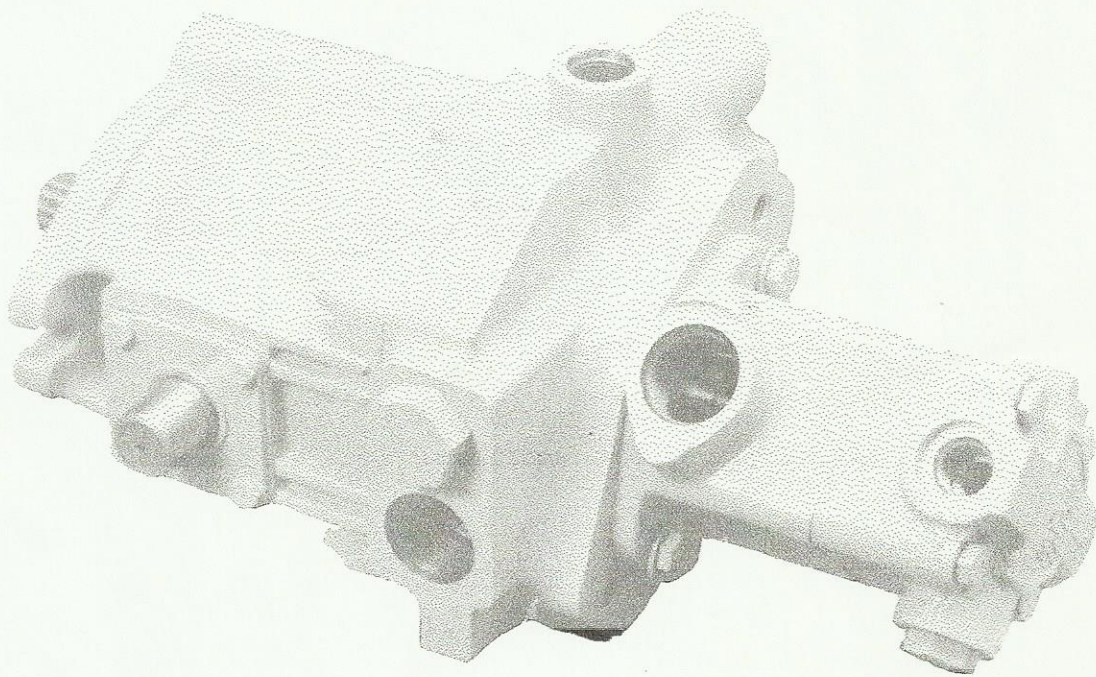

# Service Parts Information

Single  
Transmission  
Pump With  
Single  
Vane Pump

TA19V10\*-21



Vickers, Incorporated

1401 Crooks Road  
Troy, Michigan 48084

Revised 8-1-87

M-2845-S

"P" COVER	FLOW RATE	"F" COVER
388262	1	—
—	2	372851

RING CAPACITY (USGPM)	SCREW (4 REQ'D) TORQUE TO 40 ± 5 lb. ft.		
	P COVER	F COVER	STD COVER
4	432511	295344	1278
5	—	—	
6	295346	432511	
7	—	—	

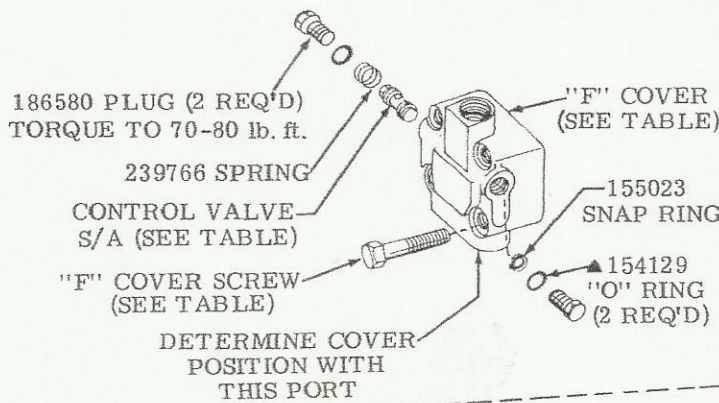
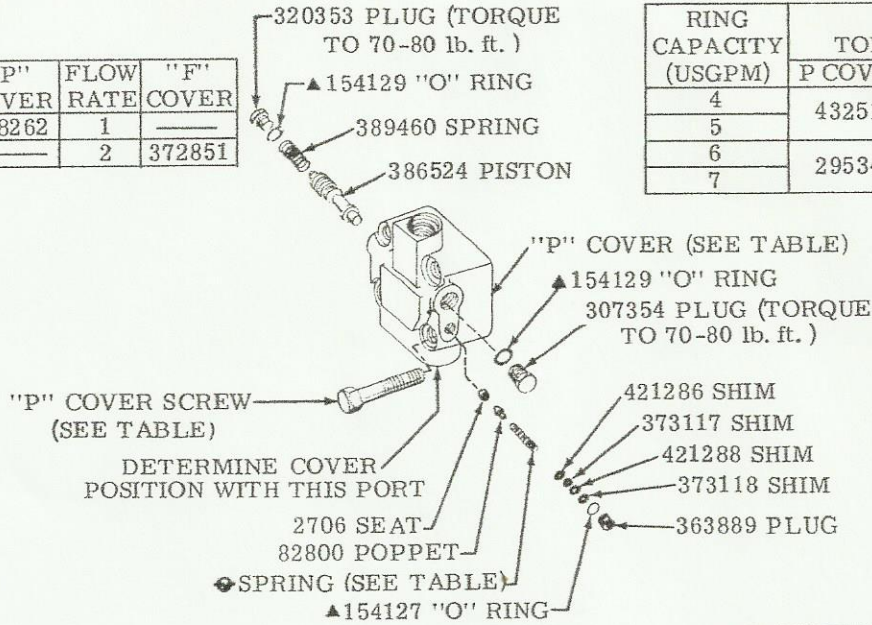

RELIEF VALVE CODE	SPRING	CONTROL VALVE S/A	PRESSURE SETTING
A	252886	229613	250 PSI
B	2280	233018	500 PSI
C		232794	750 PSI
D	2282	232795	1000 PSI
E		232796	1250 PSI
F	2281	232797	1500 PSI
G		232798	1750 PSI
H		232799	2000 PSI
J	2281	233019	2250 PSI
K		233020	2500 PSI

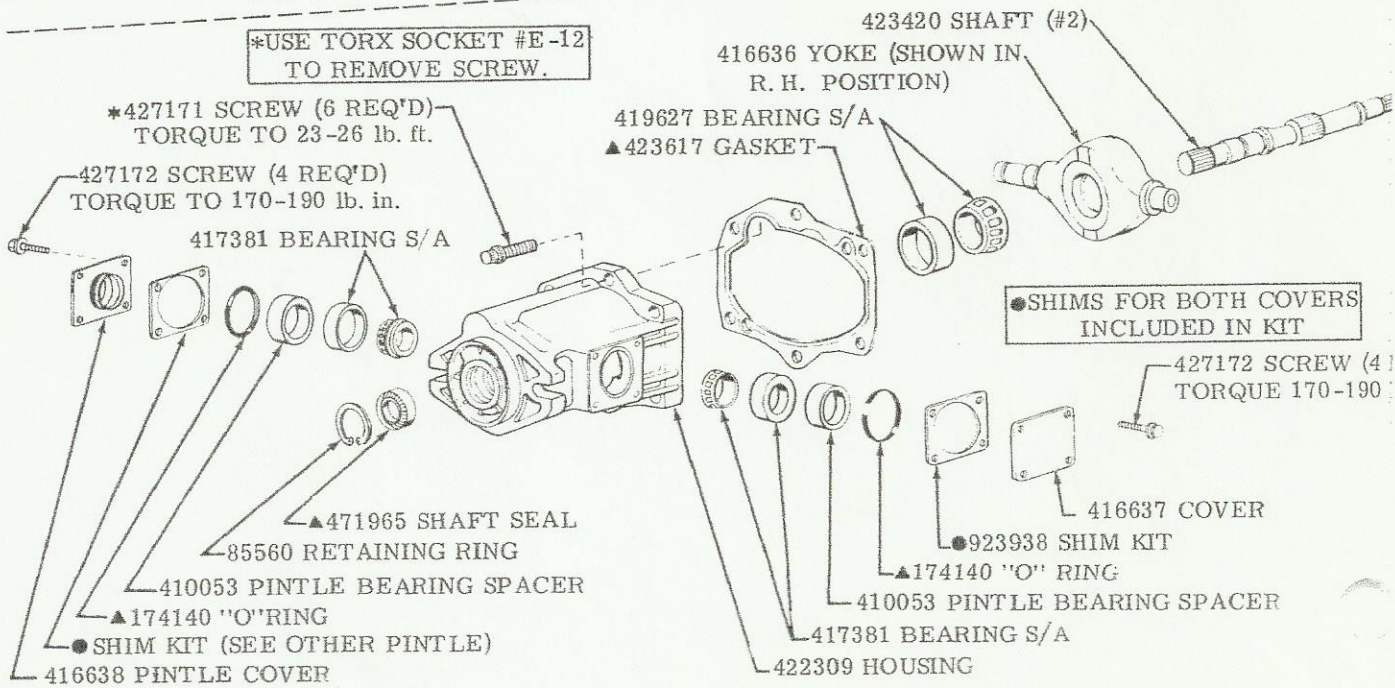

3728  
OUTI

24881

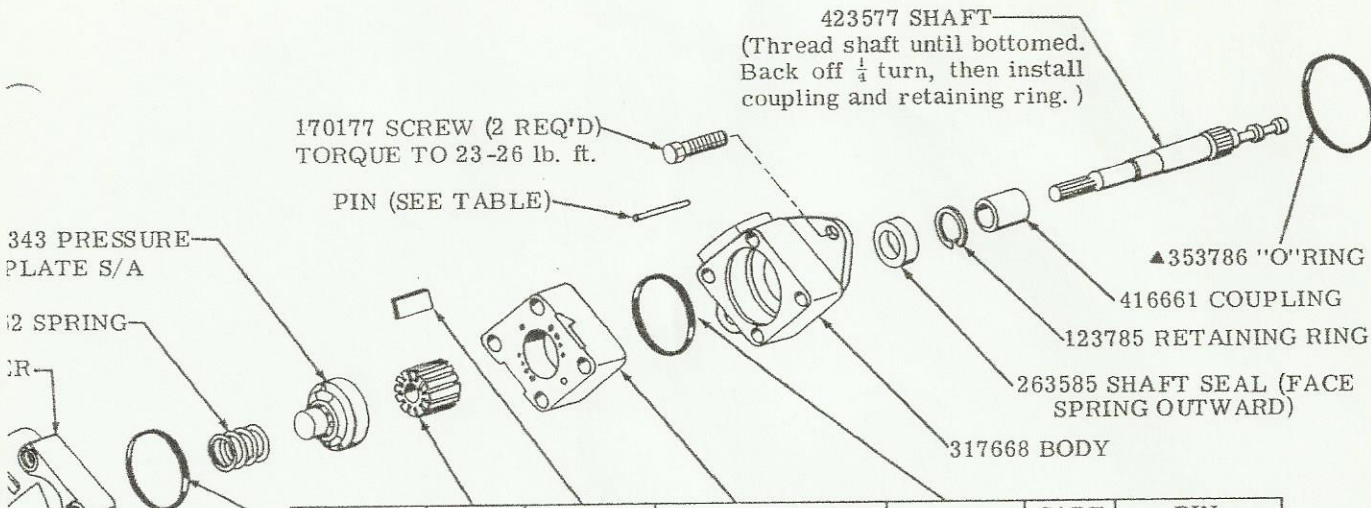

▲"O"RING	ROTOR	VANE KIT (12 Vanes)	RING	CAPACITY @ 1200 RPM	▲"O"RING	CART KIT	PIN (2 REQ'D)	
							F & P	STD
INCLUDED IN CARTRIDGE KIT								
199822	351247	923500	317677	4 USGPM	199823	923469	2456	39640
			317678	5 USGPM		923468		
	357286	923501	355641	6 USGPM		923497		
			331813	7 USGPM		923498		

OVER SCREW  
(SEE TABLE)

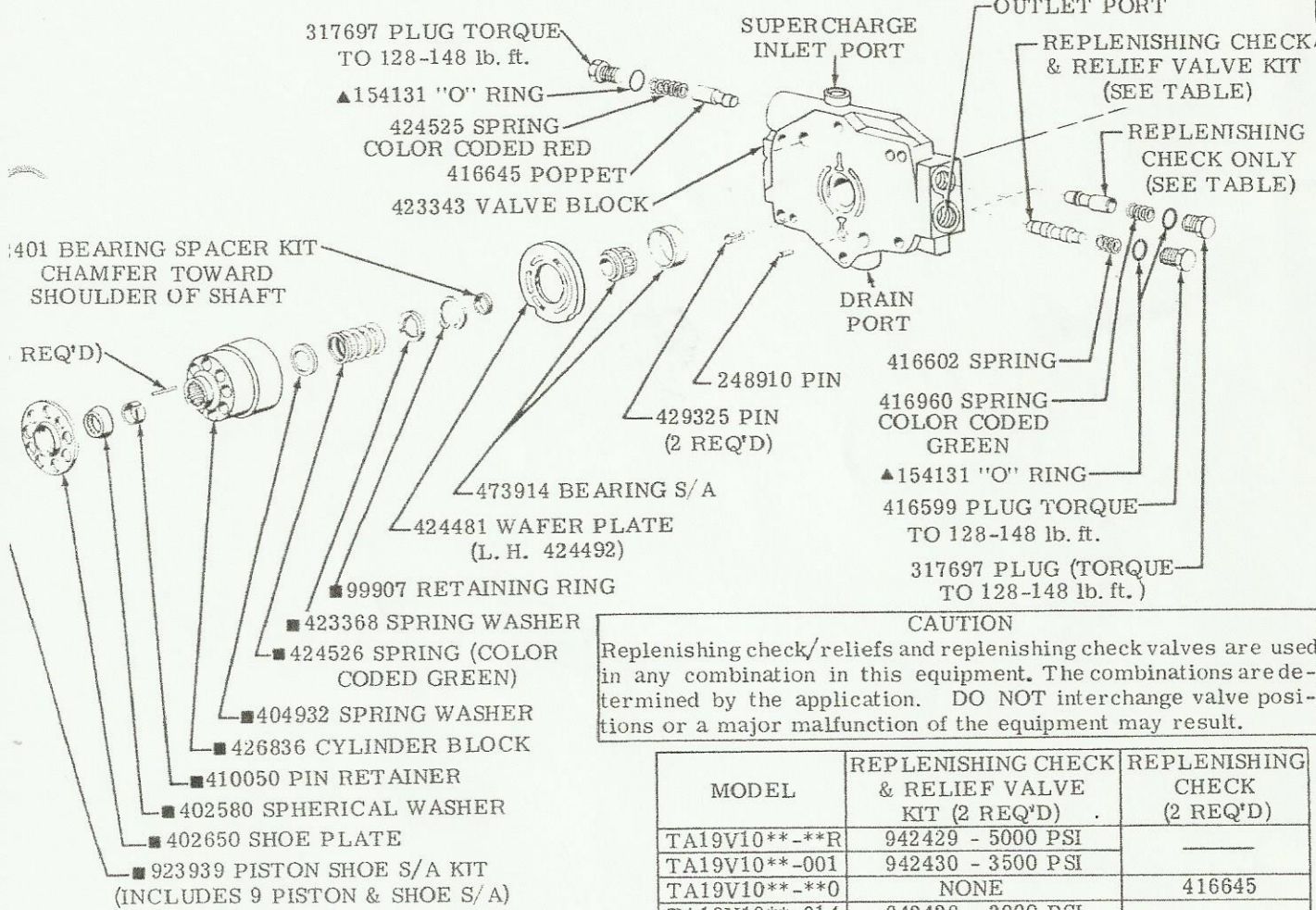

**CAUTION**

Replenishing check/reliefs and replenishing check valves are used in any combination in this equipment. The combinations are determined by the application. DO NOT interchange valve positions or a major malfunction of the equipment may result.

MODEL	REPLENISHING CHECK & RELIEF VALVE KIT (2 REQ'D)	REPLENISHING CHECK (2 REQ'D)
TA19V10**-**R	942429 - 5000 PSI	—
TA19V10**-001	942430 - 3500 PSI	—
TA19V10**-**0	NONE	416645
TA19V10**-014	942428 - 3000 PSI	—
TA19V10**-016	942427 - 4000 PSI	—
TA19V10**-53	941189 - 4500 PSI	—

▲ INCLUDED IN 920156 SEAL KIT    ■ INCLUDED IN 923936 ROTATING GROUP KIT

# MODEL CODE BREAKDOWN

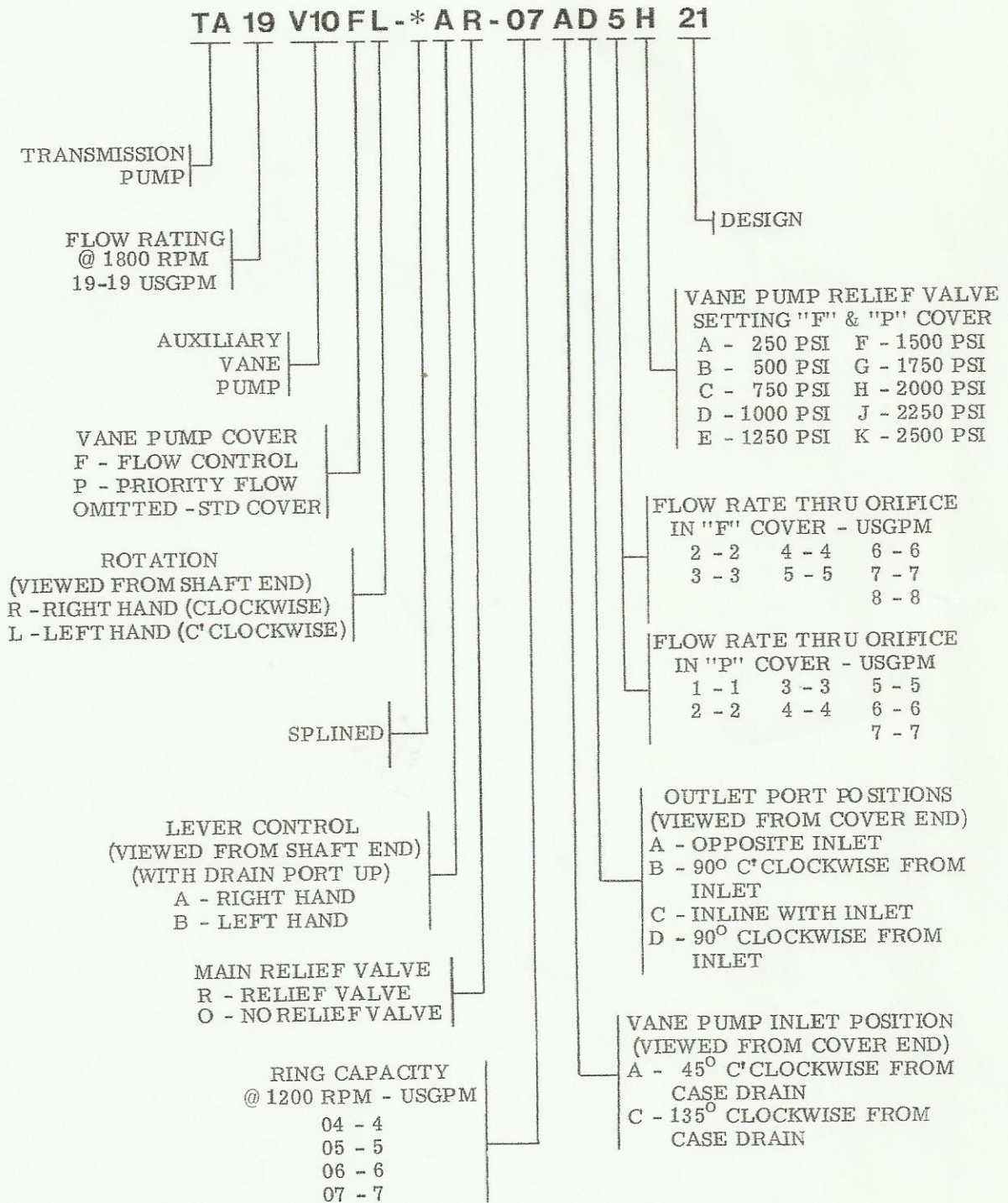

For satisfactory service life of these components, use full flow filtration to provide fluid which meets ISO cleanliness code 19/15 or cleaner. Selections from Vickers OFFP, OFR, and OFRS series are recommended.