

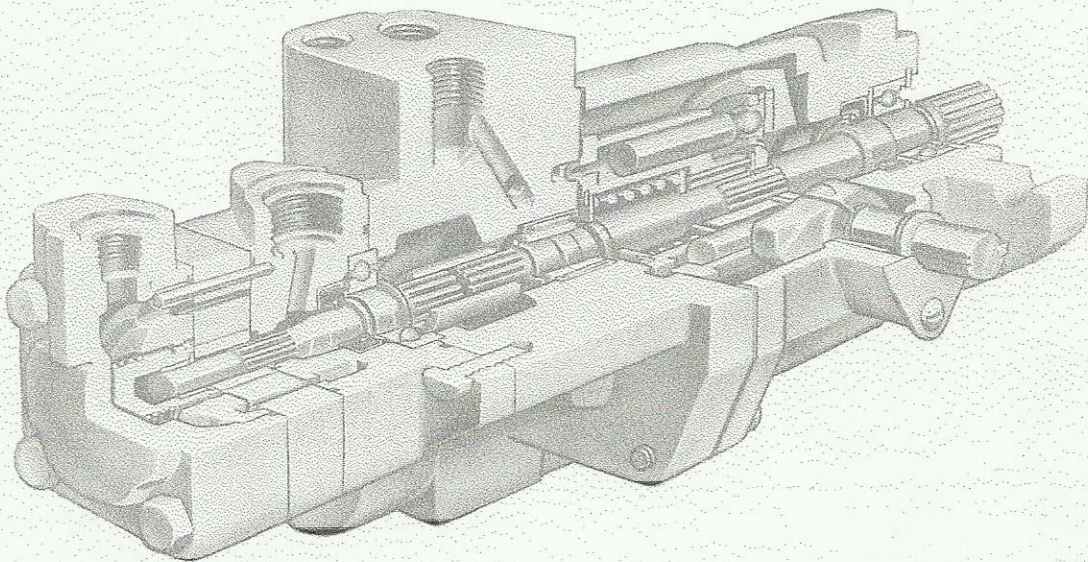

Service Parts Information

Transmission
Package

TA15V10(*)-11 Design



Vickers, Incorporated

1401 Crooks Road
Troy, Michigan 48084

Revised 9-1-87

M-2809-S

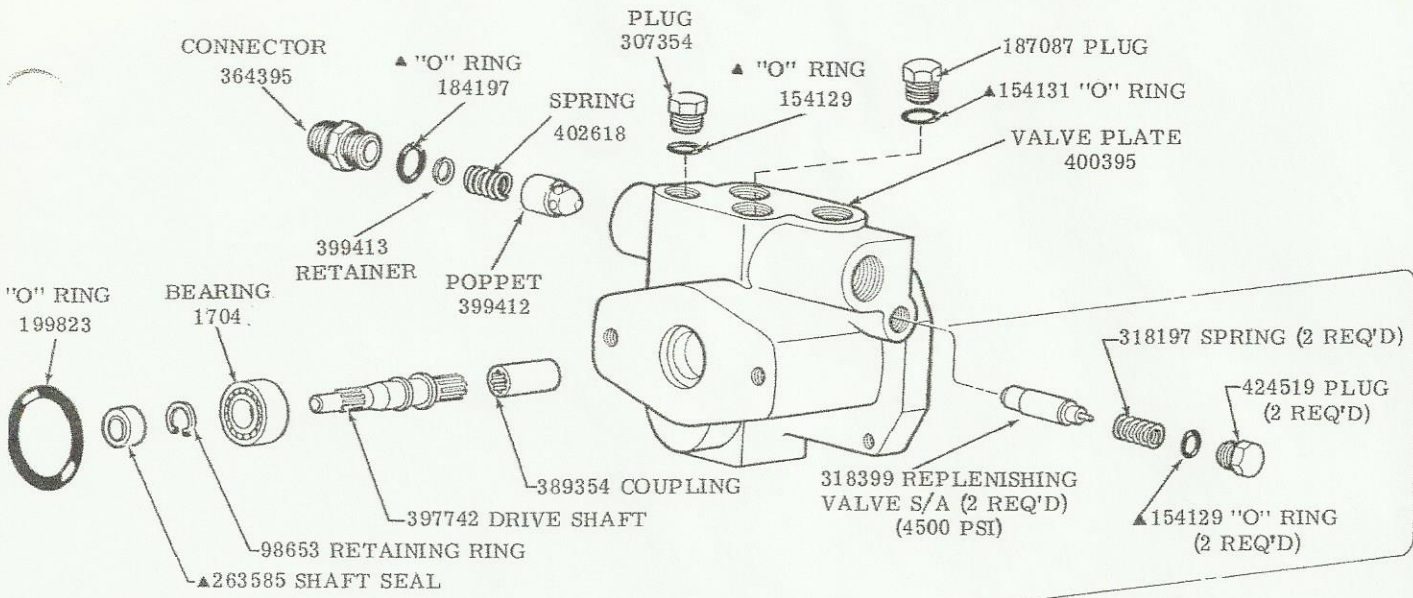

WASHER (2 REQ'D)
 NUT (2 REQ'D)
 TO 42-45 lb. ft.

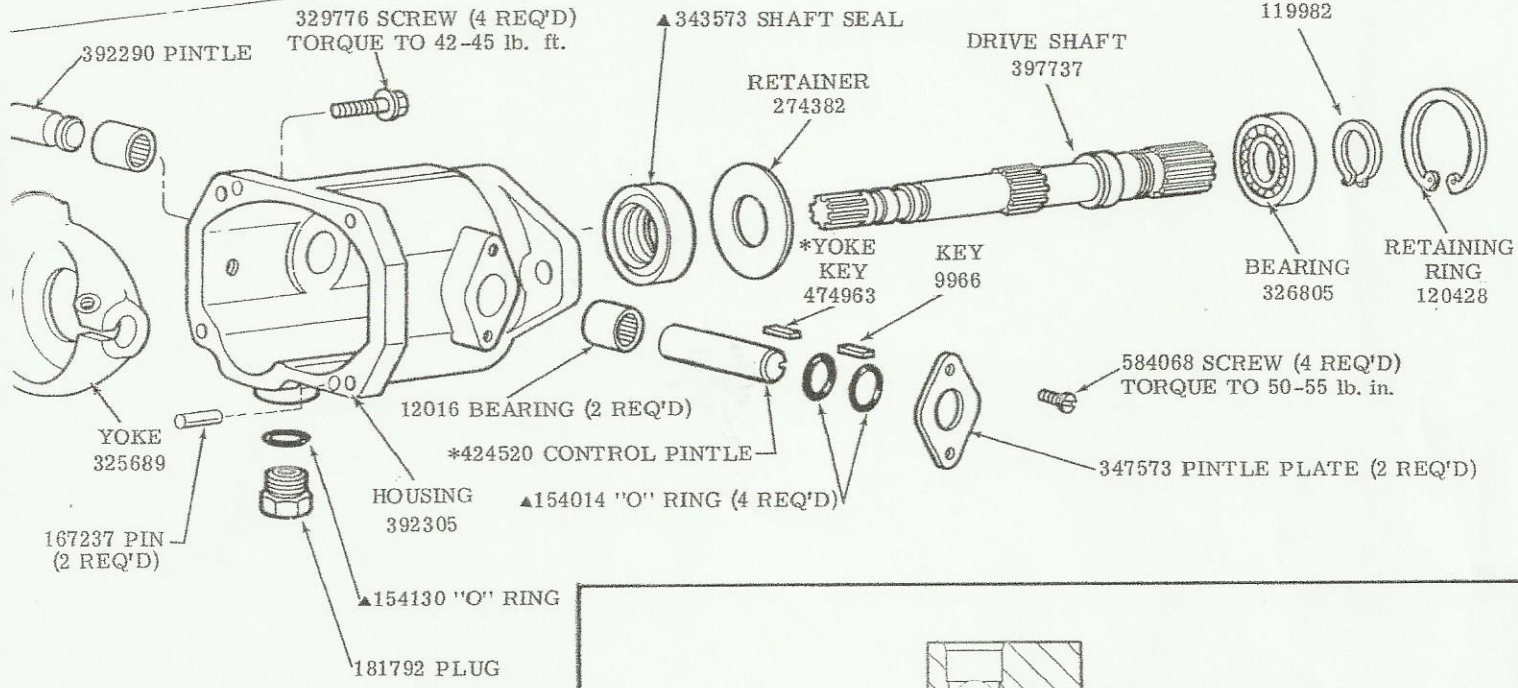

*INCLUDED IN 942425 CONTROL PINTLE KIT

SWASH PLATE	ROTATING GROUP KIT
239077	923062

▲ INCLUDED IN 923834 SEAL KIT

■ INCLUDED IN CARTRIDGE KIT

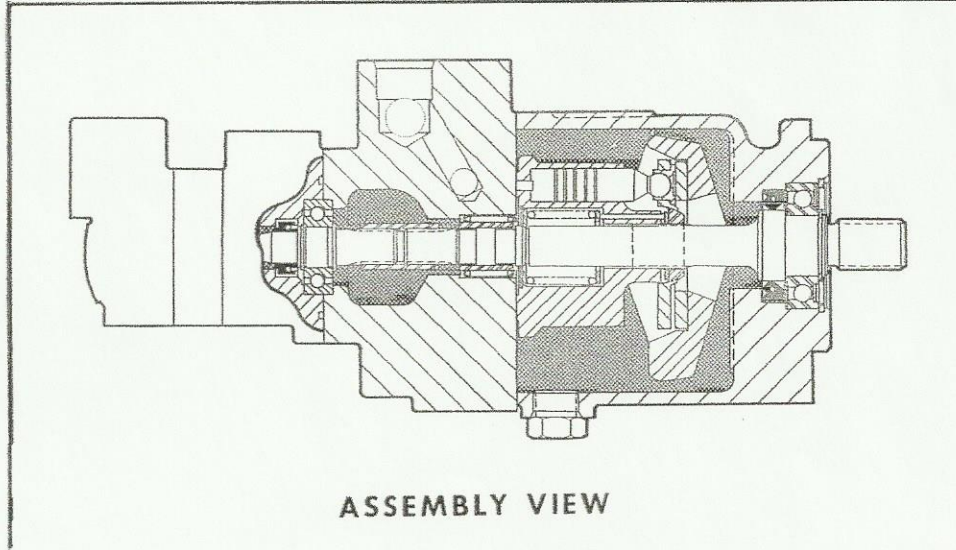

ASSEMBLY VIEW

MODEL	ROTOR	VANE KIT (12 VANES)	RING	PIN	SCREW	CART KIT
V10-**1*-**-20			317674			923471
V10-**2*-**-20	317681	923499	317675	231042	11156	923470
V10-**3*-**-20			317676			923496
V10-**4*-**-20	351247	923500	317677	2456		923469
V10-**5*-**-20			317678		1278	923468
V10-**6*-**-20	357286	923501	355641	351963		923497
V10-**7*-**-20			331813			923498

REFER TO M-2005-S FOR
V10F & V10P COVER DATA

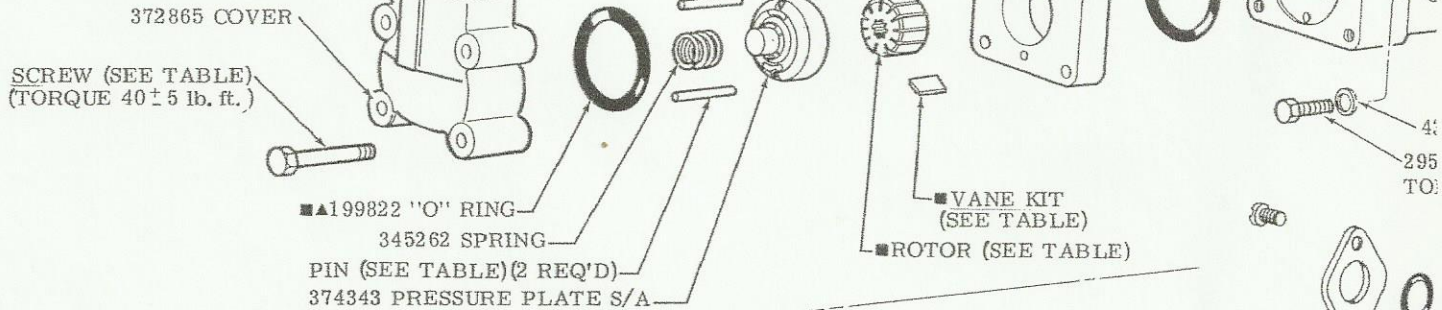

1306 SCREW
(2 REQ'D)
TORQUE TO
75-80 lb. ft.

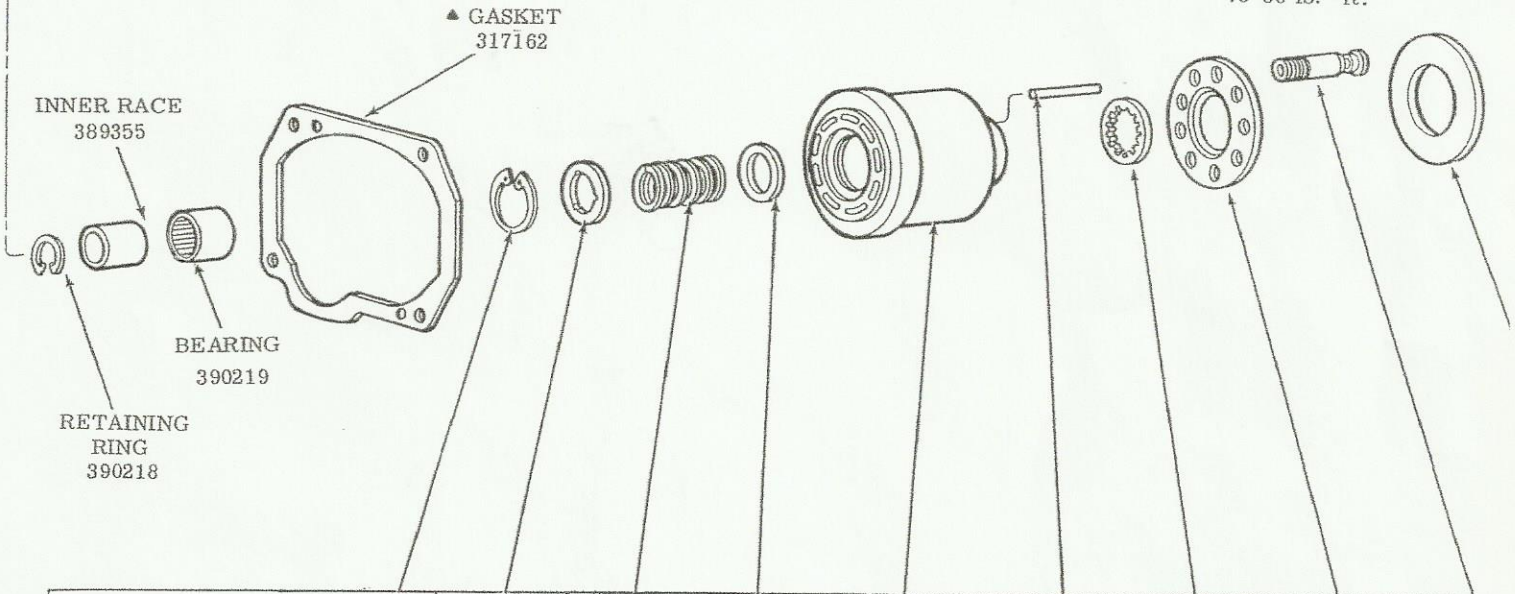

MODEL DESIGNATION	RETAINING RING	LIFT LIMITER	SPRING	THRUST WASHER	CYLINDER BLOCK	PINS (3 REQ'D)	SPHERICAL WASHER	SHOE PLATE	PISTON I (9 PISTON)
	SERVICED IN ROTATING GROUP KIT								
TA15V**-11	93509	245223	247294	241954	260860	248811	423324	275961	941887

MODEL CODE BREAKDOWN

TA 15 V(*) - 1 - L - S - 1 T 7 - C B - 11 L ***

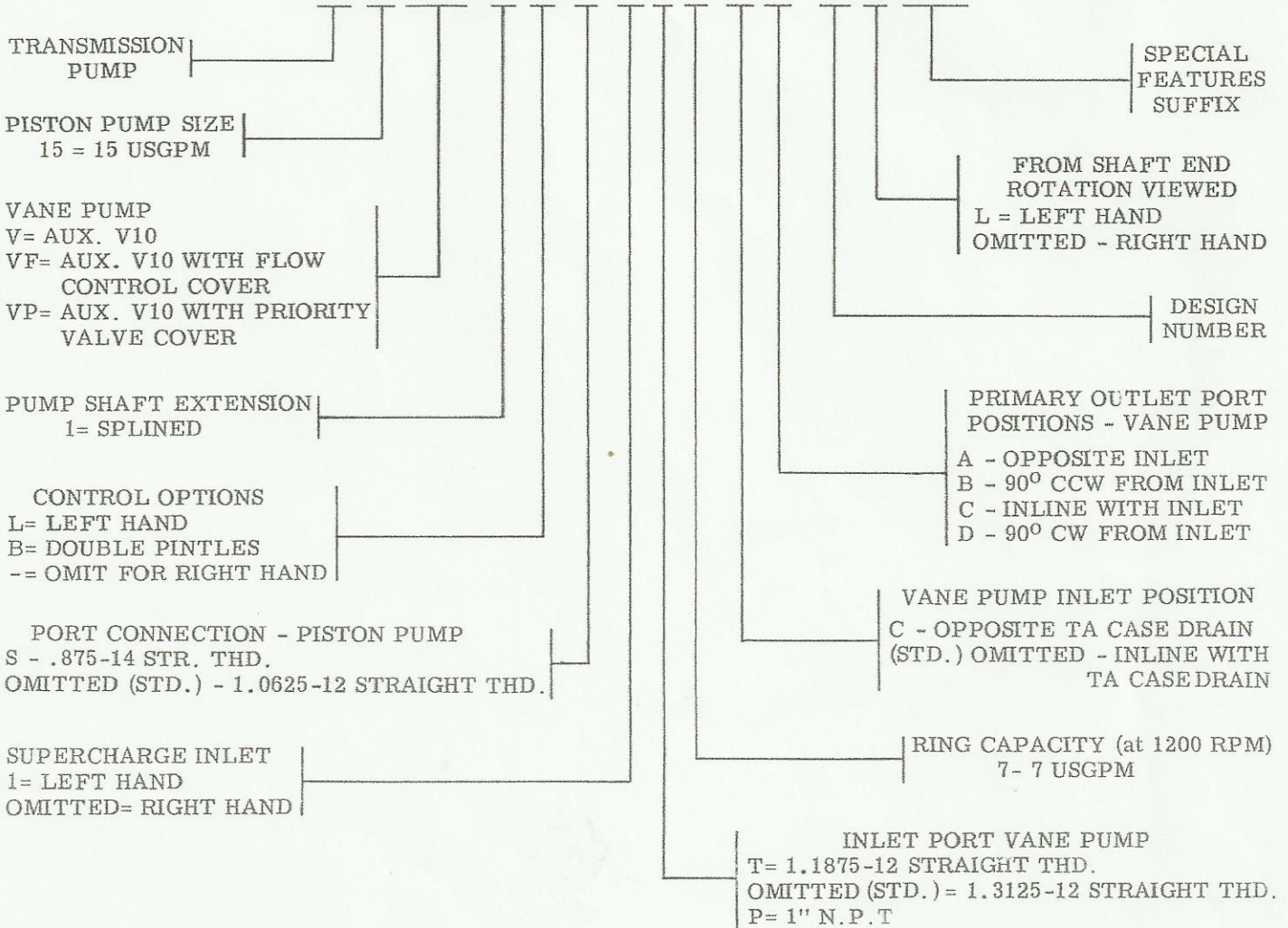

For satisfactory service life of these components, use full flow filtration to provide fluid which meets ISO cleanliness code 19/15 or cleaner. Selections from Vickers OFP, OFR, and OFRS series are recommended.

Litho in U.S.A.