

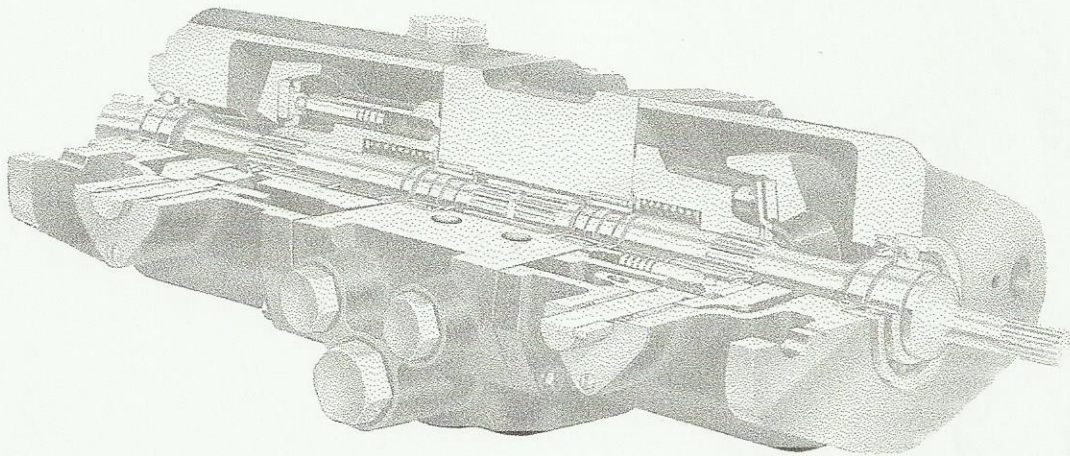

# Service Parts Information

Transmission  
Package

TA1515V-10/12 Design



Vickers, Incorporated

1401 Crooks Road  
Troy, Michigan 48084

Revised 1-1-88 M-2851-S

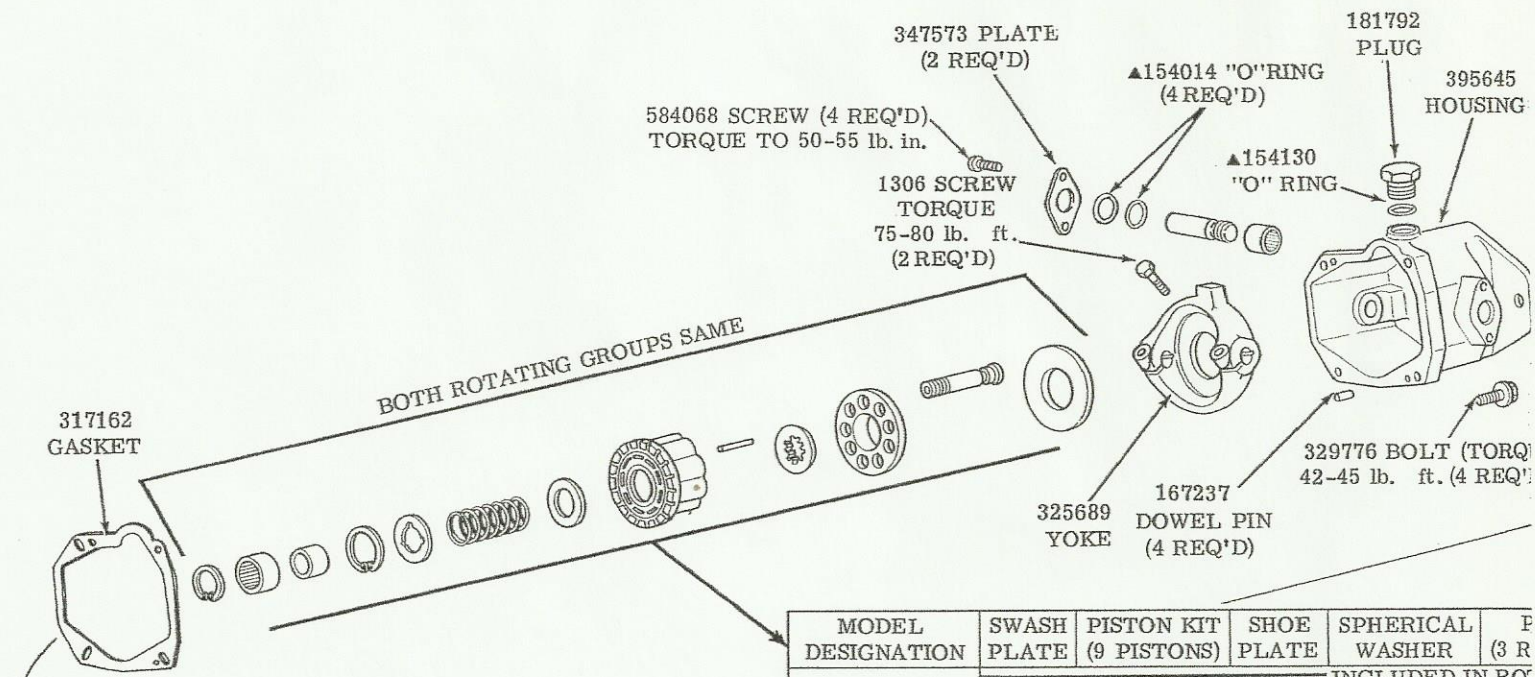

MODEL DESIGNATION	SWASH PLATE	PISTON KIT (9 PISTONS)	SHOE PLATE	SPHERICAL WASHER	P (3 R)
TA1515V* -12	239077	941887	275961	423324	24

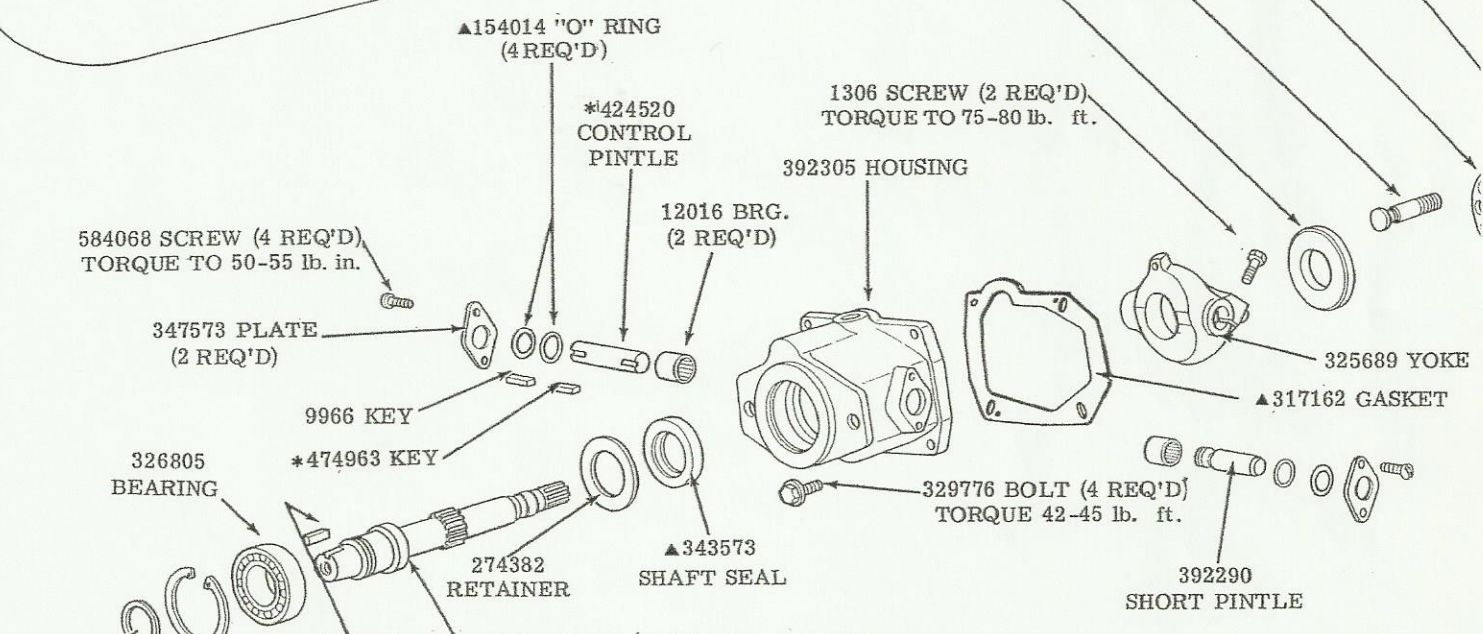

KEY #	SHAFT #	MODEL DESIGNATION
—	397737	TA1515V-1**-**1-12
58303	397736	TA1515V-2**-**1-12

\*INCLUDED IN 942425 PINTLE KIT



AV10P-\*\*\*K-\*\*\*10(L)

RING CAPACITY	SCREW (4 REQ'D) TORQUE 40 ± 5 lb. ft.
1, 2, 3	432509
4, 5	295344
6, 7	432511

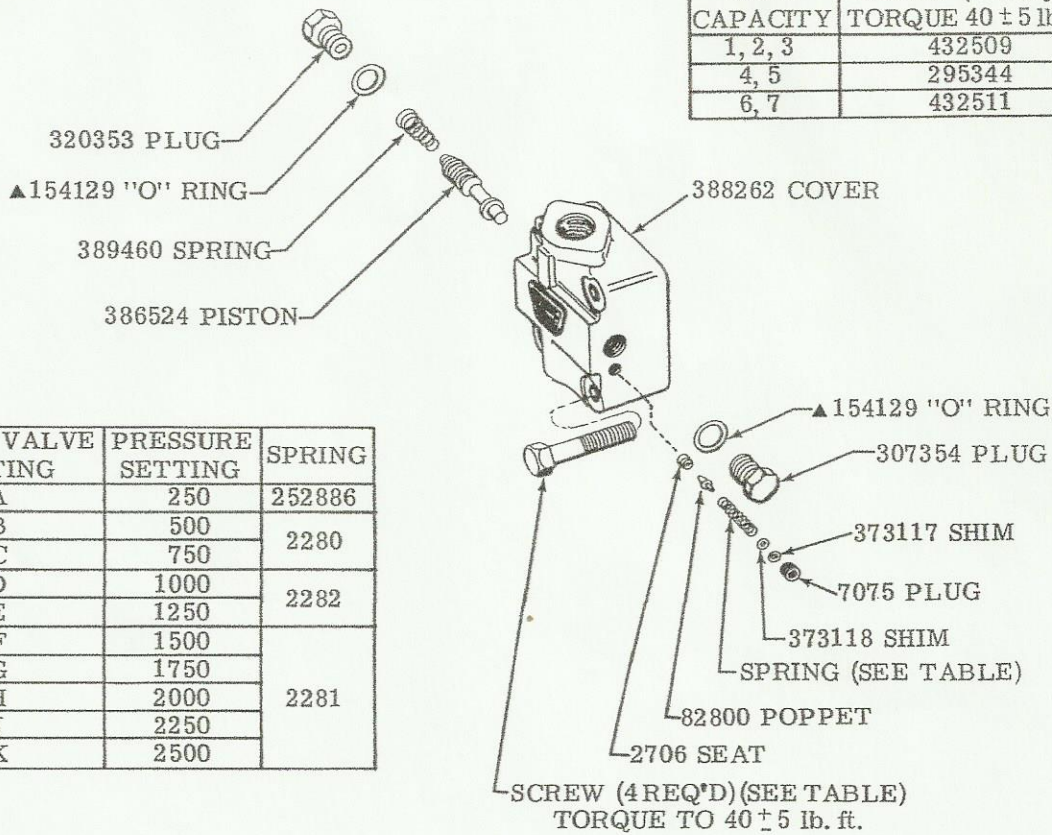

RELIEF VALVE SETTING	PRESSURE SETTING	SPRING
A	250	252886
B	500	2280
C	750	
D	1000	2282
E	1250	
F	1500	2281
G	1750	
H	2000	
J	2250	
K	2500	

AV10F-\*\*\*(P)(T)-\*\*\*11(L)

COVER	OUTLET PORT CONNECTIONS
379543	P
372851	T

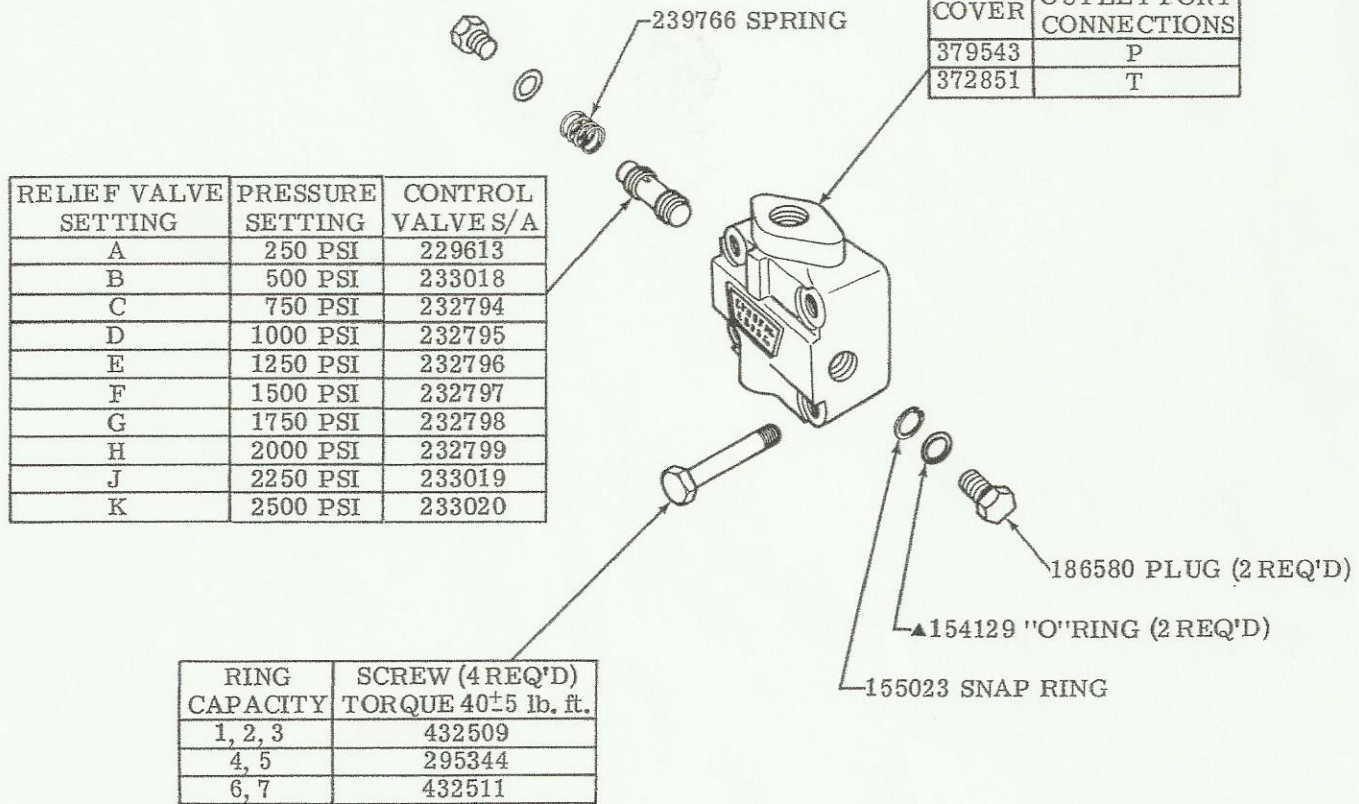

RELIEF VALVE SETTING	PRESSURE SETTING	CONTROL VALVES/A
A	250 PSI	229613
B	500 PSI	233018
C	750 PSI	232794
D	1000 PSI	232795
E	1250 PSI	232796
F	1500 PSI	232797
G	1750 PSI	232798
H	2000 PSI	232799
J	2250 PSI	233019
K	2500 PSI	233020

RING CAPACITY	SCREW (4 REQ'D) TORQUE 40 ± 5 lb. ft.
1, 2, 3	432509
4, 5	295344
6, 7	432511

RING CAPACITY USGPM	ROTOR	VANE KIT (12 VANES)	RING	PIN	CART. KIT
	INCLUDED IN CART. KIT				
3	317681	923499	317676	231042	923496
4	417297	923500	317677	39640	923928
5			317678		
6	417212	923501	355641	16662	923912
7			331813		

STD COVER	OUTLET PORT CONNECTIONS	SCREW
372863	P	1278
372865	S	

INLET PORT CONNECTION	
CODE	BODY (V10)
OMITTED(S)	395643
T	402652

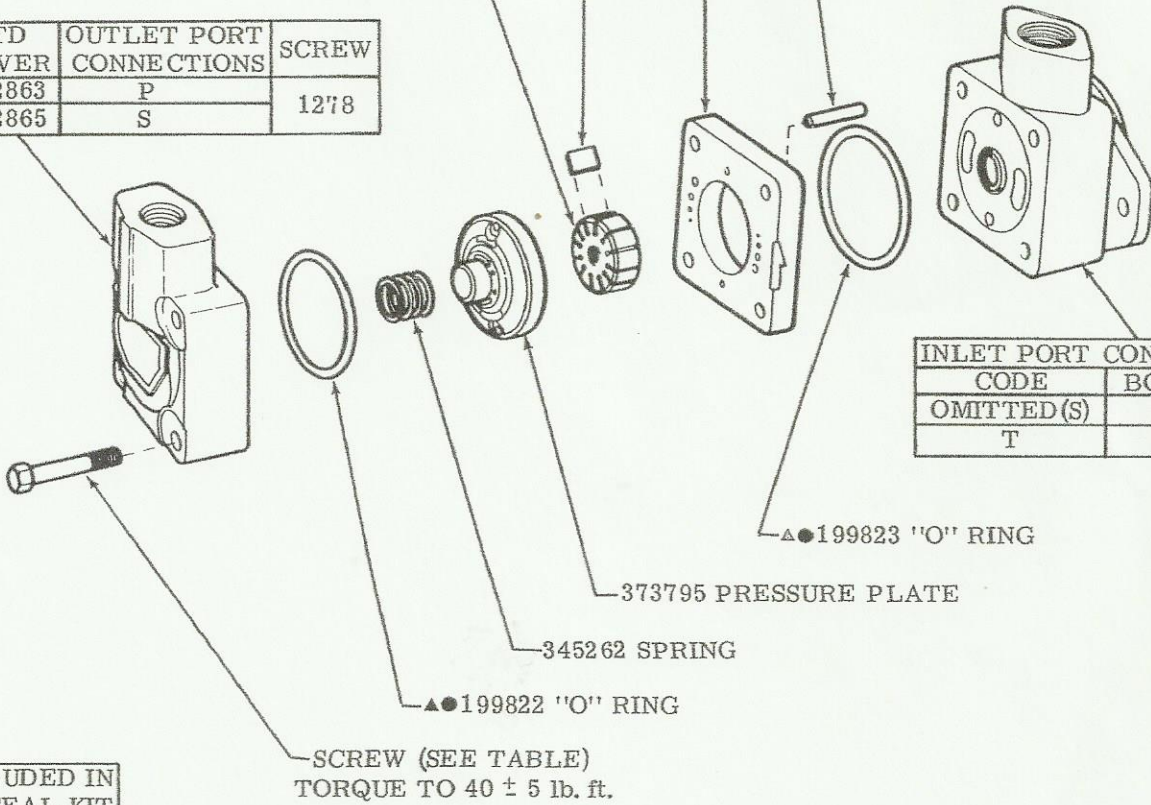

▲ INCLUDED IN  
923548 SEAL KIT

● ALSO INCLUDED  
IN CARTRIDGE KIT

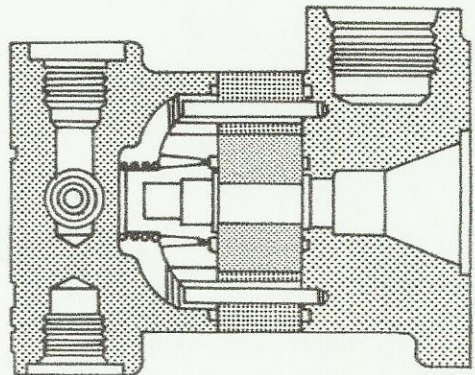

# MODEL CODE BREAKDOWN

TA 1515 \* -1 \*\* - 2525 - \*\* - \*\* - \*\* \*\* \*\* 12 L

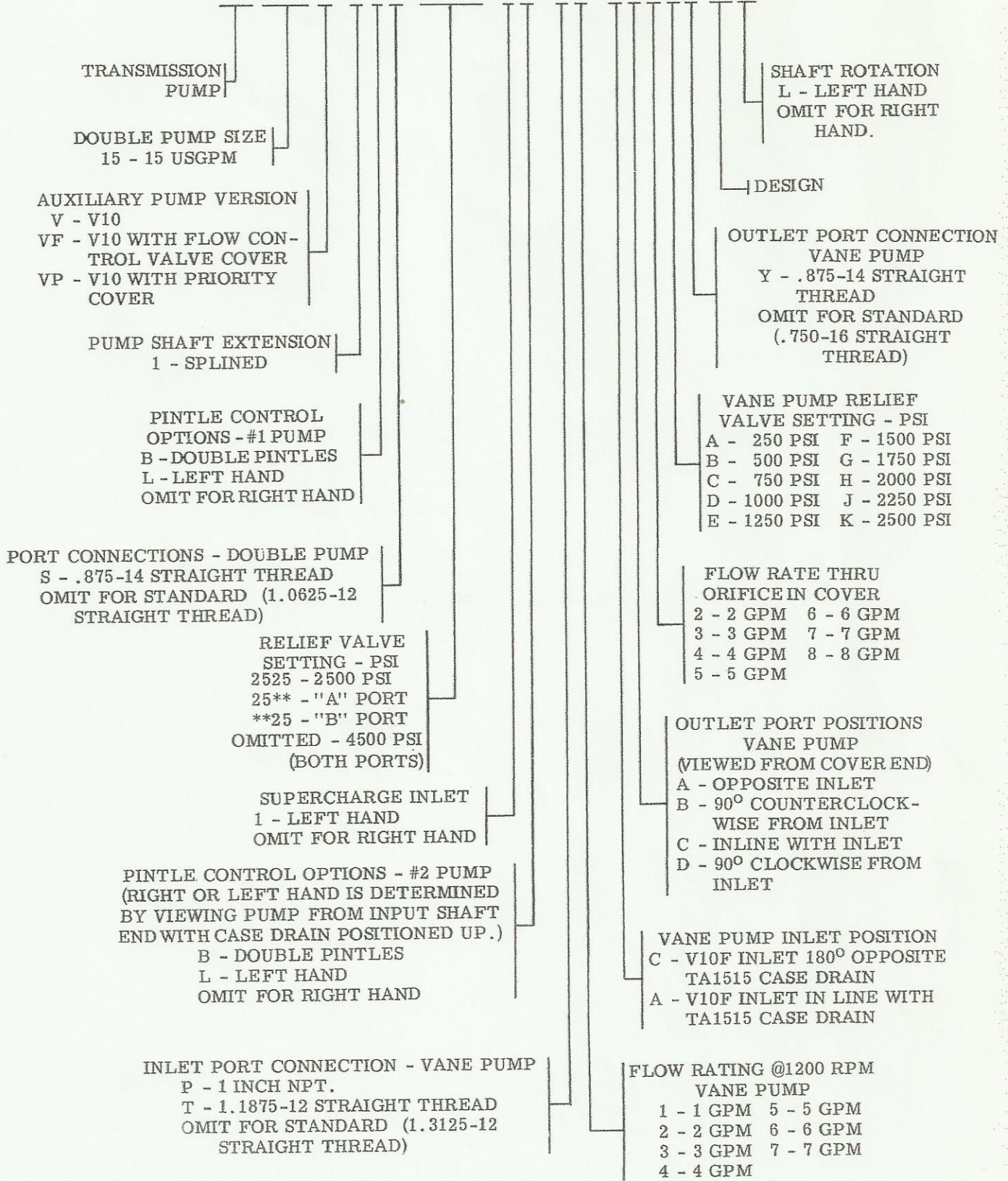

For satisfactory service life of these components, use full flow filtration to provide fluid which meets ISO cleanliness code 16/13 or cleaner. Selections from Vickers OFF, OFR, and OFRS series are recommended.