

Service Parts Information

PRESSURE CONTROL VALVES

R(C)S-10/12-*P*-30
R(C)T-10/12-*P*-30

◆ FOR REFERENCE ONLY
NOT AVAILABLE FOR SALE

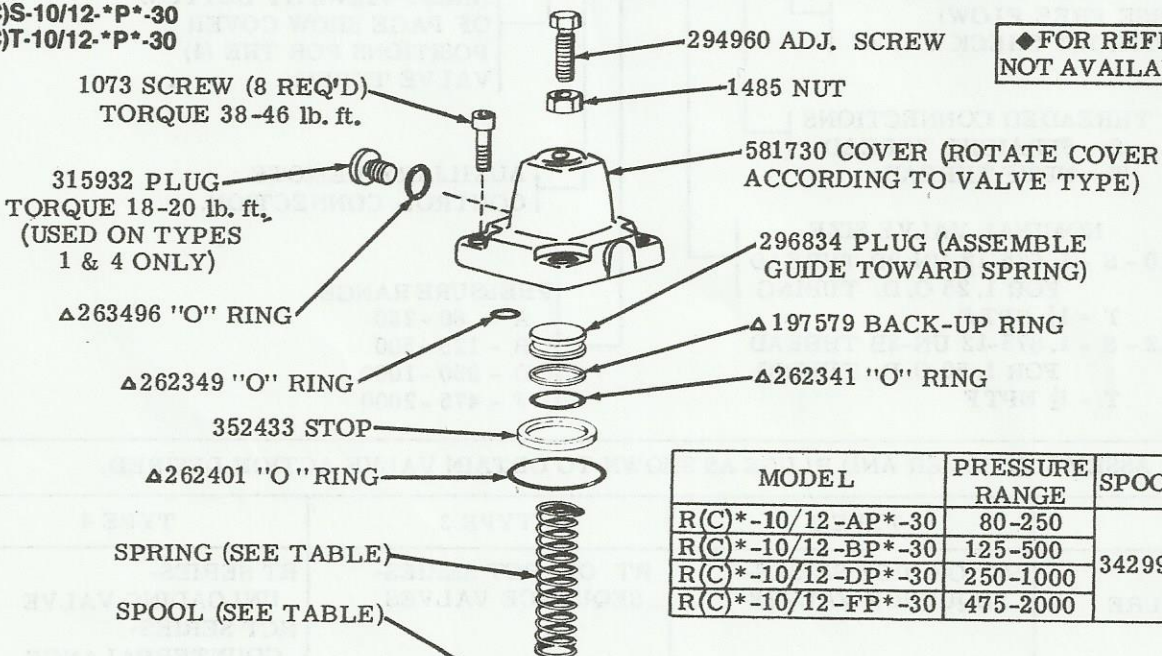

| MODEL | PRESSURE RANGE | SPOOL | SPRING |
|--------------------|----------------|--------|--------|
| R(C)*-10/12-AP*-30 | 80-250 | 342995 | 343748 |
| R(C)*-10/12-BP*-30 | 125-500 | | 343746 |
| R(C)*-10/12-DP*-30 | 250-1000 | | 343747 |
| R(C)*-10/12-FP*-30 | 475-2000 | | |

| BODY S/A | MODEL |
|----------|---------------|
| ◆590354 | RCS-10-*P*-30 |
| ◆590368 | RS-10-*P*-30 |
| ◆590356 | RCS-12-*P*-30 |
| ◆590369 | RS-12-*P*-30 |
| ◆590359 | RCT-10-*P*-30 |
| ◆590371 | RT-10-*P*-30 |
| ◆590362 | RCT-12-*P*-30 |
| ◆590372 | RT-12-*P*-30 |

NOTE: ADDITIONAL SEALING PLUGS SHOWN ON BACK PAGE

| PRESSURE RANGE | COVER | PLUNGER |
|----------------|--------|---------|
| A, B, & D | 583182 | 343002 |
| F | 583185 | 343003 |

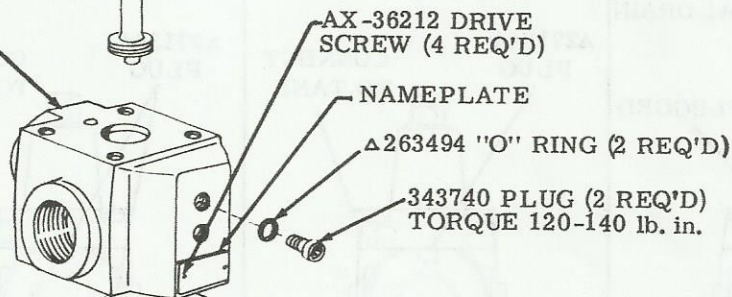

COVER (SEE TABLE)

315932 PLUG
TORQUE 18-20 lb. ft.
(USED ON TYPES 1 & 2 ONLY)

Δ263496 'O' RING

Δ INCLUDED IN F3
SEAL KIT 919618

Δ263495 'O' RING

363889 PLUG
TORQUE 150-160 lb. in.

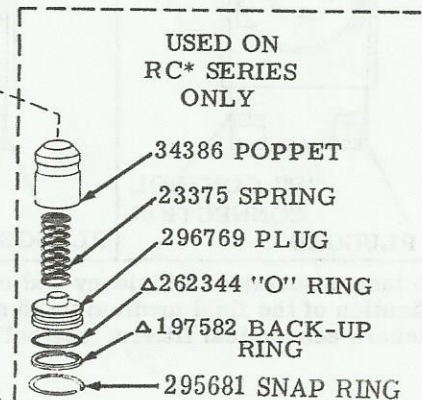

SPERRY VICKERS, TROY, MI 48084

VICKERS, INCORPORATED, IS A SUBSIDIARY OF SPERRY CORPORATION
SPERRY VICKERS IS A REGISTERED TRADEMARK OF SPERRY CORPORATION

MODEL CODE BREAKDOWN

F3-R(C)T-**-**P*-3*

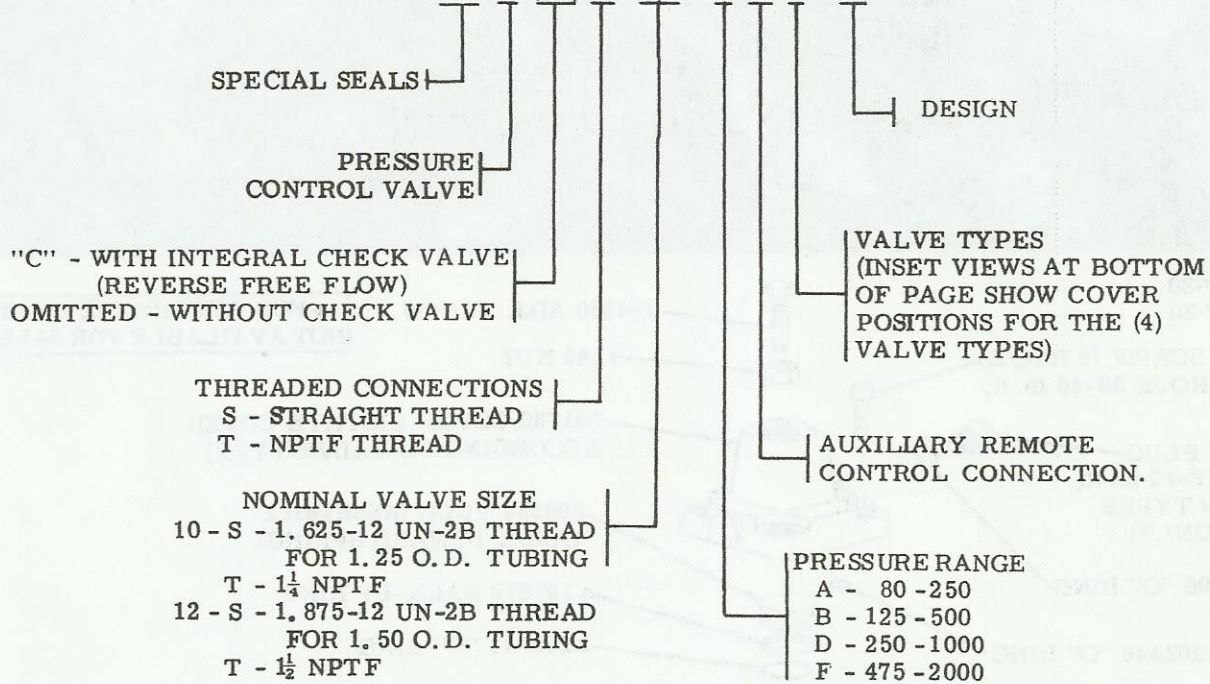

NOTE: ASSEMBLE COVER AND PLUGS AS SHOWN TO OBTAIN VALVE ACTION DESIRED.

| TYPE 1 | TYPE 2 | TYPE 3 | TYPE 4 |
|--|--|---|---|
| RT SERIES-BACK PRESSURE VALVE RCT SERIES-COUNTERBALANCE VALVE DIRECTLY CONTROLLED INTERNAL DRAIN | RT OR RCT SERIES-SEQUENCE VALVES DIRECTLY CONTROLLED EXTERNAL DRAIN | RT OR RCT SERIES-SEQUENCE VALVES REMOTELY CONTROLLED EXTERNAL DRAIN | RT SERIES-UNLOADING VALVE RCT SERIES-COUNTERBALANCE VALVE REMOTELY CONTROLLED INTERNAL DRAIN |
| <p>PLUGGED</p> <p>"P" CONTROL CONNECTION PLUGGED</p> | <p>Δ271344 PLUG</p> <p>CONNECT TO TANK</p> <p>"P" CONTROL CONNECTION PLUGGED</p> | <p>Δ271344 PLUG</p> <p>CONNECT TO TANK</p> <p>"P" CONTROL CONNECTION PLUGGED</p> <p>REMOTE CONTROL CONNECTION</p> | <p>Δ271344 PLUG</p> <p>PLUGGED</p> <p>"P" CONTROL CONNECTION PLUGGED</p> <p>REMOTE CONTROL CONNECTION</p> |

To insure sustained efficiency and maximum trouble-free life of this precision equipment, initial and continuous filtration of the fluid medium to 25 microns absolute or less is essential. (For information pertaining to Sperry Vickers economical filters, see bulletin 81-216.)

Litho in U. S. A.