

VICKERS[®]

A TRINNOVA COMPANY

Service Parts Information

Heavy
Duty
Piston
Pump

PVE35*-E2-21-C**-20

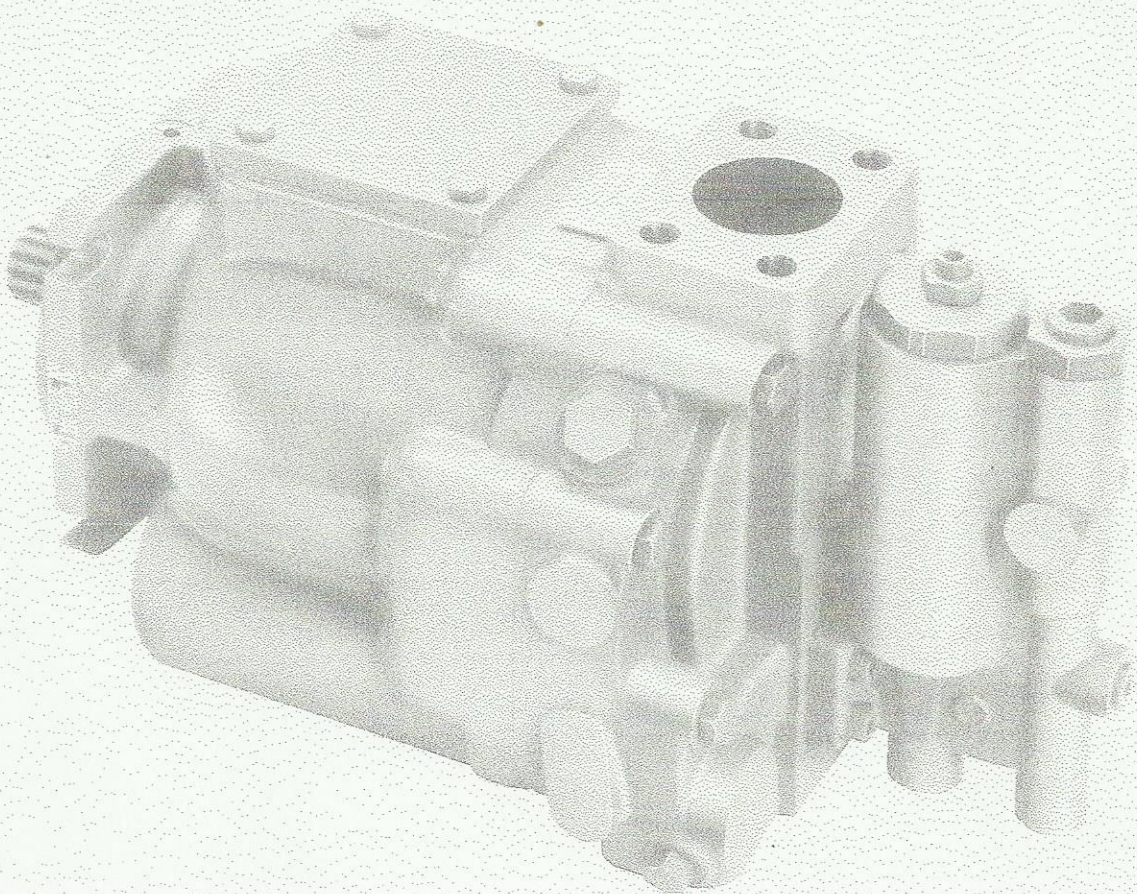

Vickers, Incorporated

P.O. Box 302
Troy, Michigan 48007-0302

RELEASED 4-1-85

M-2243-S

676584 'C' PRESSURE COMPENSATOR S/A PRESET AT 250 bar.

676580 'CVP' LOAD SENSING PRESSURE LIMITER CO SATOR S/A. SHIPPED AT APPROXIMATELY: SENSING DIFFERENTIAL SURE 20 bar. PRESSUR ITER 250 bar.

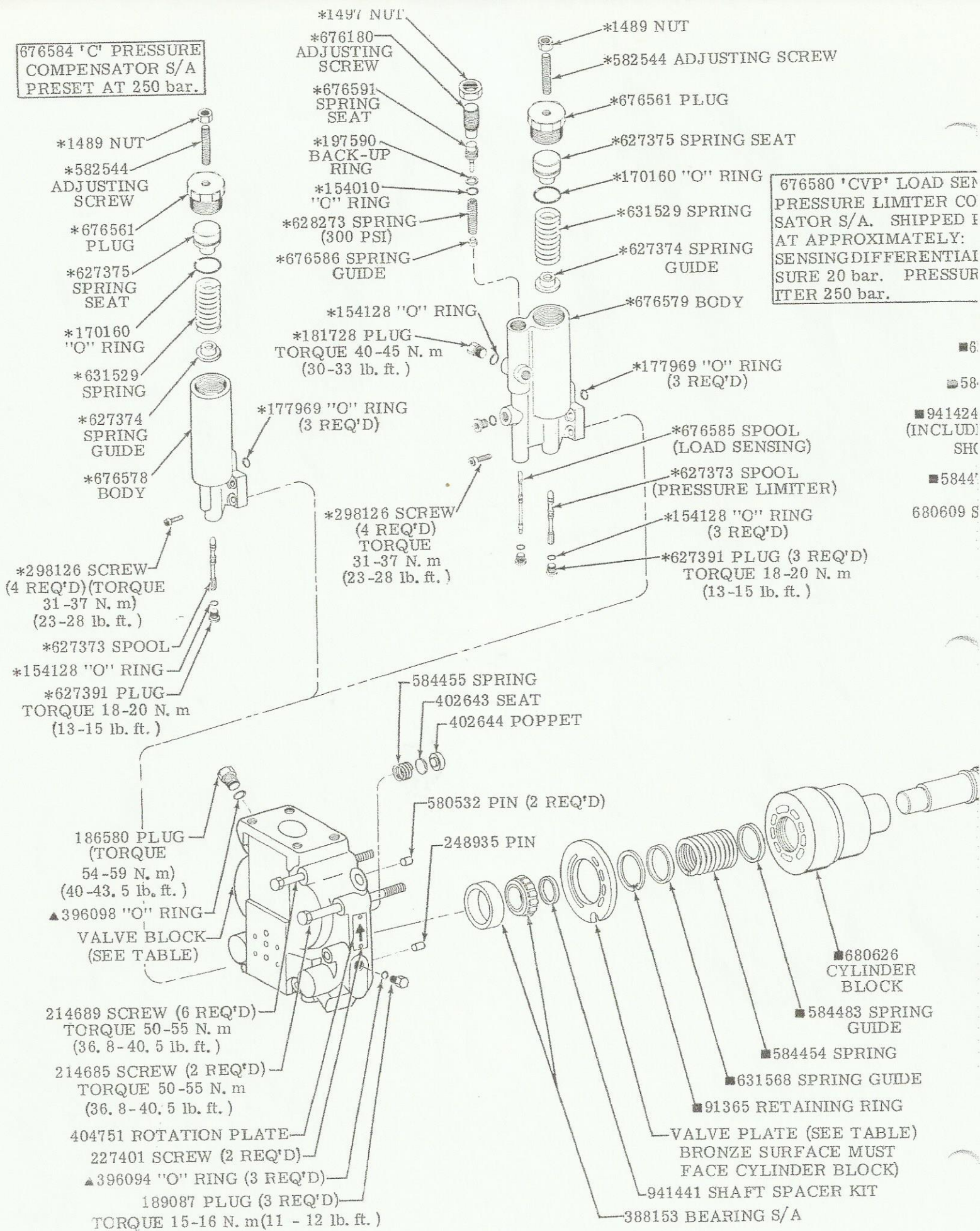

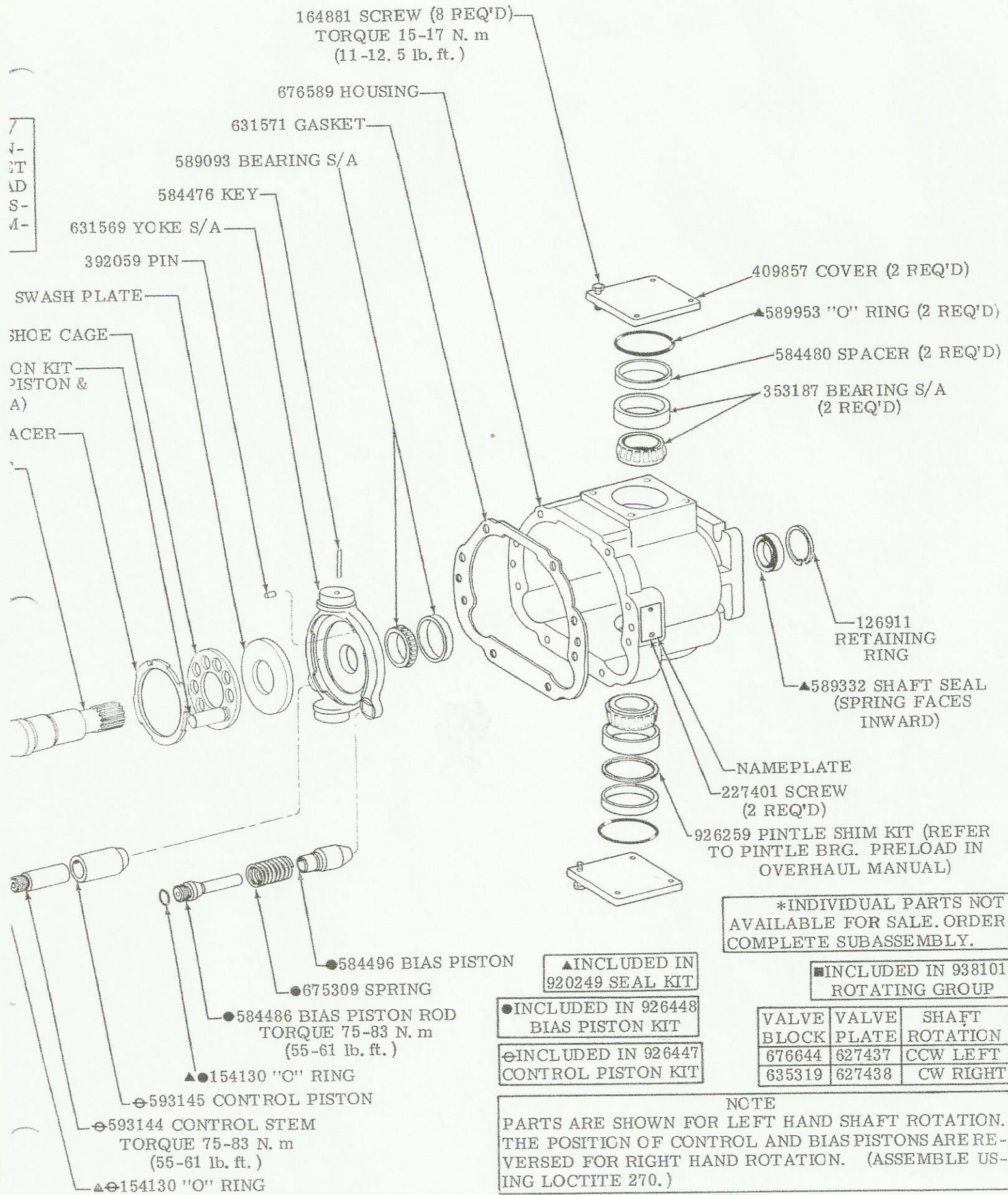

MODEL CODE BREAKDOWN

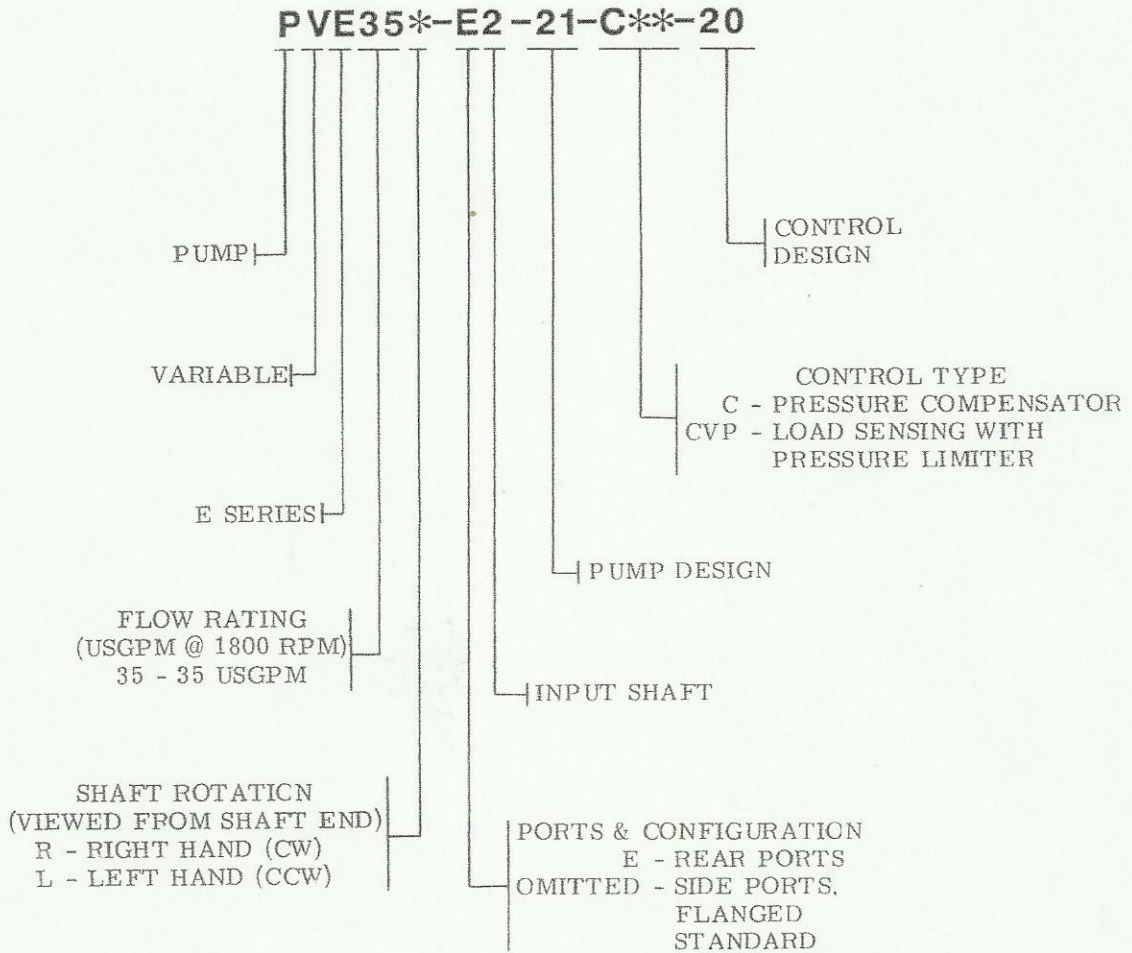

To insure sustained efficiency and maximum trouble free life of this precision equipment, initial and continuous full flow filtration of the inlet fluid medium is essential. Inlet fluid should meet ISO cleanliness code 19/15. Select and apply filters from the Vickers OFP, CFR, and OFRS series, which are available in 3, 10, and 25 micrometre filtration ratings.