

VICKERS

5 AND 6 GPM VARIABLE
IN-LINE PISTON UNITS

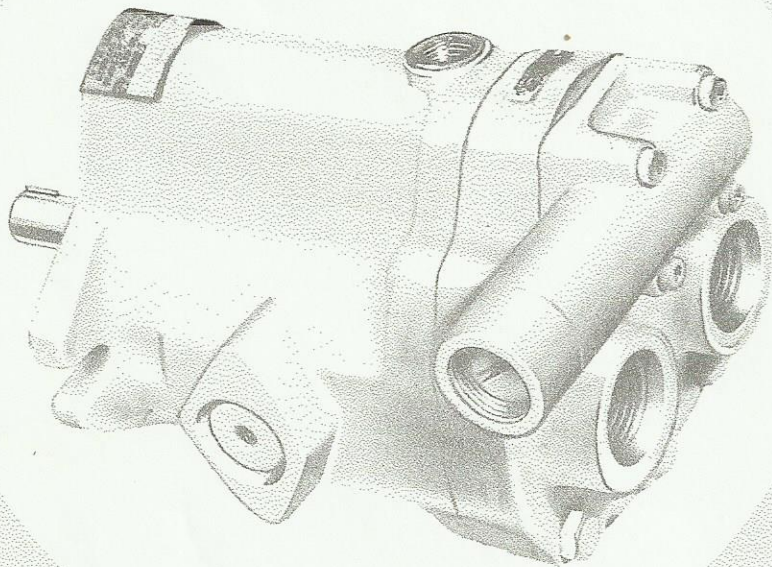

SERVICE
PARTS
INFORMATION



Models: PVB5 11 Design
 MVB5 11 Design
 PVB6 11 Design

VICKERS INCORPORATED

DIVISION OF SPERRY RAND CORPORATION

Machinery Hydraulics Division

Service Department

14420 Linwood Avenue

•

Detroit, Michigan 48238

ATLANTA • CHICAGO • DETROIT • EL SEGUNDO • HOUSTON • SEATTLE • SPRINGFIELD, N. J. • TORONTO

I-3262-S

5 & 6 GPM VARIABLE DELIVERY IN-LINE PISTON UNITS -11 DESIGN

PVB5 PUMP
MVB5 MOTOR
PVB6 PUMP

MODEL	VALVE PLATE S/A INCLUDES 39465 BEARING
PVB*-RSY-11-C-10	938552
PVB*-LSY-11-C-10	938553
PVB5-RDY-11-H/M-10	938554
PVB5-LDY-11-H/M-10	938555
MVB5-UDY-11-H/M-10	938550

MODEL	YOKE	HOUSING
*VB5-*DY-11	237192	274736
PVB*-*SY-11	231557	274672

MODEL	SPACER
PVB*-*SY-**-C	—
PVB*-*SY-**-C9	269805
PVB*-*SY-**-C8	267441
PVB*-*SY-**-C7	269804
PVB*-*SY-**-C6	263005
PVB*-*SY-**-C5	269803
PVB*-*SY-**-C4	267442

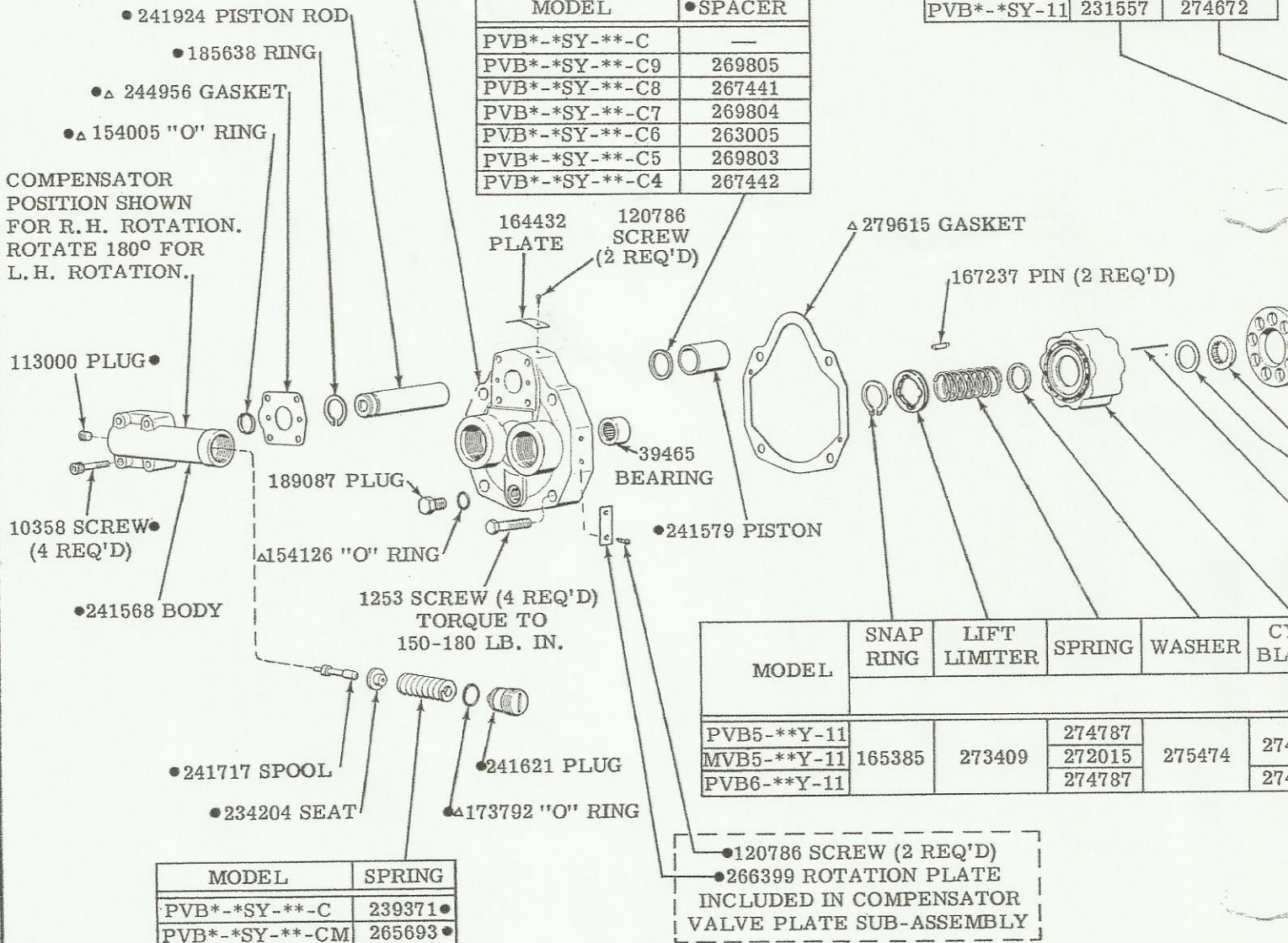

MODEL	SPRING
PVB*-*SY-**-C	239371●
PVB*-*SY-**-CM	265693●

MODEL	SNAP RING	LIFT LIMITER	SPRING	WASHER	CY BL
PVB5-**-Y-11			274787		274
MVB5-**-Y-11	165385	273409	272015	275474	274
PVB6-**-Y-11			274787		274

●120786 SCREW (2 REQ'D)
●266399 ROTATION PLATE
INCLUDED IN COMPENSATOR
VALVE PLATE SUB-ASSEMBLY

SCREW 2 REQ'D)	COVER	MODEL
12278	246462	MVB5-UDY PVB5-*DY

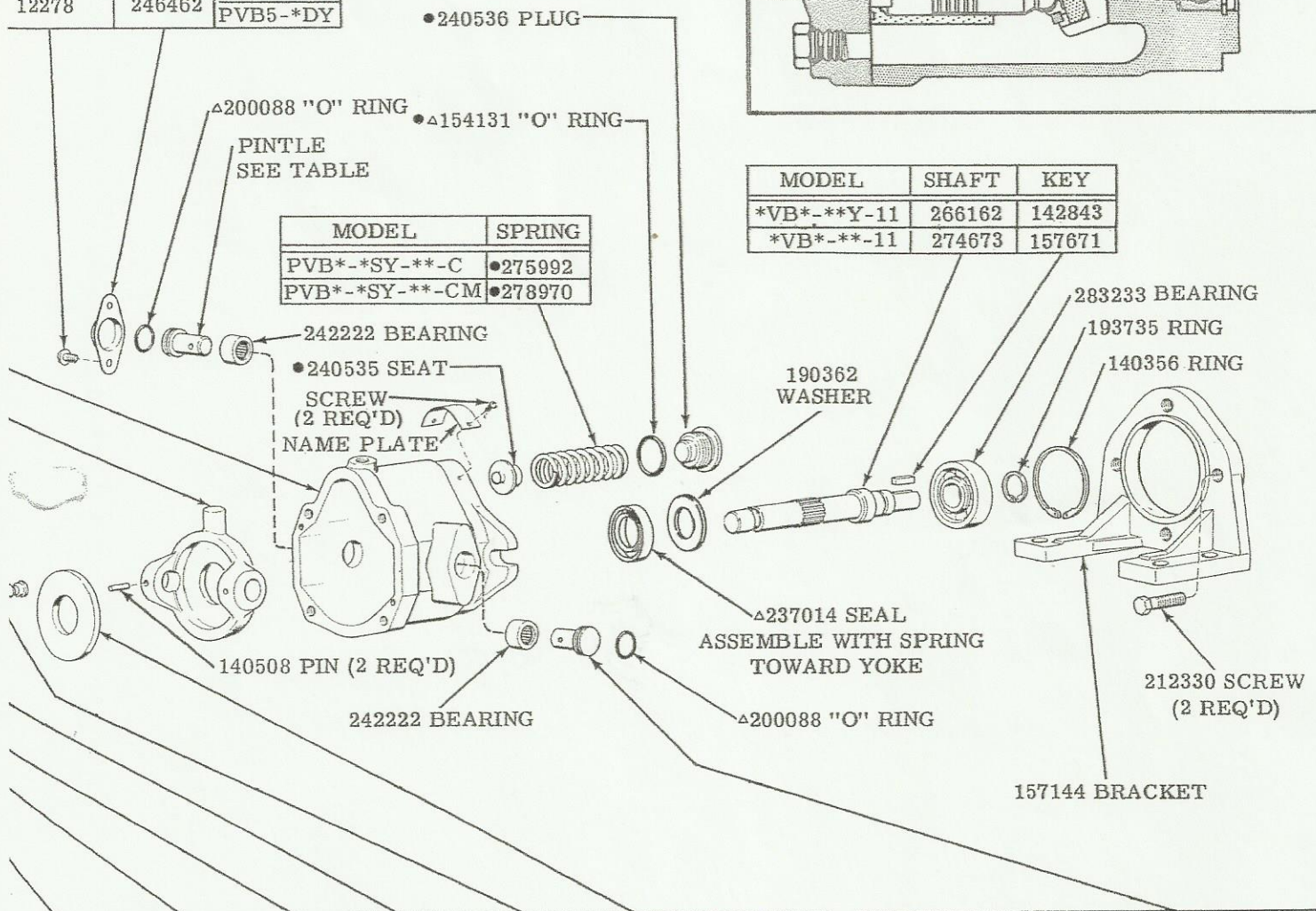
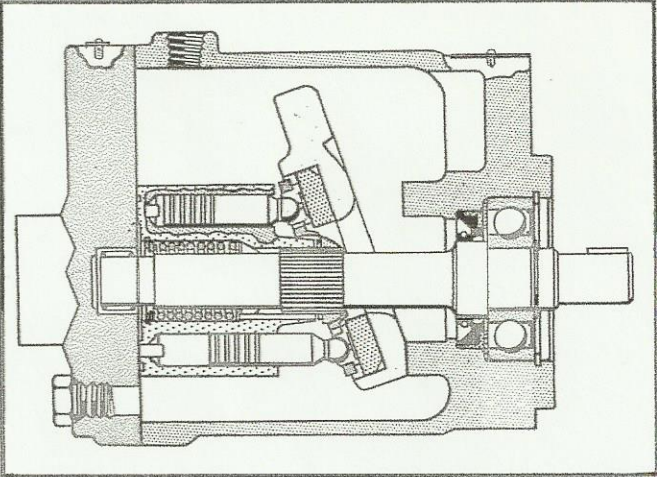

MODEL	SHAFT	KEY
VB-*Y-11	266162	142843
VB-*--11	274673	157671

PIN (3 REQ'D)	WASHER	WASHER	PLATE	PISTON S/A (9 REQ'D)	PLATE	ROTATING GROUP KIT
ESE PARTS INCLUDED IN						
248203	274956	275485	274249	234924	234500	938262
				259034		938263
						938264

MODEL	PINTLE	CONTROL PINTLE
VB-*DY-11-H	237191 (2 REQ'D)	—
VB-*DY-11-M	236876	237433
PVB*-*SY-11-C*	• 236876 (2 REQ'D)	—

NOTE: COMPENSATOR CONTROL SHOWN. FOR MANUAL CONTROLS SEE PAGE 3.

Δ INCLUDED IN 919191 GASKET KIT

• USED WITH COMPENSATOR CONTROL ONLY

MODEL CODE

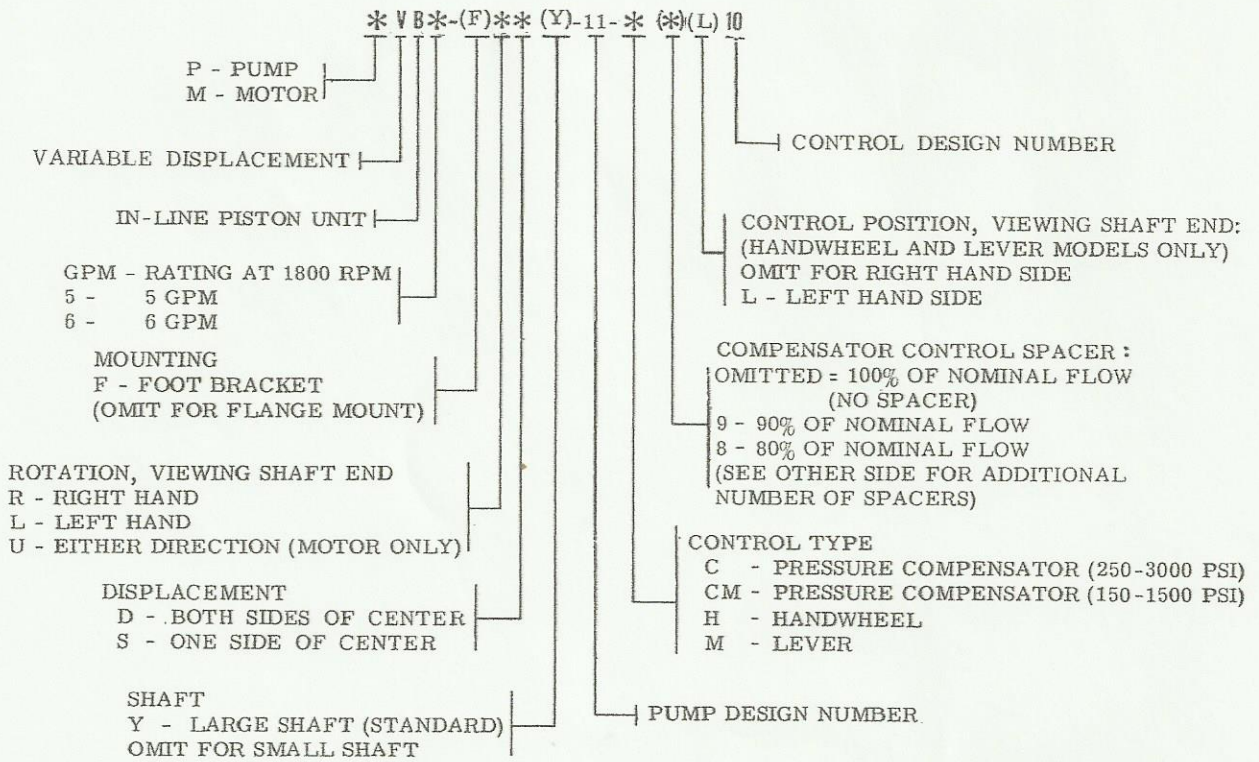

MANUAL LEVER CONTROL
MODEL *VB*--**--11-M-10

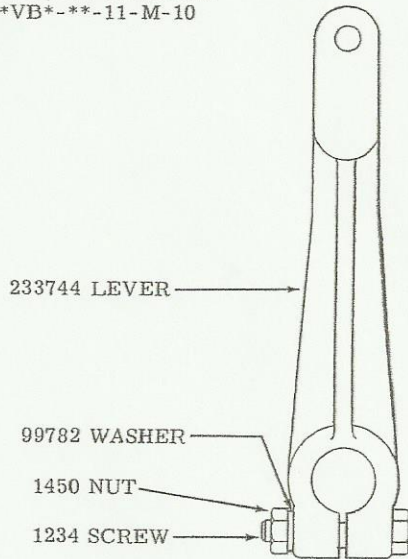

HANDWHEEL CONTROL
MODEL *VB*--**--11-H-10

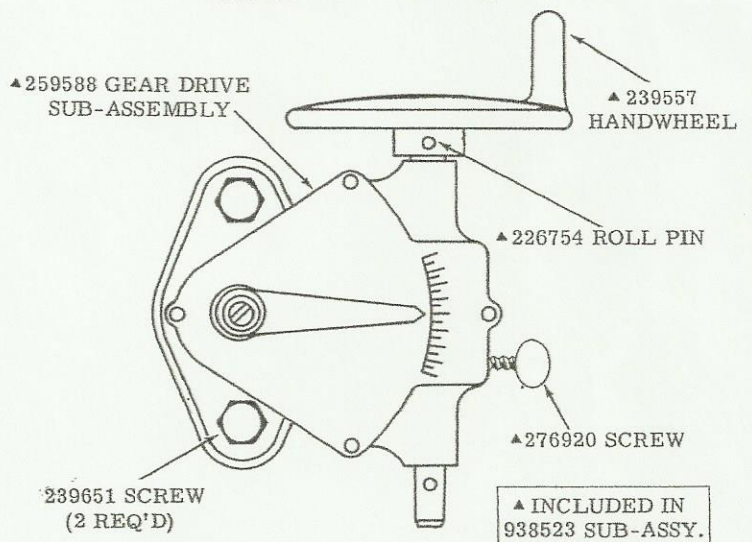

To insure sustained efficiency and maximum trouble-free life of this precision equipment, initial and continuous filtration of the fluid medium to 25 microns or less is essential. (For information pertaining to Vickers economical 10 micron filters, see installation drawing I & M 229847.)