

 SPERRY RAND

20 AND 29 GPM VARIABLE
IN-LINE PISTON PUMPS

VICKERS

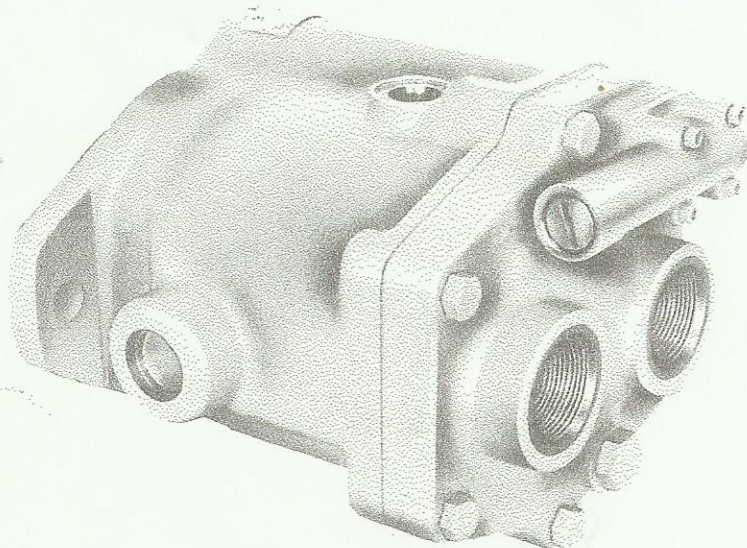

**SERVICE
PARTS
INFORMATION**

PVB20-*S-20-*(*)-(*)-11

PVB29-*S-20-*(*)-(*)-11

INDUSTRIAL DIVISION
TROY, MICHIGAN 48064

● INCLUDED IN PRESSURE COMPENSATOR SUBASSYS SHOWN IN TABLE.

PRESSURE RANGE (PSI)	COMPEN-SATOR SUBASSY	SPRING
(C) 250-2500 (20)	942158	239371●
250-2000 (29)		
(CM) 250-1500	942159	265693●

- 360430 PLUG
- ▲ 173792 "O" RING
- ▲ 154005 "O" RING
- 234204 SEAT
- 356986 SPOOL
- 354858 BODY
- 10358 SCREW (4 REQ'D)
- ▲ 244956 GASKET
- 113000 PLUG

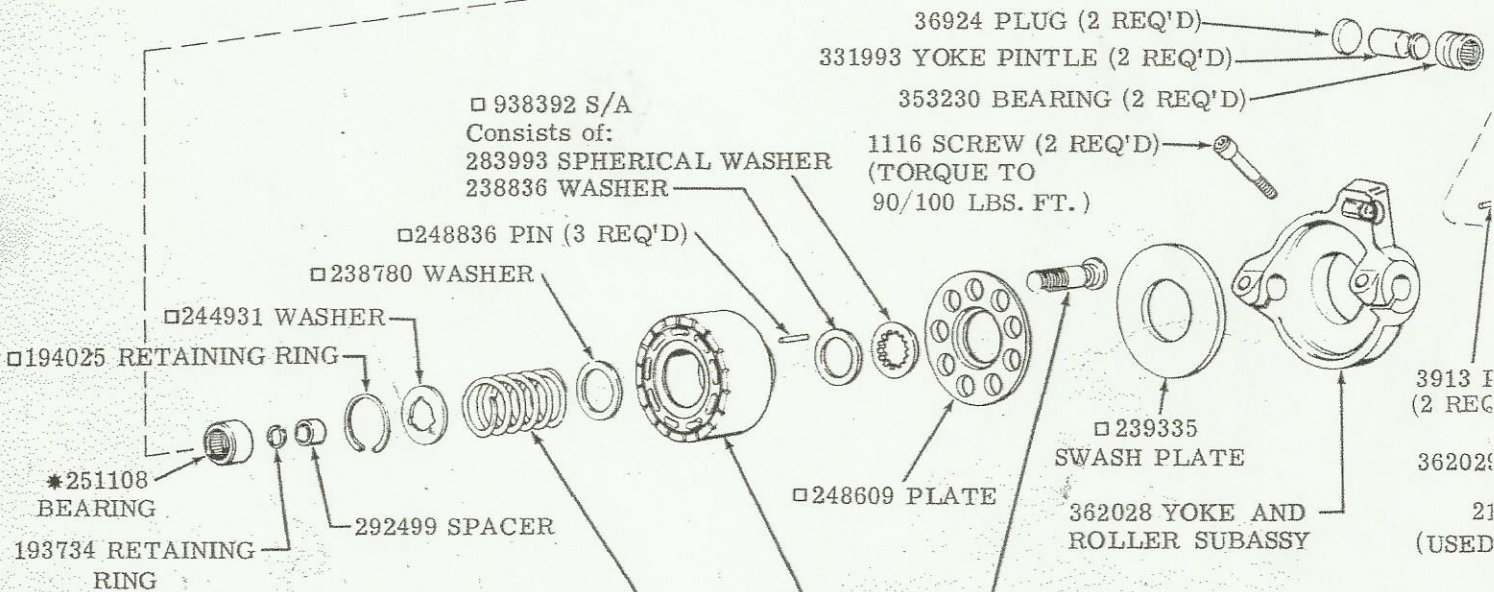
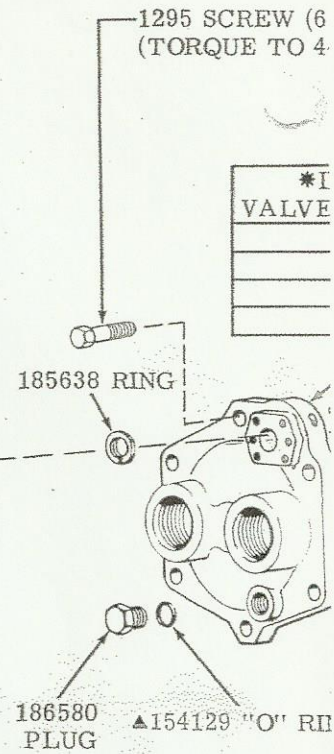

MODEL	□ SPRING	□ CYLINDER BLOCK	□ PISTON SUBASSY KIT	□ ROTATING GROUP
PVB20-(F)*S-20-C(M)-(*)-11	246386	250688	941883	938274
PVB29-(F)*S-20-C(M)-(*)-11	263582	259458	941888	938275

▲ INCLUDED IN 919683 GASKET KIT

□ INCLUDED IN ROTATING GROUP

D)
LBS. FT.

MODEL	INCLUDED IN VALVE SUBASSY
PVB20-(F)RS-20-C(M)-(*)-11	169
PVB20-(F)LS-20-C(M)-(*)-11	170
PVB29-(F)RS-20-C(M)-(*)-11	171
PVB29-(F)LS-20-C(M)-(*)-11	172

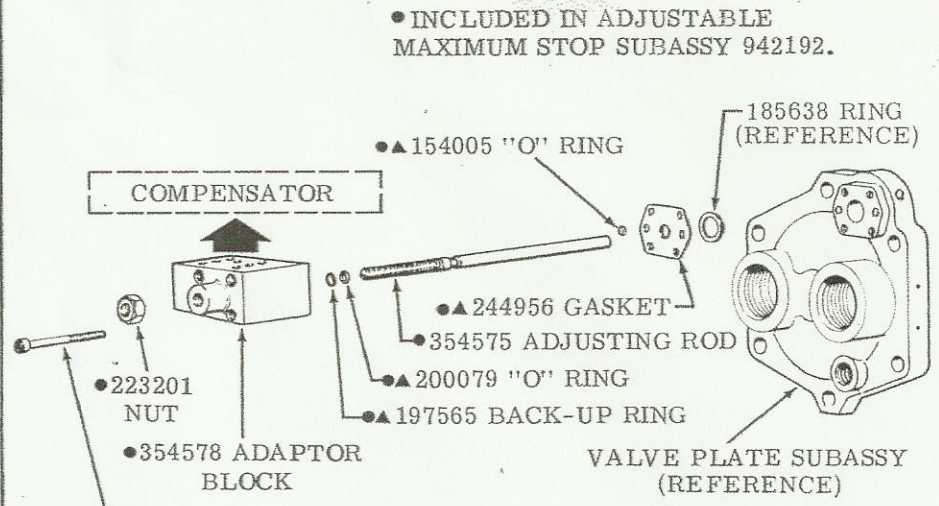
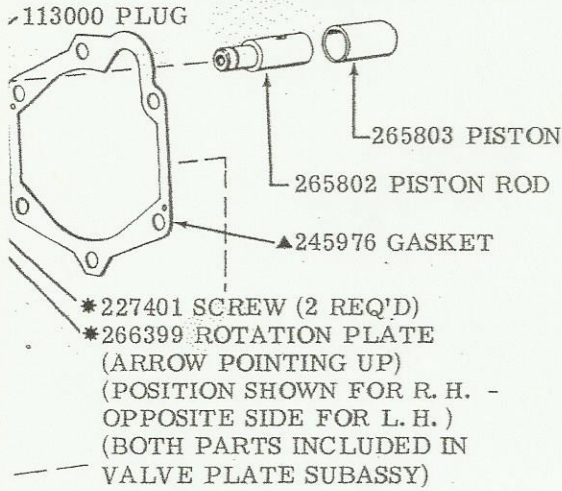

●10932 SCREW (4 REQ'D) (TORQUE TO 45/53 LBS. IN.)

NOTE
The adjustable maximum stop feature (shown) may be used for manual adjustment of pump output flow. To assist initial priming, manual adjustment control setting must be at least 40% of maximum flow position. Maximum flow position occurs when rod is fully extended.

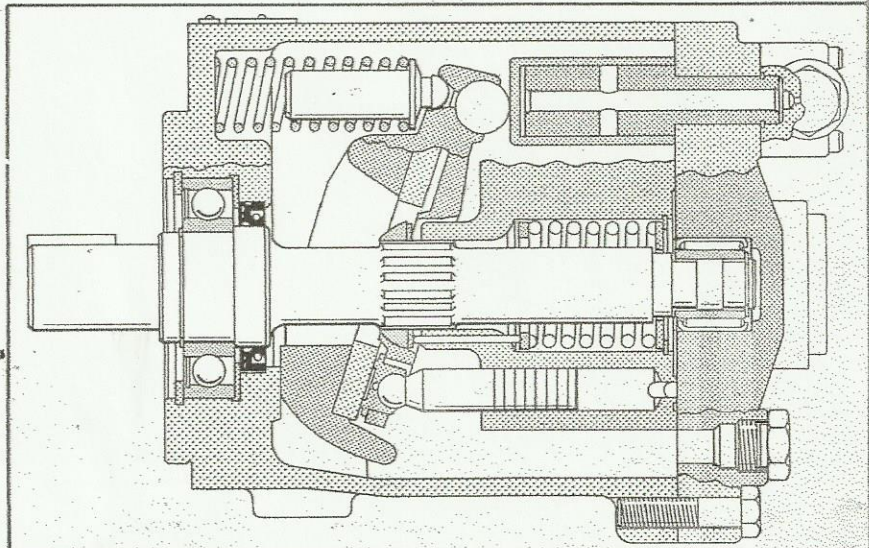
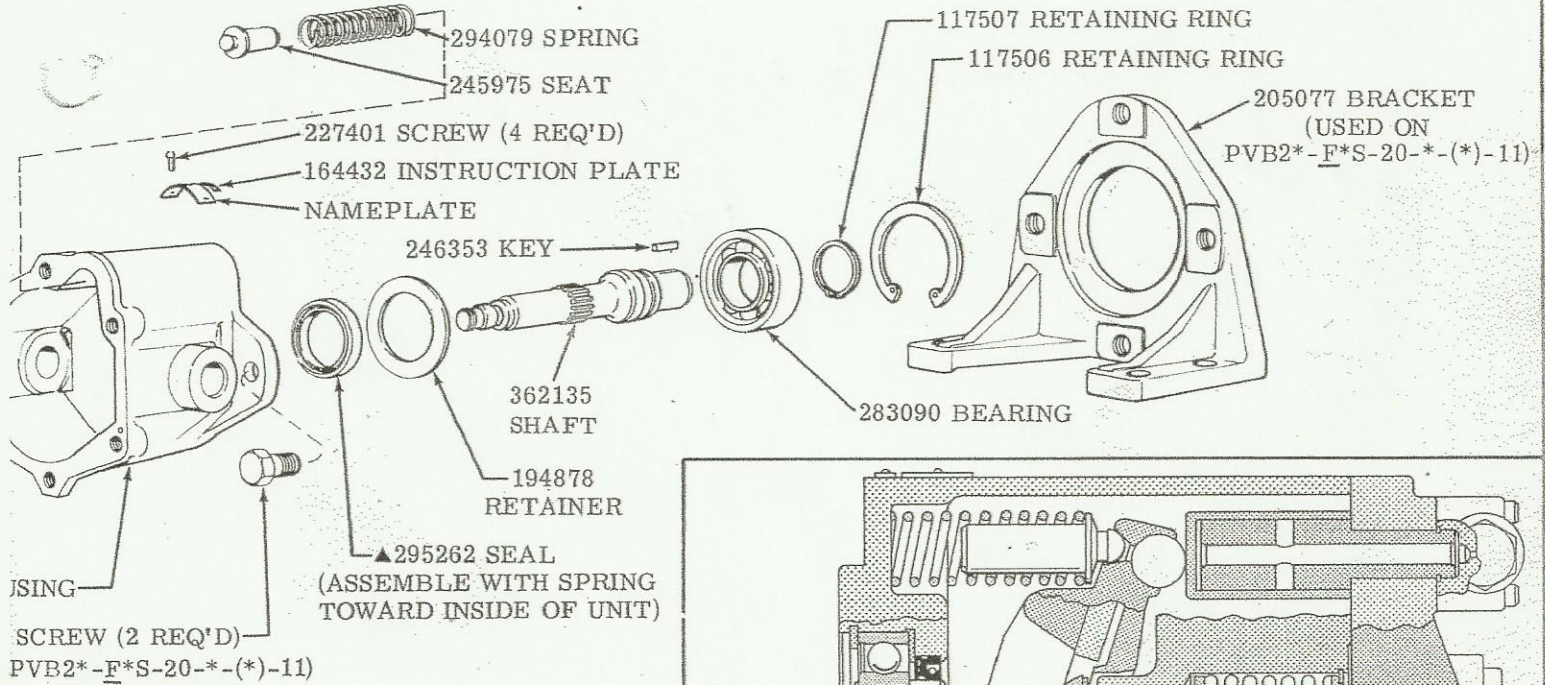

MODEL CODE BREAKDOWN

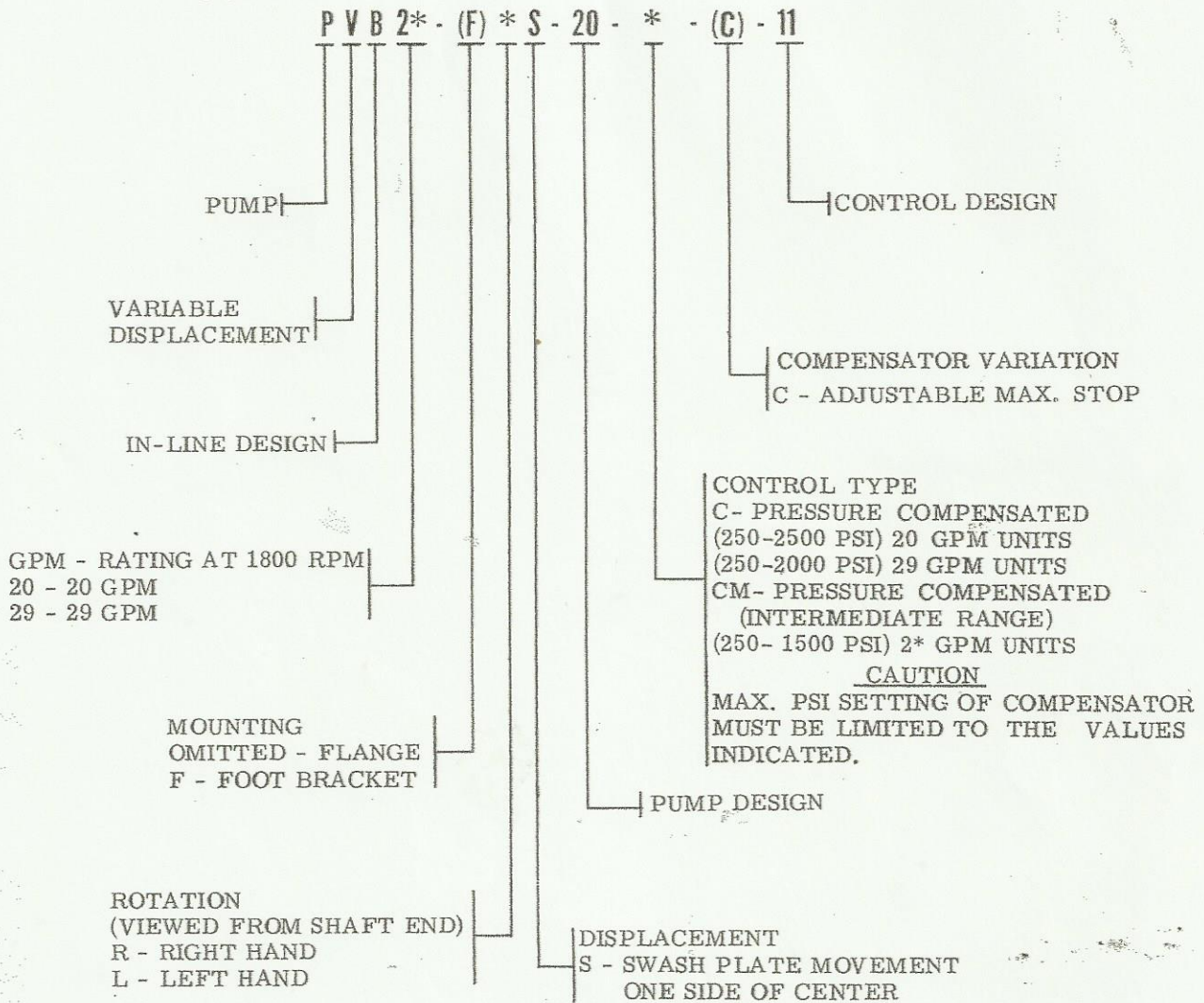

To insure sustained efficiency and maximum trouble-free life of this precision equipment, initial and continuous filtration of the fluid medium to 25 microns or less is essential. (For information pertaining to Vickers economical 10 micron filters, see installation drawing I & M 229847.)