

 SPERRY RAND

VICKERS

**FIXED DELIVERY
PISTON PUMPS**

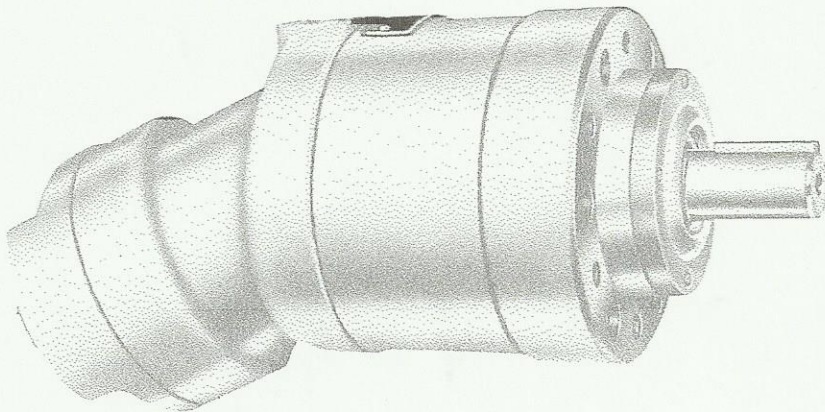

**SERVICE
PARTS
INFORMATION**

**Models: PF1-120-2
PF1-150-2
PF-2032-* -10, 20 and 21 Designs**

INDUSTRIAL DIVISION
TRDY, MICHIGAN 48084

Revised 4-1-69

I-1683-S

FIXED DELIVERY PISTON TYPE PUMPS

PF-2032-*-*-21

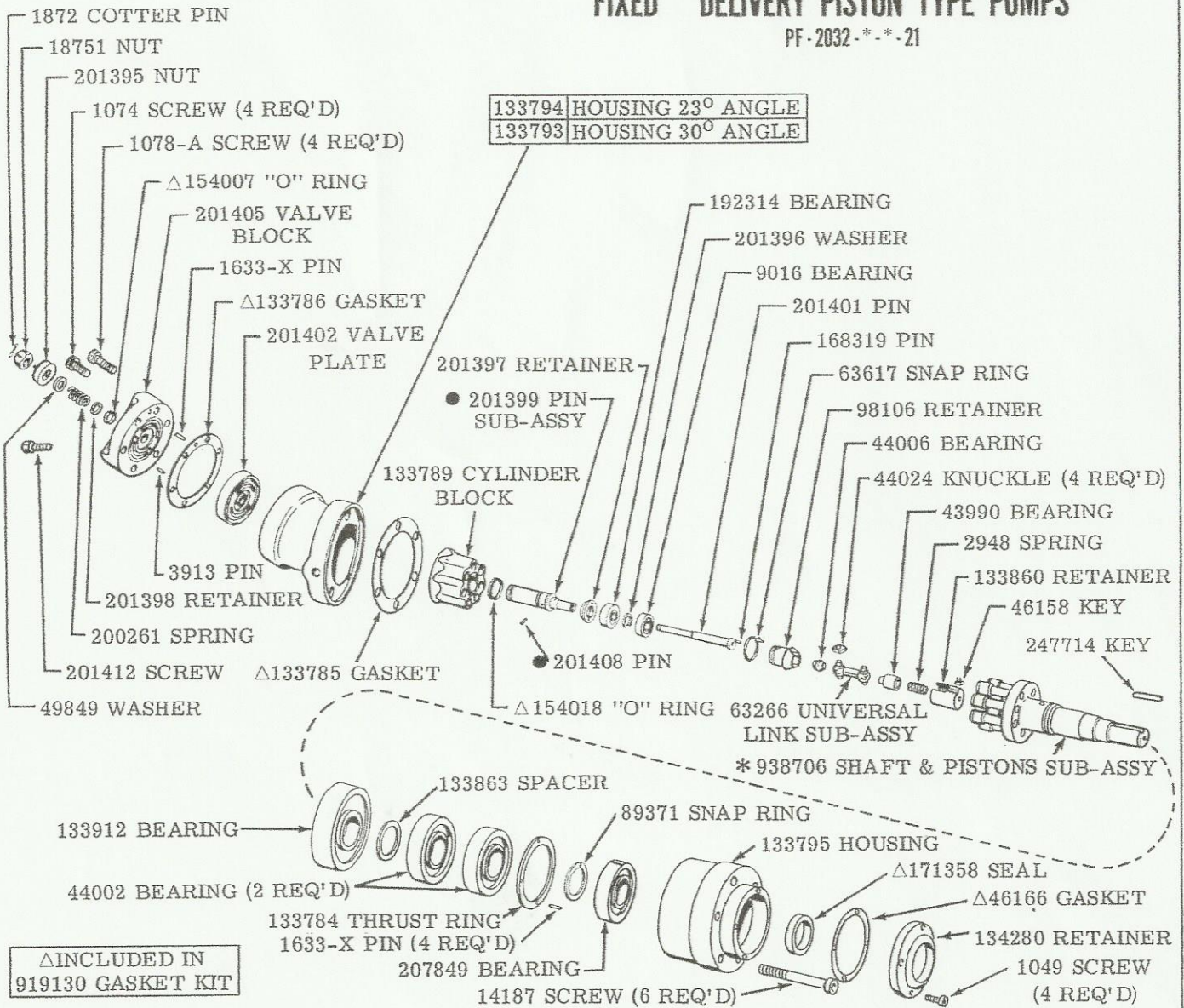

Δ INCLUDED IN 919130 GASKET KIT

To insure proper clearance, tighten 18751 nut so valve block, valve plate and cylinder block are clamped snugly together. Then back the nut off from 90 to 120 degrees to align the slot with the key hole in the pin. See Service Letter I-79.

* 938706 SHAFT & PISTON SUB-ASSY including 89371 SNAPRING, replaces 133890 THREADED SHAFT SUB-ASSY, 6643 LOCKWASHER and 6648 NUT. Current parts are included in ROTATING GROUP 936442.

936442 ROTATING GROUP SUBASSEMBLY

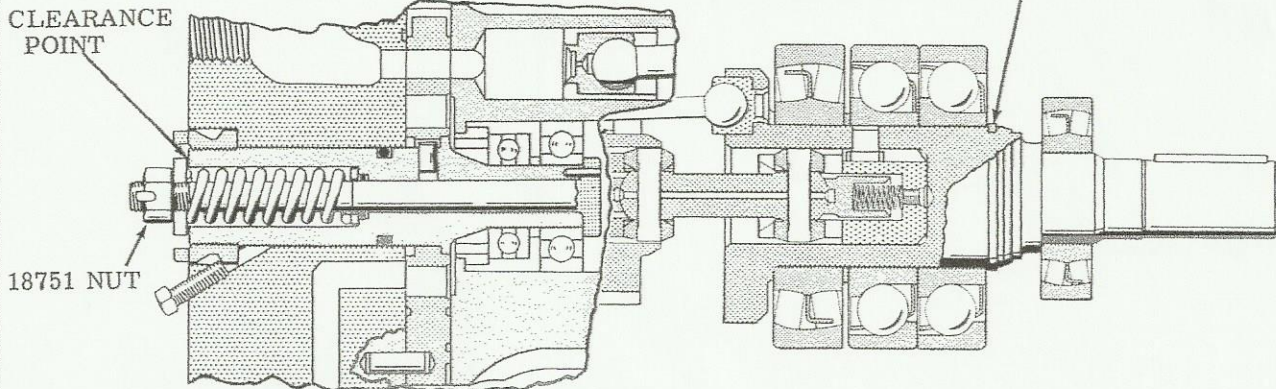

FIXED DELIVERY PISTON TYPE PUMPS

PF-2032-*-*-20

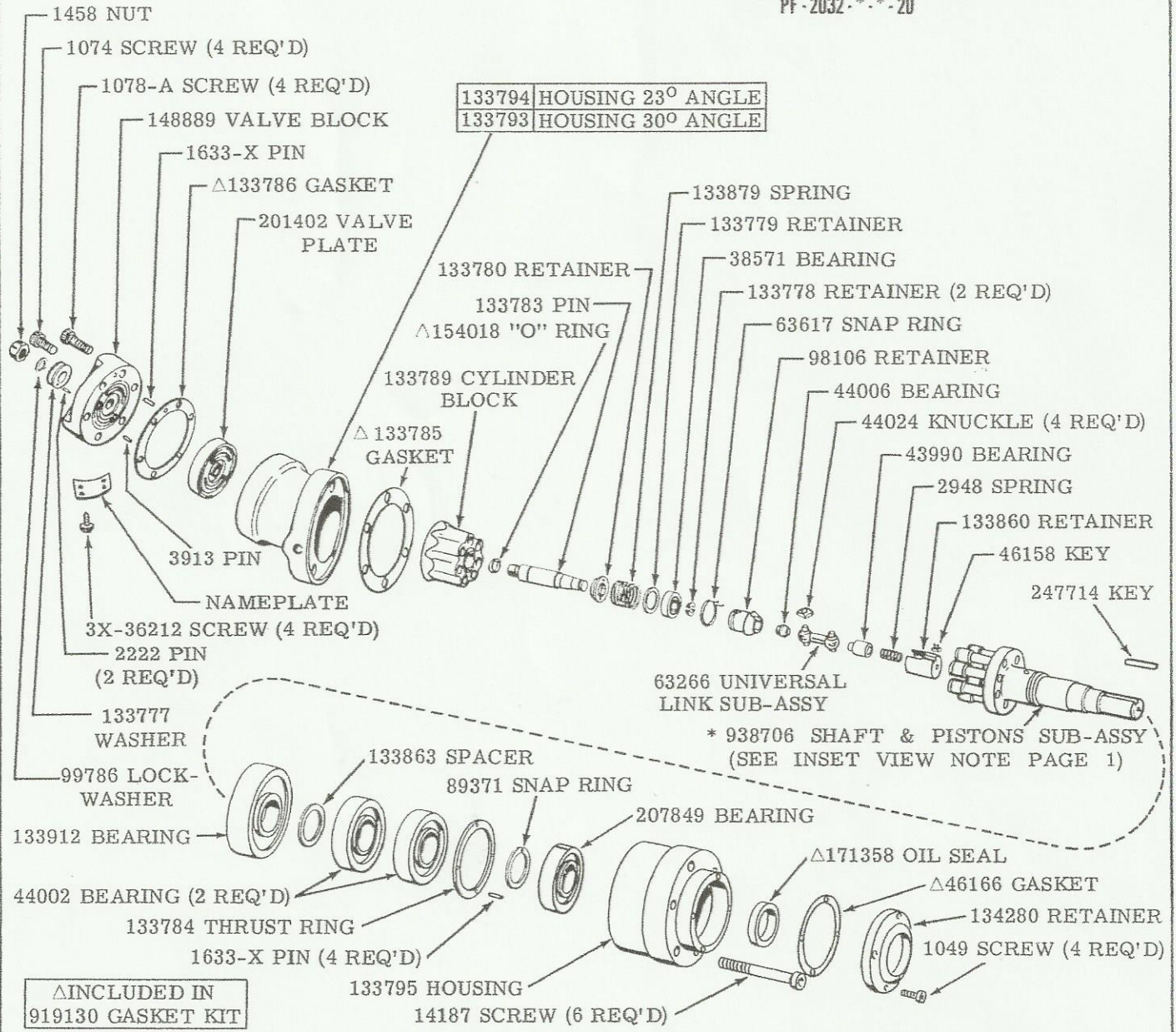

ΔINCLUDED IN 919130 GASKET KIT

925558 ROTATING GROUP SUBASSEMBLY

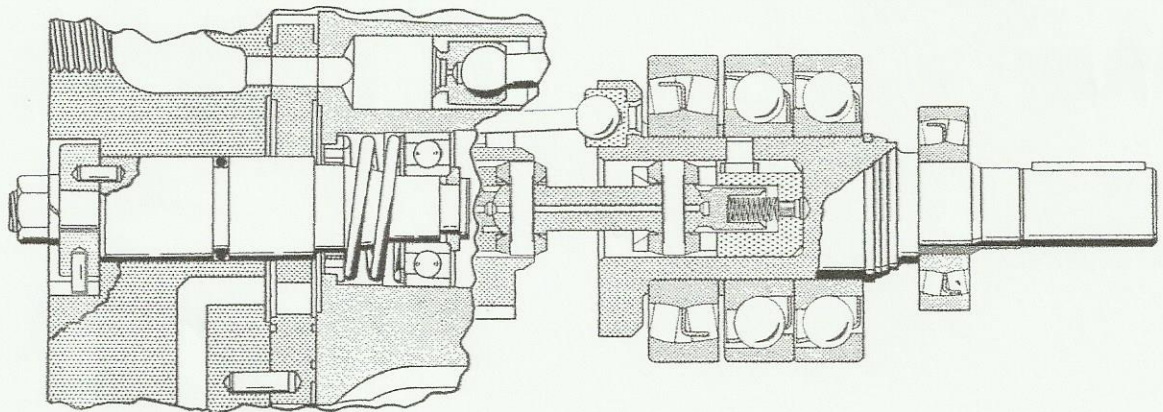

FIXED DELIVERY PISTON TYPE PUMPS

PF-2032-*. *-10
 PF1-120-2
 PF1-150-2

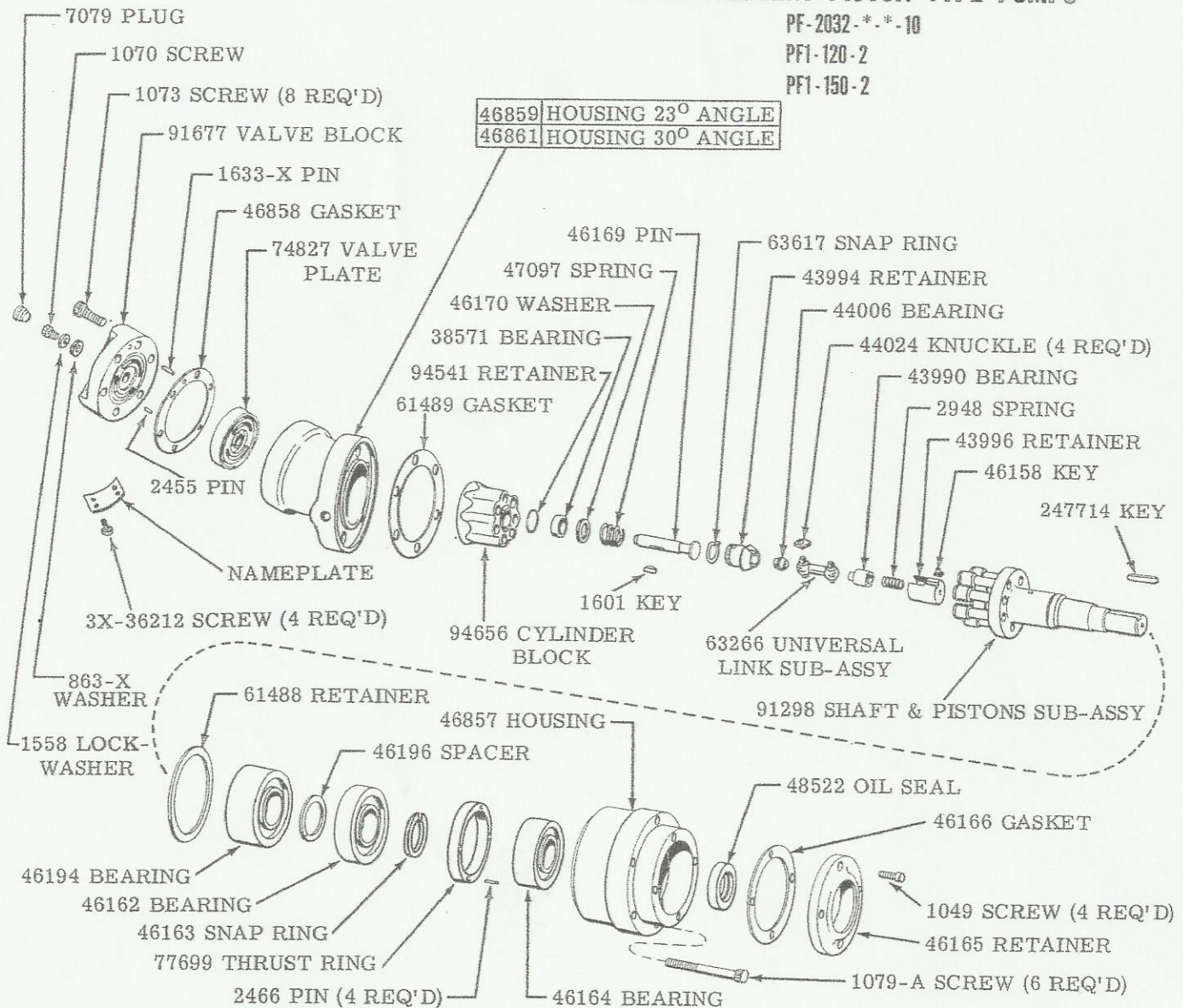

113185 ROTATING GROUP SUBASSEMBLY

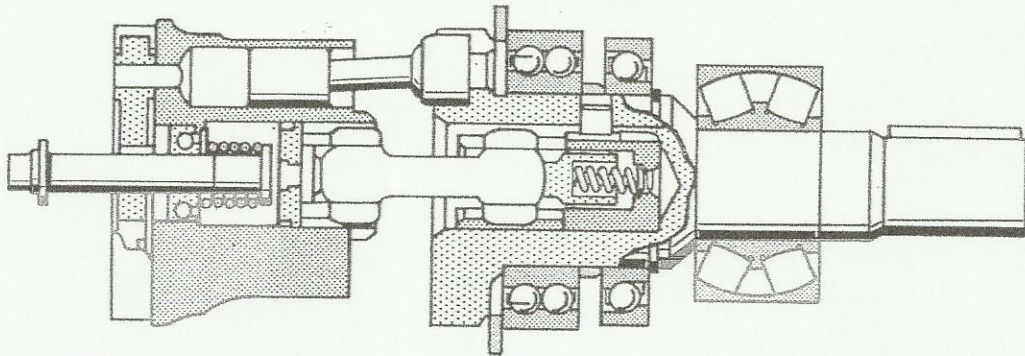

NOTE: THIS CATALOG SUPERSEDES IN PART 922-S, 1228-S AND 1495-S
 To insure sustained efficiency and maximum trouble-free life of this precision equipment, initial and continuous filtration of the fluid medium to 25 microns or less is essential. (For information pertaining to Vickers economical 10 micron filters, see installation drawing I & M 229847.)