

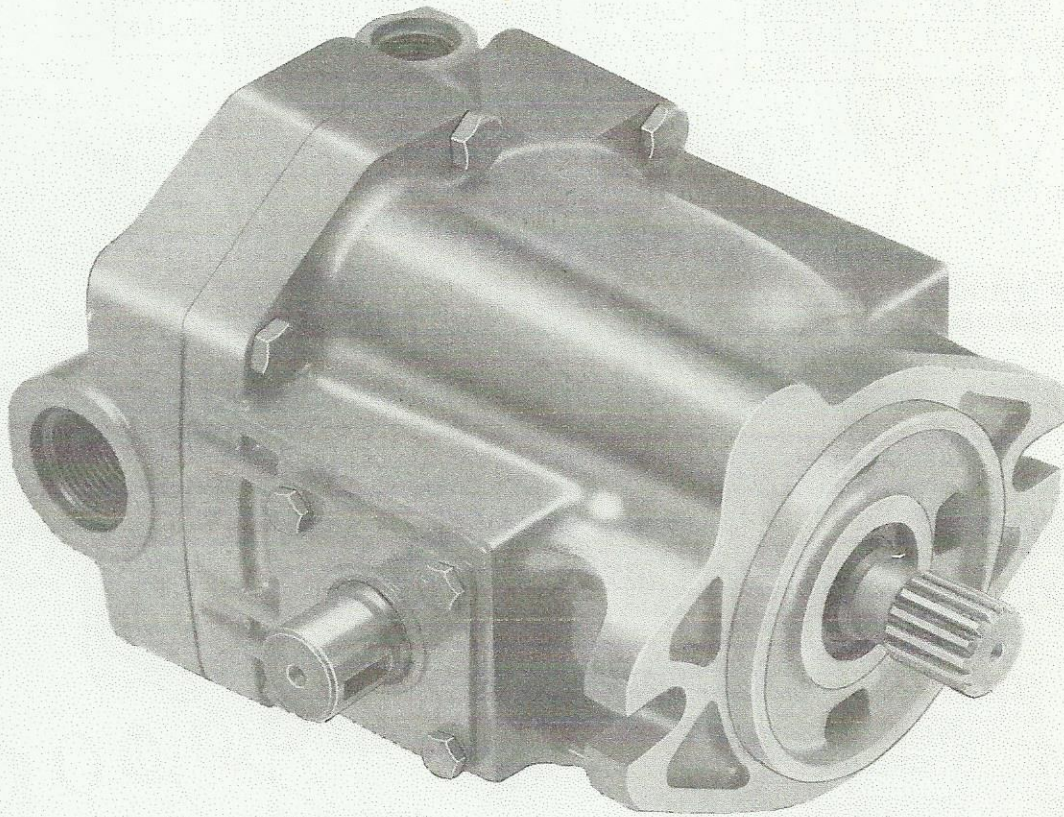

Service Parts Information

Variable
Displacement
Transmission
Motors

MVE-19(X)***-30



Vickers, Incorporated

1401 Crooks Road
Troy, Michigan 48084

Revised 12-1-87

M-2829-S

MVE19(X)-* * * - 30

MODEL	LENGTH
MVE19*-**0-30	3.553
MVE19*-**7-30	3.782
MVE19*-**9-30	3.853
MVE19*-**11-30	3.923
MVE19*-**13-30	3.992
MVE19*-**15-30	4.062

INCLUDED IN	
■ ROTATING GROUP	923941
PINTLE SHIM KIT	923938
BEARING SPACER KIT	942401
▲ SEAL KIT	923940

MODEL	SHAFT	VALVE BLOCK
MVE19-2-** -30	423415	429728
MVE19-6-** -30	435305	
MVE19-9-** -30	424544	
MVE19-17-** -30	575302	435284
MVE19X-2-** -30	423419	
MVE19X-9-** -30	576788	

(M
TO
BO

SHAFT (SE

427172 SCREW (4 REQ'D)
TORQUE TO 170-190 lb. in.

427171 SCREW (6 REQ'D)
TORQUE TO 23-26 lb. ft.

416636
YOKE
(LEFT HAND
PINTLE SHOWN)

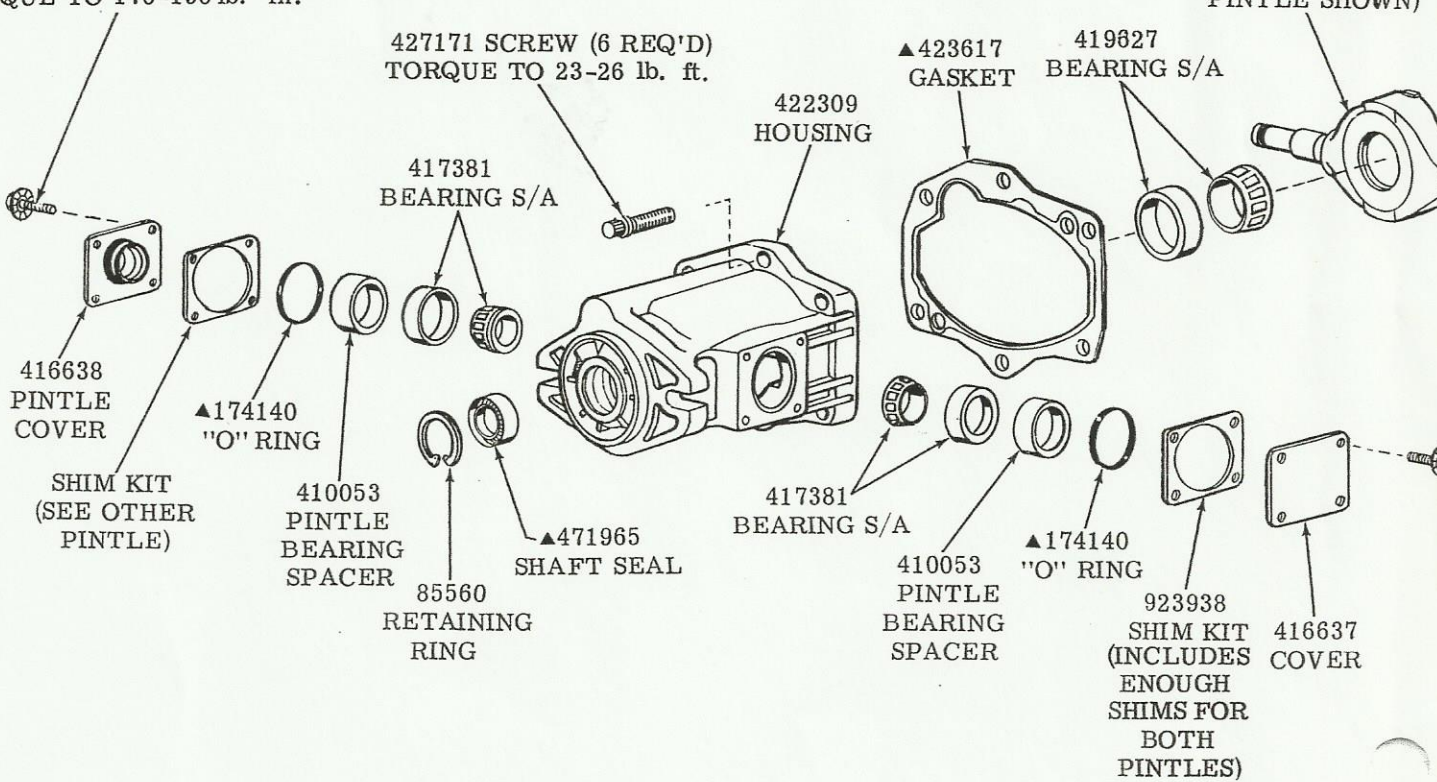

YOKE STOP
 (REFER TO MODEL CODE)
 TORQUE TO 40 - 46 lb. ft.
 (BOND USING LOCTITE
 GRADE 271 COMPOUND)

181792 PLUG
 ▲154130 "O" RING
 D1 DRAIN PORT

VALVE BLOCK (SEE TABLE)
 (TAPE SHAFT SPLINE TO PROTECT
 SEAL WHEN INSTALLING VALVE
 PLATE.) (THROUGH SHAFT MODELS
 ONLY.)

KE ANGLE TO 1° 20'	PART
7°	416670
9°	428863
11°	420935
13°	422227
15°	428858

D2 DRAIN PORT
 248910 PIN
 429325 PIN (2 REQ'D)
 (INSTALL IN HOUSING)

▲ 419671 SHAFT SEAL
 (9X MODELS ONLY) FACE SPRING
 AND BEARING. PRESS UNTIL SEAL
 RIMS AGAINST THE SHOULDER.

939 PISTON SHOE S/A KIT
 (INCLUDES 9 PISTON SHOE S/A)

(ABLE)

■ 402650
 SHOE PLATE

■ 248810 PIN
 (3 REQ'D)

■ 404932
 SPRING
 WASHER

■ 423368
 SPRING
 WASHER

⊖ 942401
 BEARING
 SPACER KIT

473914 BEARING
 S/A

435282 WAFER PLATE

■ 99907 RETAINING RING

■ 418271 SPRING (COLOR
 CODED PURPLE)

■ 432213 CYLINDER BLOCK

■ 410050 PIN RETAINER

■ 402580 SPHERICAL WASHER

⊖ INSTALL WITH CHAMFER
 TOWARD SHAFT SHOULDER.

427172 SCREW (4 REQ'D)
 TORQUE TO 170-190 lb. in.

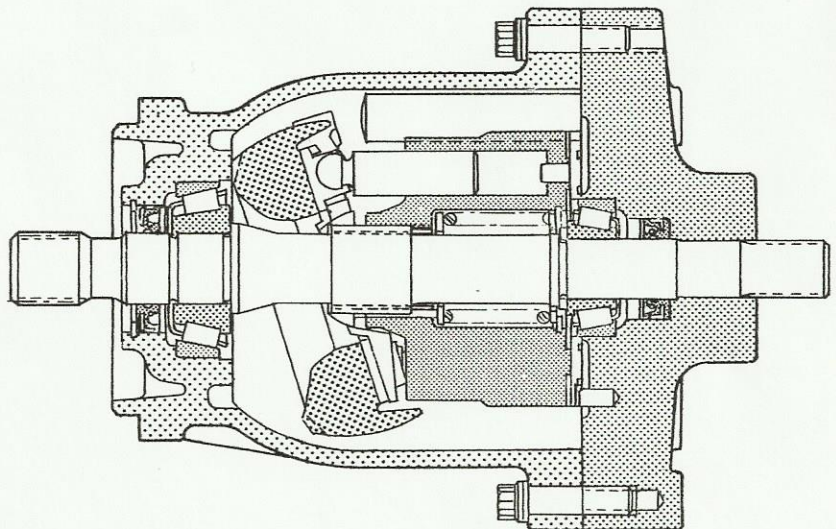

MODEL CODE BREAKDOWN

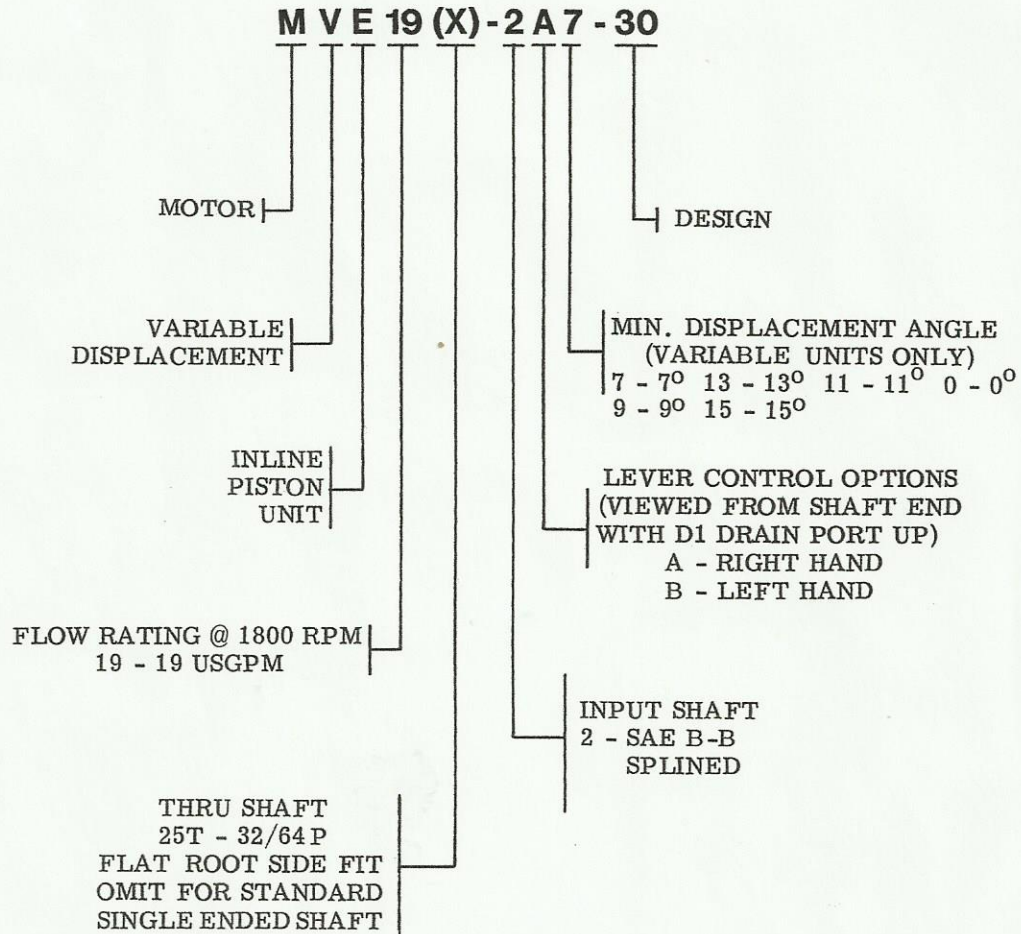

For satisfactory service life of these components, use full flow filtration to provide fluid which meets ISO cleanliness code 19/15 or cleaner. Selections from Vickers OFP, OFR, and OFRS series are recommended.