

MOBILE SERVICE PARTS CATALOG

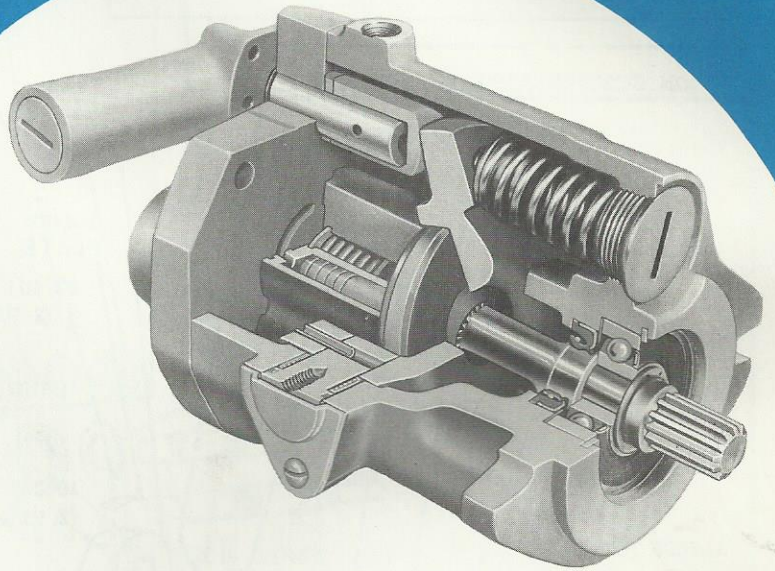

**M-PVB5 AND M-PVB6
-11 DESIGN VARIABLE IN-LINE
PISTON PUMPS**

SPERRY  **VICKERS**

File in Section 2

M-2211-S
Revised 4-1-69

MODEL CODE

M — P
MOBILE PUMP

V
VARIABLE DISPLACEMENT

B
IN-LINE PISTON TYPE

*
G. P. M. RATING AT 1800 R. P. M. 5=5 G. P. M. ECT.

*
ROTATION R = RIGHT HAND L = LEFT HAND

MANUAL LEVER CONTROL

M-PVB*-***-11-M*-10

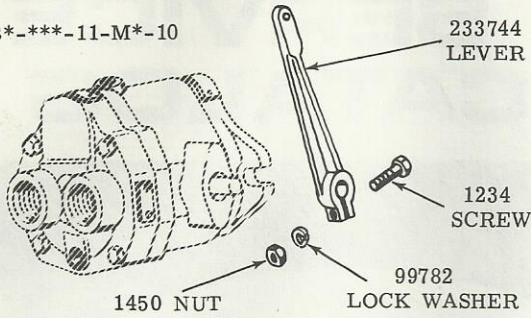

MODEL DESIGNATION	VALVE PLATE S/A INCLUDES 39465 BEARING
M-PVB*-R**-11-C*-10	938552
M-PVB*-L**-11-C*-10	938553
M-PVB*-R**-11-M*-10	938554
M-PVB*-L**-11-M*-10	938555
M-PVB*-U**-11-M*-10	938550

USED ON COMPENSATOR MODELS ONLY

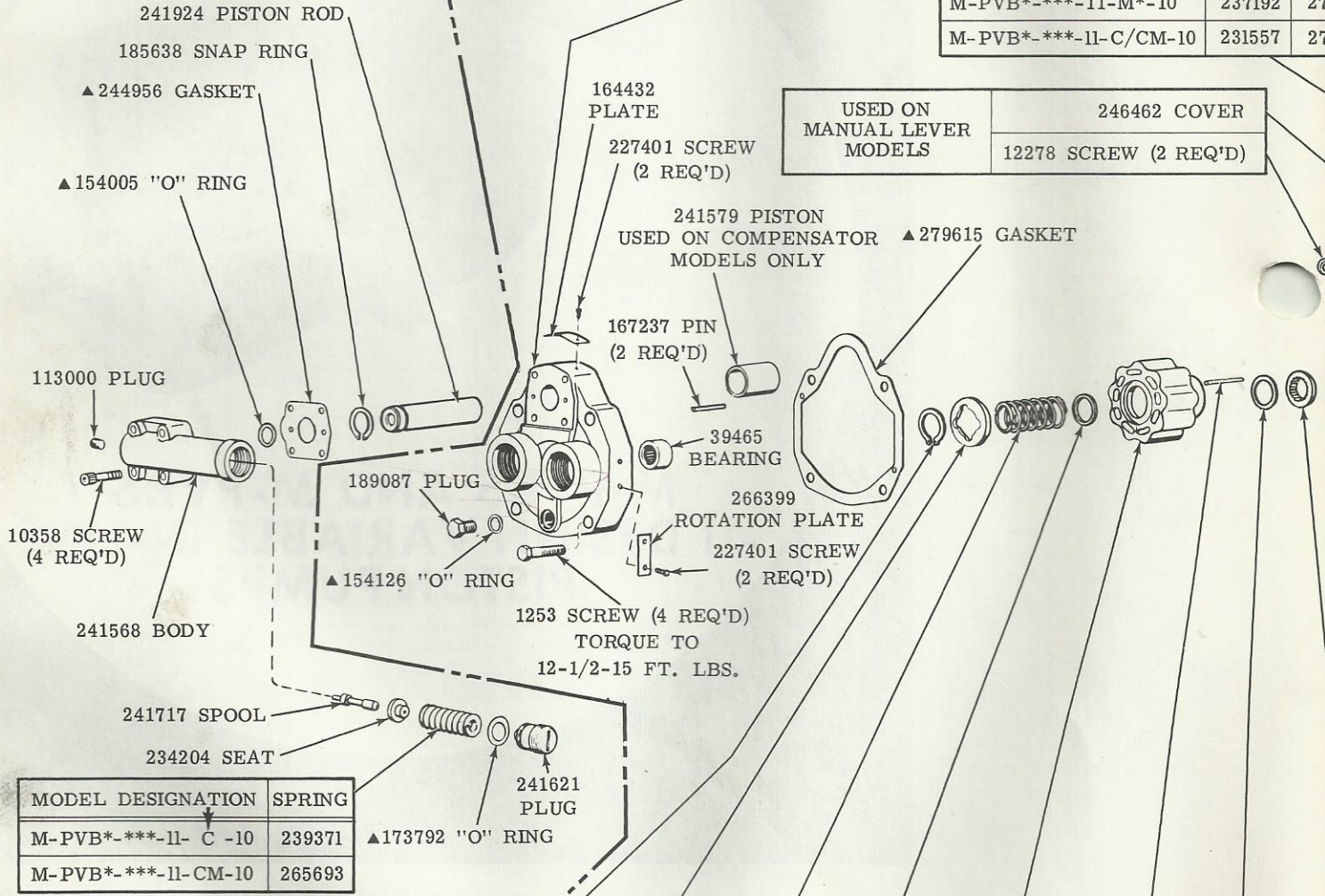

MODEL DESIGNATION	YOKE	HO
M-PVB*-***-11-M*-10	237192	27
M-PVB*-***-11-C/CM-10	231557	27

USED ON MANUAL LEVER MODELS	246462 COVER
	12278 SCREW (2 REQ'D)

MODEL DESIGNATION	SPRING
M-PVB*-***-11-C-10	239371
M-PVB*-***-11-CM-10	265693

MODEL DESIGNATION	SNAP RING	LIFT LIMITER	SPRING	THRUST WASHER	CYLINDER BLOCK	PIN (3 REQ'D)	WASHER	SPI W
M-PVB5-***-11-**-10	165385	273409	274787	275474	274670	248203		
M-PVB6-***-11-**-10					274757			

THESE PARTS ARE SERVICED IN P...

▲ = SERVICED IN SEAL KIT 919191

FOOT MOUNTING BRACKET

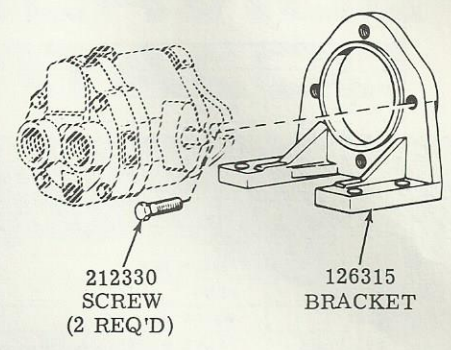

USED ON COMPENSATOR MODELS ONLY

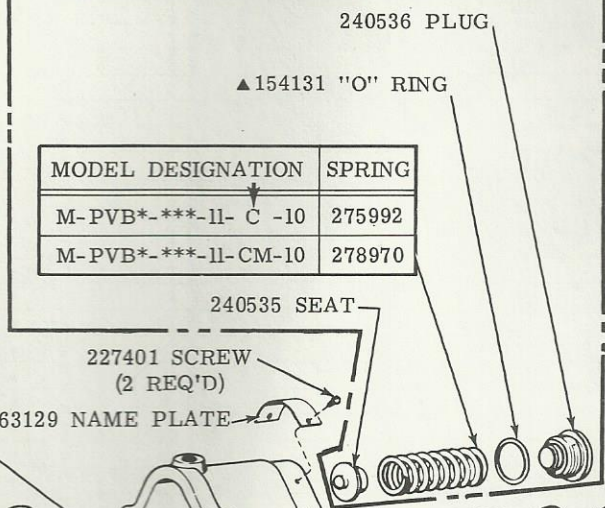

MODEL DESIGNATION	SPRING
M-PVB*-***-11-C-10	275992
M-PVB*-***-11-CM-10	278970

SHAFT	KEY	MODEL DESIGNATION
274673	157671	M-PVB*-** -11-**-10
286848	—	M-PVB*-**G-11-**-10
266162	142843	M-PVB*-**Y-11-**-10

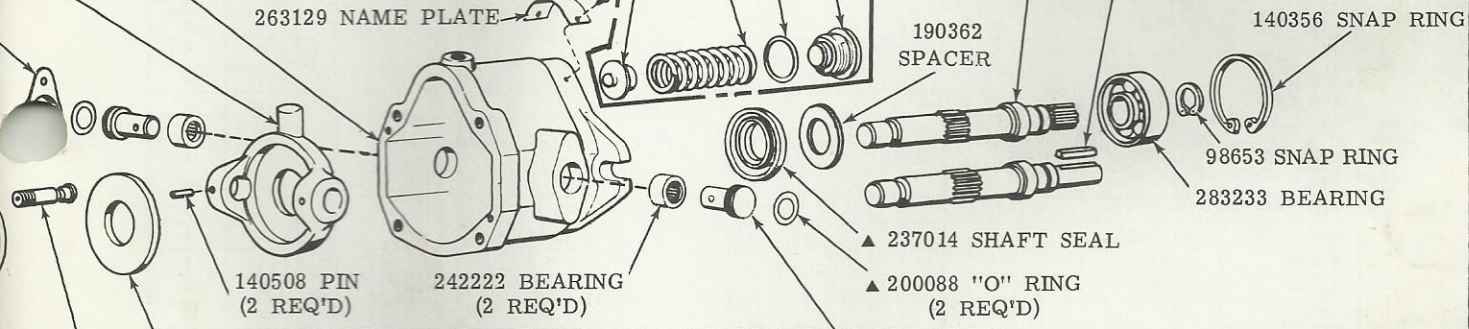

MODEL DESIGNATION	CONTROL TYPE	PINTLES	
		CONTROL SIDE	OPPOSITE SIDE
M-PVB*-***-11-V/M*-10	LEVER	237433	236876
M-PVB*-***-11-C/CM-10	COMPENSATOR	236876	

SHOE PLATE KIT	PISTON KIT (9 PISTONS)	SWASH PLATE	ROTATING GROUP KIT
274249	941793	344049	938262
	941886		938264

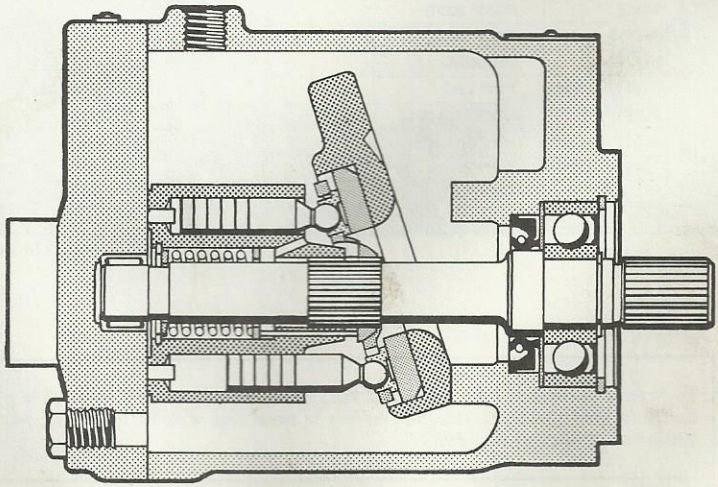

ASSEMBLY VIEW

SPARE PARTS STOCK RECOMMENDATIONS (FOR EACH 100 UNITS IN OPERATION)

PART NUMBER	NAME	M-PVB										QUANTITY PER UNIT	QUANTITY RECOMMENDED FOR STOCK
		G. P. M. RATING	ROTATION	YOKE TRAVEL	SHAFT TYPE	UNIT DESIGN	CONTROL TYPE	CONTROL POSITION	CONTROL DESIGN	SPECIAL FEATURES			
241621	PLUG						C, CM					1	2
SEE PAGE 1	SPRING						C, CM					1	10
234204	SEAT						C, CM					1	15
241717	SPOOL						C, CM					1	5
241568	BODY						C, CM					4	10
10358	SCREW						C, CM					1	2
113000	PLUG						C, CM					1	10
185638	SNAP RING						C, CM					1	10
241924	PISTON ROD						C, CM					1	2
189087	PLUG											4	10
1253	SCREW											1	15
SEE PAGE 1	VALVE PLATE S. A.		L, R				C, M					1	2
266399	ROTATION PLATE											6	2
227401	SCREW											1	2
164432	INSTRUCTION PLATE											1	7
39465	BEARING						C, CM					1	10
241579	PISTON											1	15
165385	SNAP RING	5, 6										• 1	15
273409	LIFT LIMITER	5, 6										• 1	15
274787	SPRING	5, 6										• 1	10
275474	WASHER	5, 6										• 1	15
SEE PAGE 1	CYLINDER BLOCK	5, 6										• 1	15
248203	PIN	5, 6										• 3	10
274956	WASHER	5, 6										• 1	10
275485	SPHERICAL WASHER	5, 6										• 1	10
274249	PLATE	5, 6										• 1	15
SEE PAGE 2	PISTON KIT (9 PISTONS)	5, 6										• 1	15
344049	SWASH PLATE	5, 6										• 1	15
SEE PAGE 2	ROTATING GROUP KIT	5, 6										1	15
240508	PIN											2	10
SEE PAGE 2	YOKE						C, M					1	5
SEE PAGE 2	HOUSING						C, M					1	2
246462	COVER						M					1	5
12278	SCREW						M					2	10
167237	PIN											2	10
167237	PIN											1	2
263129	NAME PLATE											1	2
240535	SEAT						C, CM					1	10
SEE PAGE 2	SPRING						C, CM					1	10
240536	PLUG						C, CM					1	2
190362	WASHER											1	5
SEE PAGE 2	SHAFT				G							1	7
157671	KEY											1	7
283233	BEARING											1	7
98653	SNAP RING											1	10
140356	SNAP RING											1	10
242222	BEARING											2	15
SEE PAGE 2	PINTLES						C, M					2	15
99782	LOCK WASHER						M					1	10
1450	NUT						M					1	10
1234	SCREW						M					1	10
233744	LEVER						M					1	10
919191	SEAL KIT											1	25

CONTACT VICKERS APPLICATION ENGINEER FOR SPECIAL FEATURE INFORMATION

• MAY BE PURCHASED IN ROTATING GROUP KIT

To insure sustained efficiency and maximum trouble-free life of this precision equipment, initial and continuous filtration of the fluid medium to 25 microns or less is essential. For information pertaining to Vickers economical 10 micron filters, see installation drawing M 229847.

COMMENTS OR SUGGESTIONS CONCERNING THIS PUBLICATION MAY BE DIRECTED TO THE MOBILE SERVICE DEPARTMENT OF VICKERS