

Variable Inline Piston Pumps

M-PVB45 -10 Design

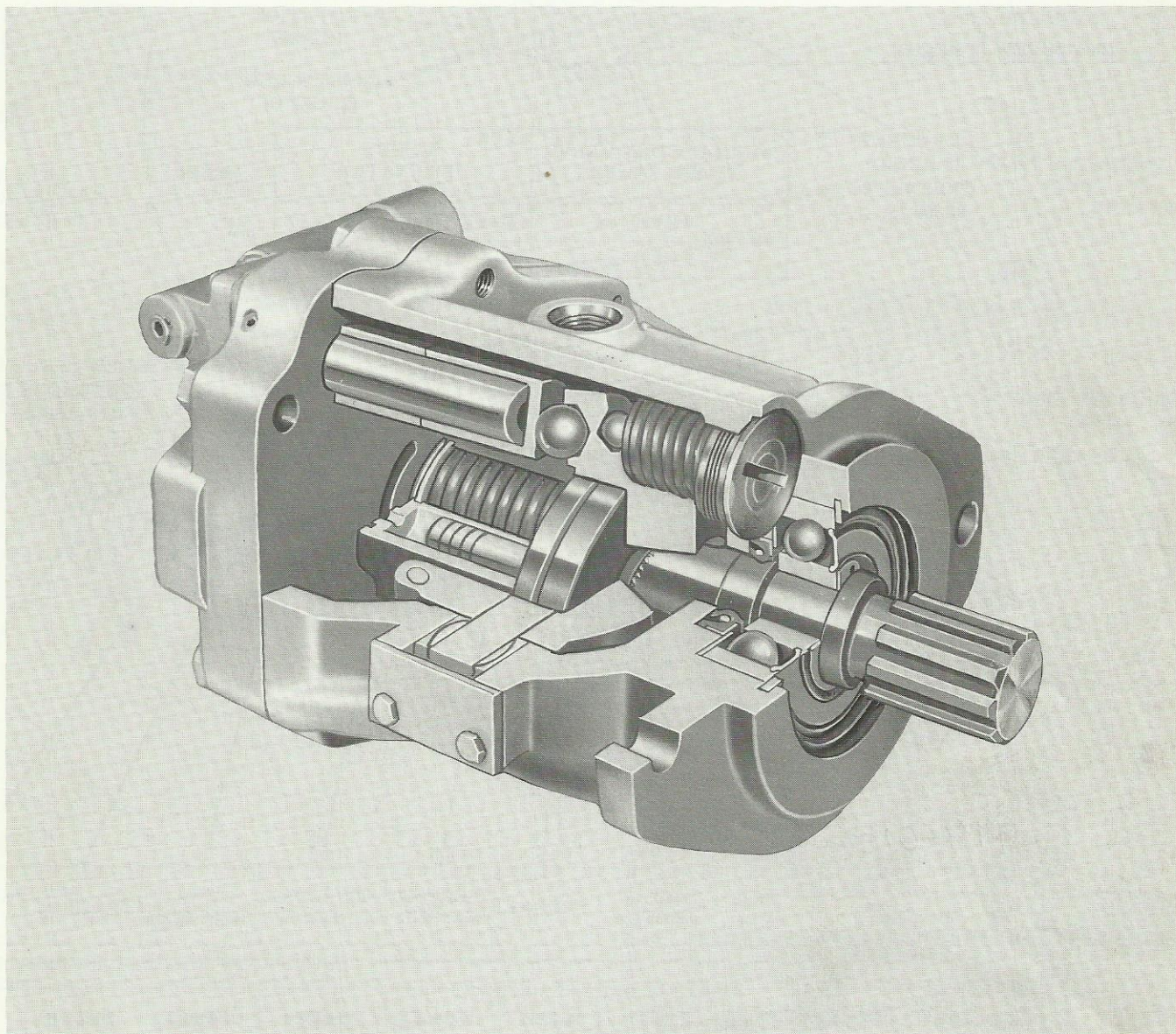

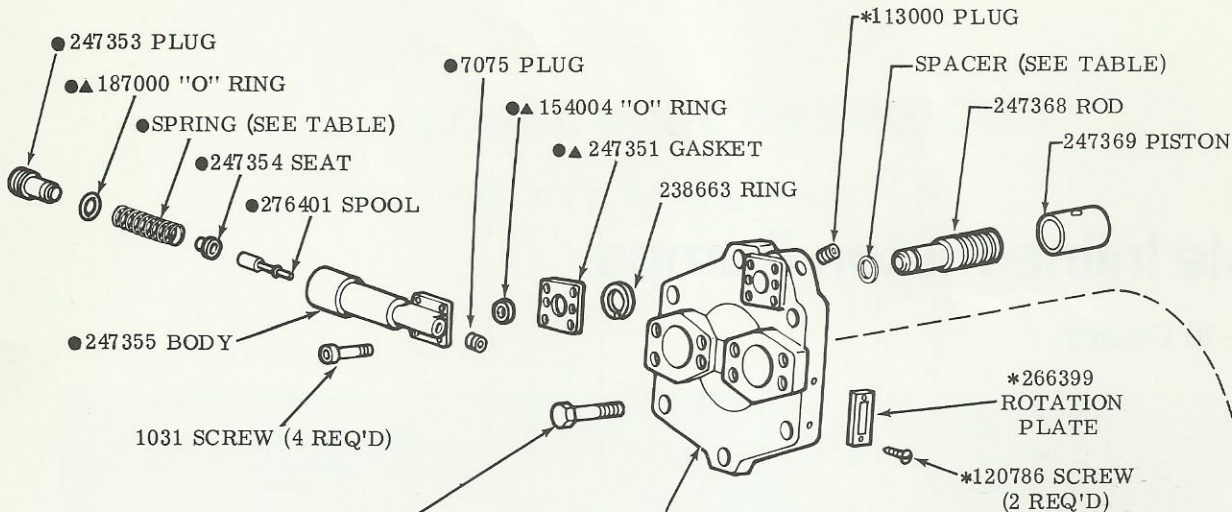

MODEL	SPACER
C/CM	—
C(M)7	307051
C(M)8	306825
C(M)9	307050

*INCLUDED IN VALVE PLATE S/A KIT.	MODEL DESIGNATION
941890	M-PVB45-R**-10-C-10
941891	M-PVB45-L**-10-C-10

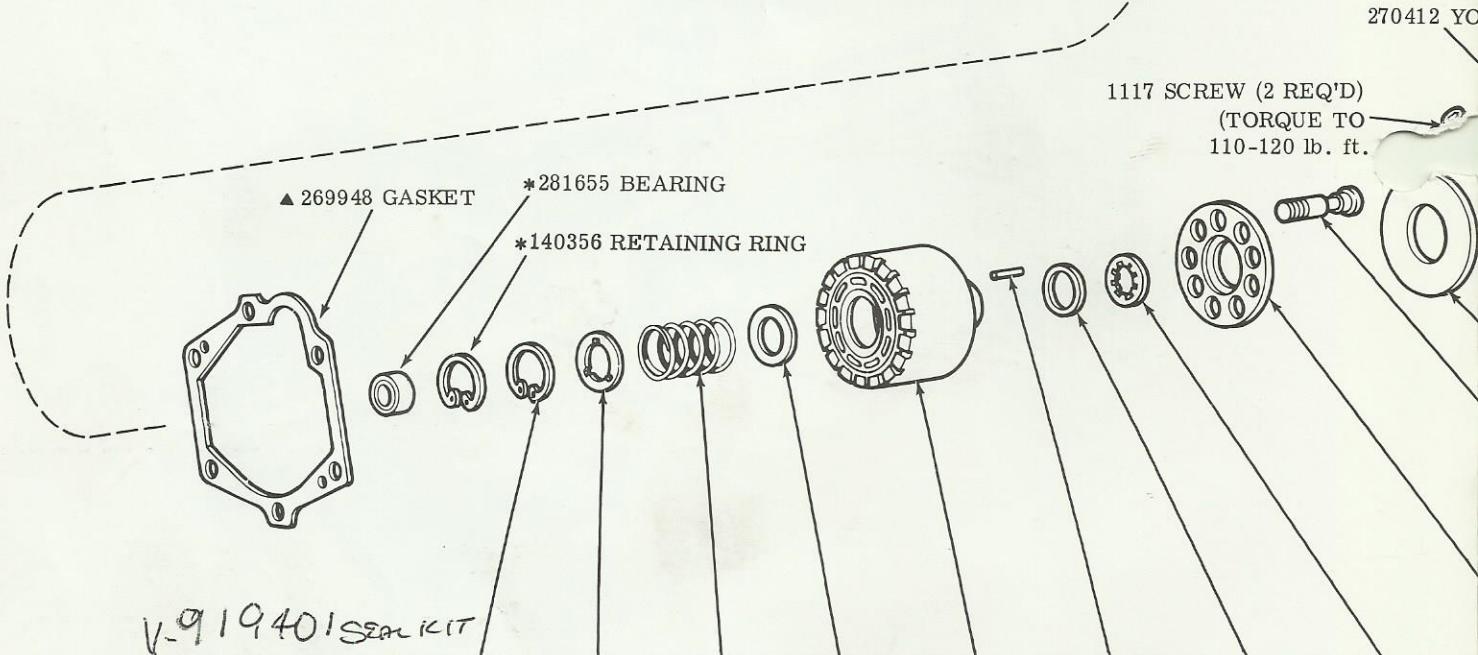
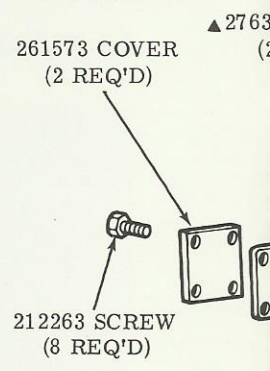

MODEL DESIGNATION	RET. RING	LIFT LIMITER	SPRING	THRUST WASHER	CYLINDER BLOCK	PIN (5 REQ'D)	WASHER	SPHERICAL WASHER
THESE PARTS SERVICED IN ROTATING GROUP								
M-PVB45***-10-*-10	126911	246017	282557	253665	344064	248883	253664	241541

● INCLUDED IN COMPENSATOR KIT

COMPENSATOR ●TYPE	SPRING	COMPENSATOR KIT
C	245087	941744
CM	285870	941745

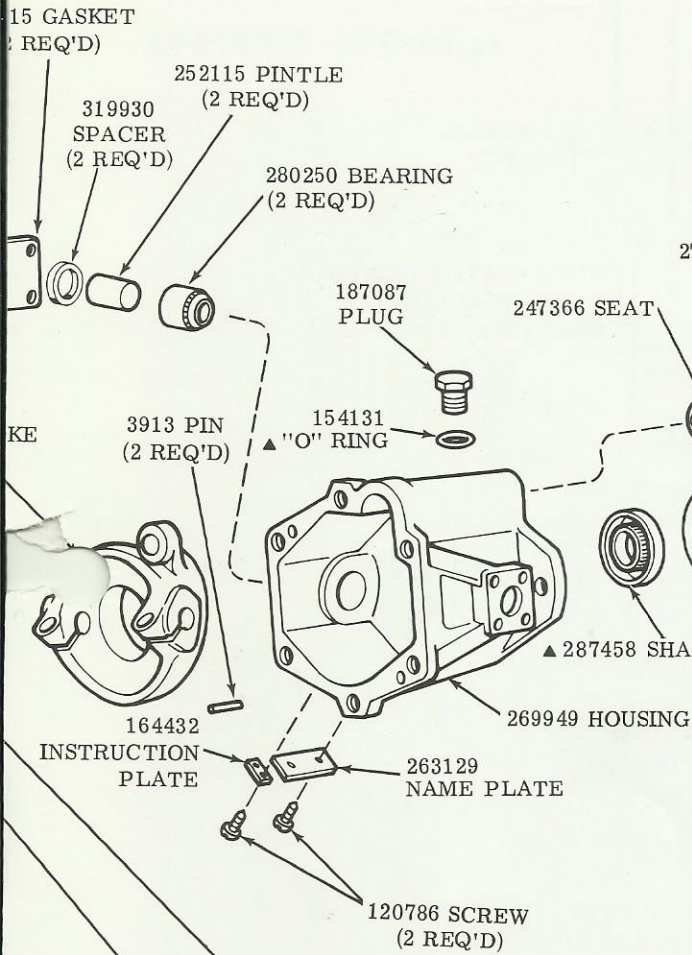

FOOT MOUNTING BRACKET

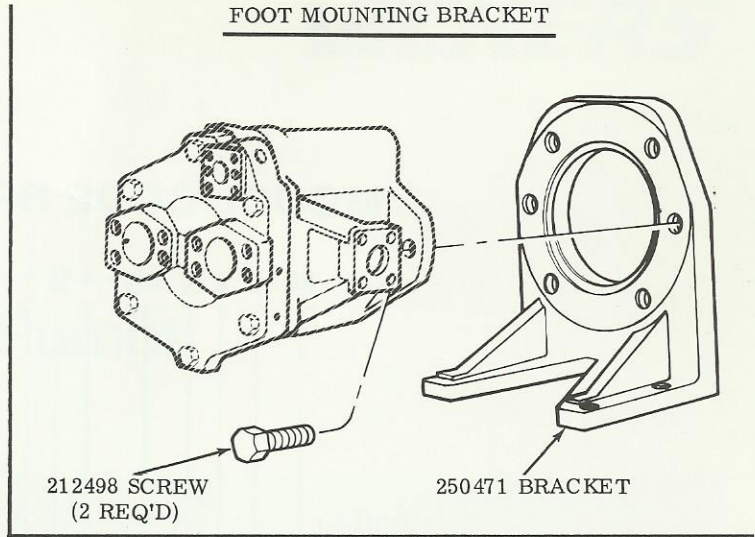

SHOE PLATE	PISTON KIT (9 PISTONS)	SWASH PLATE	ROTATING GROUP KIT
266112	923189	241543	938286

MODEL DESIGNATION	SHAFT	KEY
M-PVB*-**F-10-*10	247371	247101
M-PVB*-**E-10-*10	318548	—

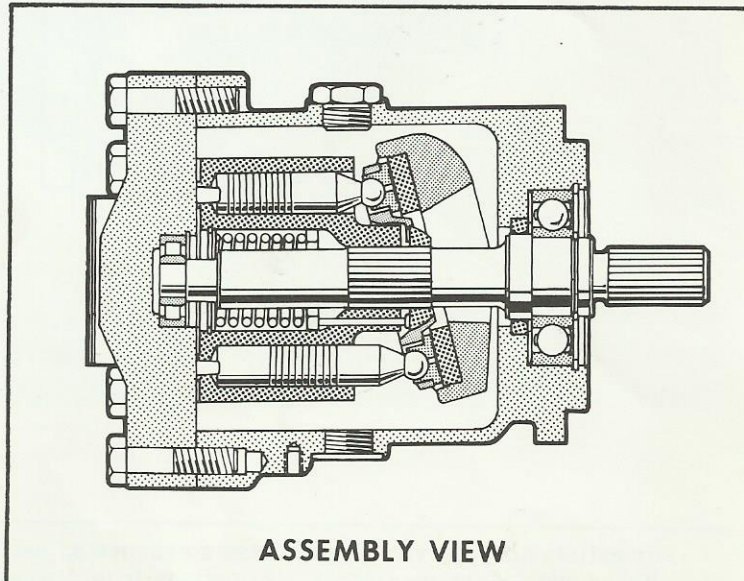

MODEL CODE BREAKDOWN

M - P V B 45 - * S * - 10 * * - 10

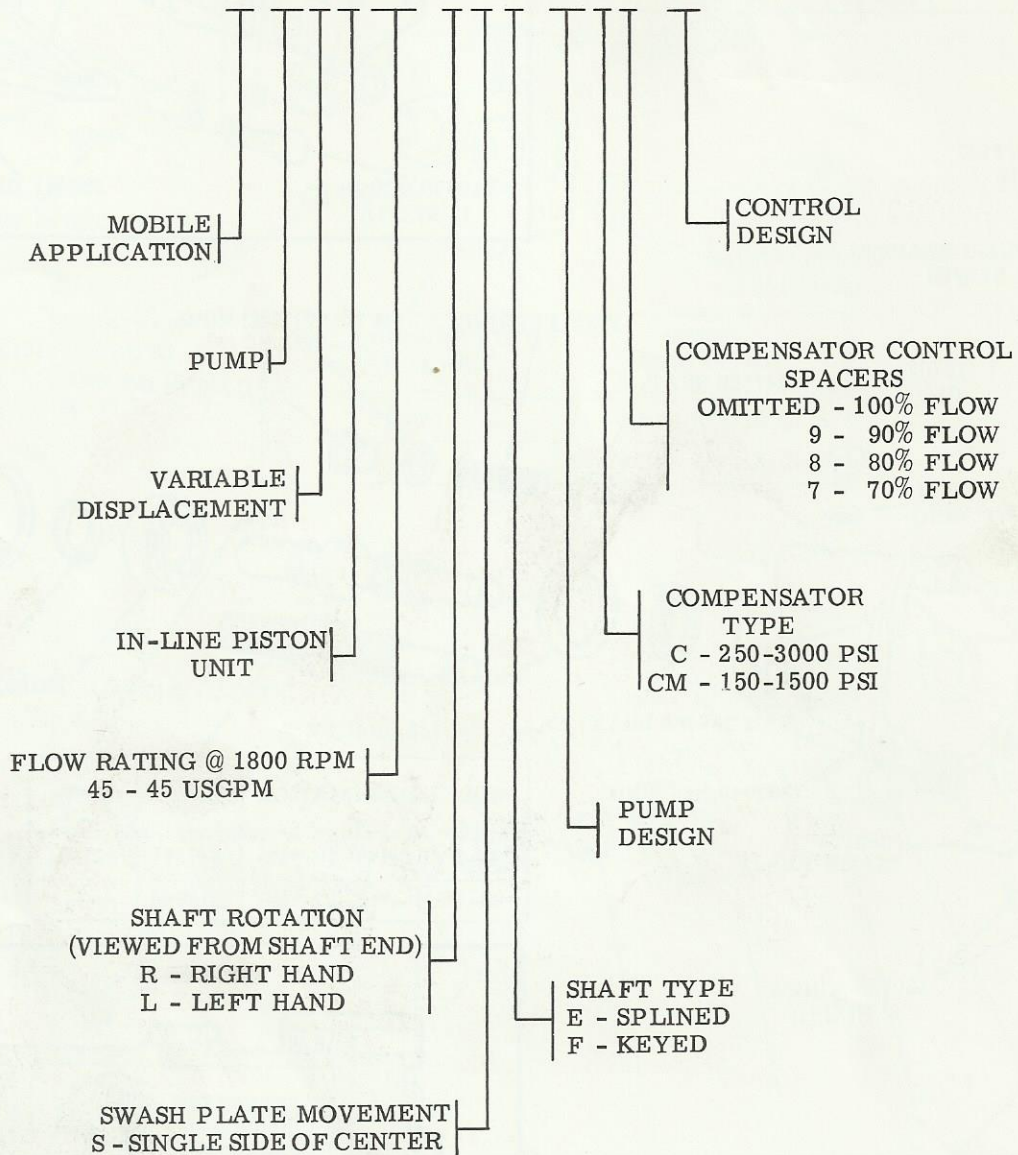

For satisfactory service life of these components, use full flow filtration to provide fluid which meets ISO cleanliness code 16/13 or cleaner. Selections from Vickers OFP, OFR, and OFRS series are recommended.