

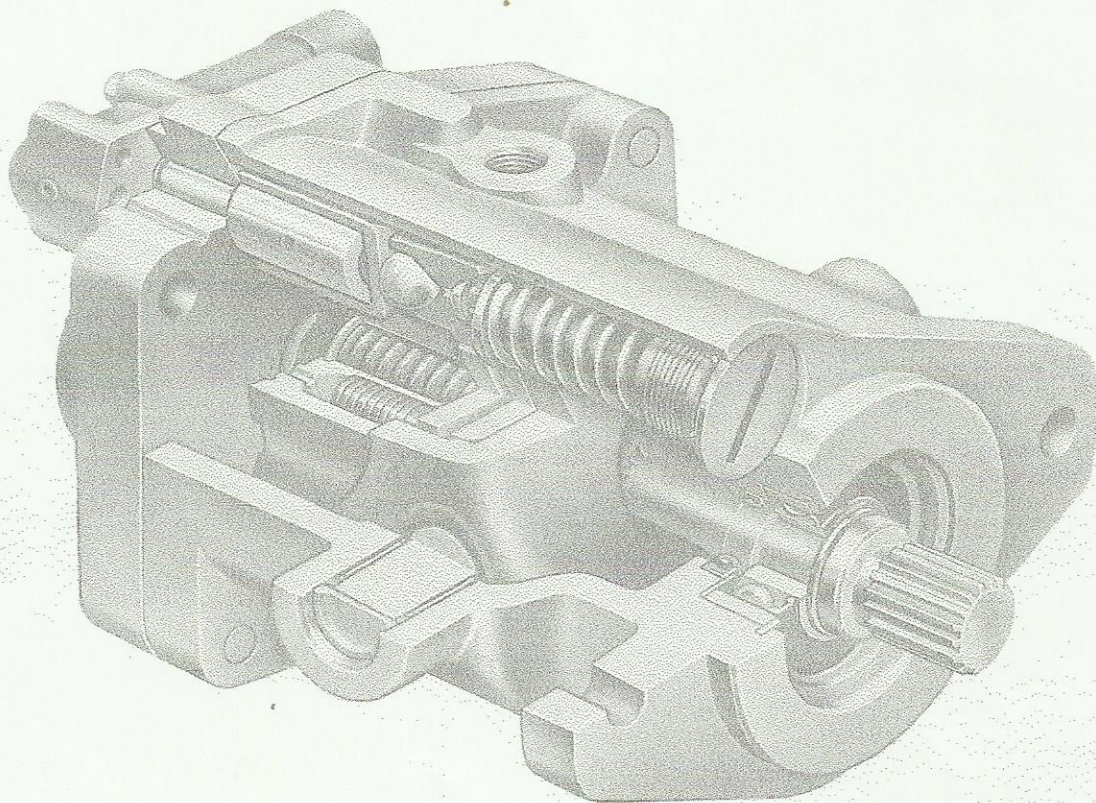

# Service Parts Information

Variable  
Inline  
Piston  
Pumps

M-PVB20  
M-PVB29  
10 Design



Vickers, Incorporated

1401 Crooks Road  
Troy, Michigan 48064

Revised 12-1-87

M-2213-S

**WARNING: USE THIS DRAWING FOR PARTS INFORMATION ONLY. SEE OVERHAUL MANUAL AA-220**

STEM SERVO CONTROL  
M-PVB\*-\*\*\*-10/11-D\*-10

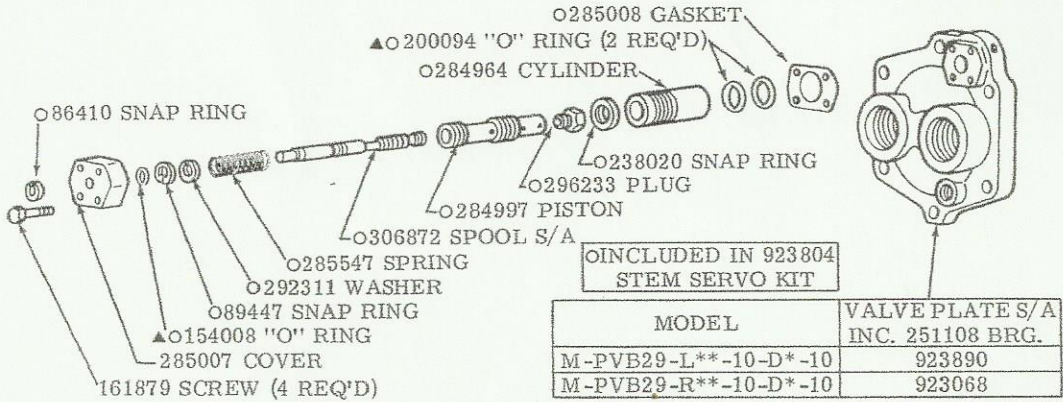

INCLUDED IN COMPENSATOR SUBASSEMBLY KIT

SEAL	SEAL WIRE	PLUG	BACK UP RING	"O" RING	SPRING	SEAT	SPOOL	BODY	"O" RING	GASKET	COMP. KIT	CONTROL
—	—	241621	—	262335	239371	234204	241717	241568	154005	244956	941700	C
—	—	—	—				285624				—	923990
17079	17077	412940	197573				296234	412890			942480	CG
—	—	—	—				417649	278711			942441	CV

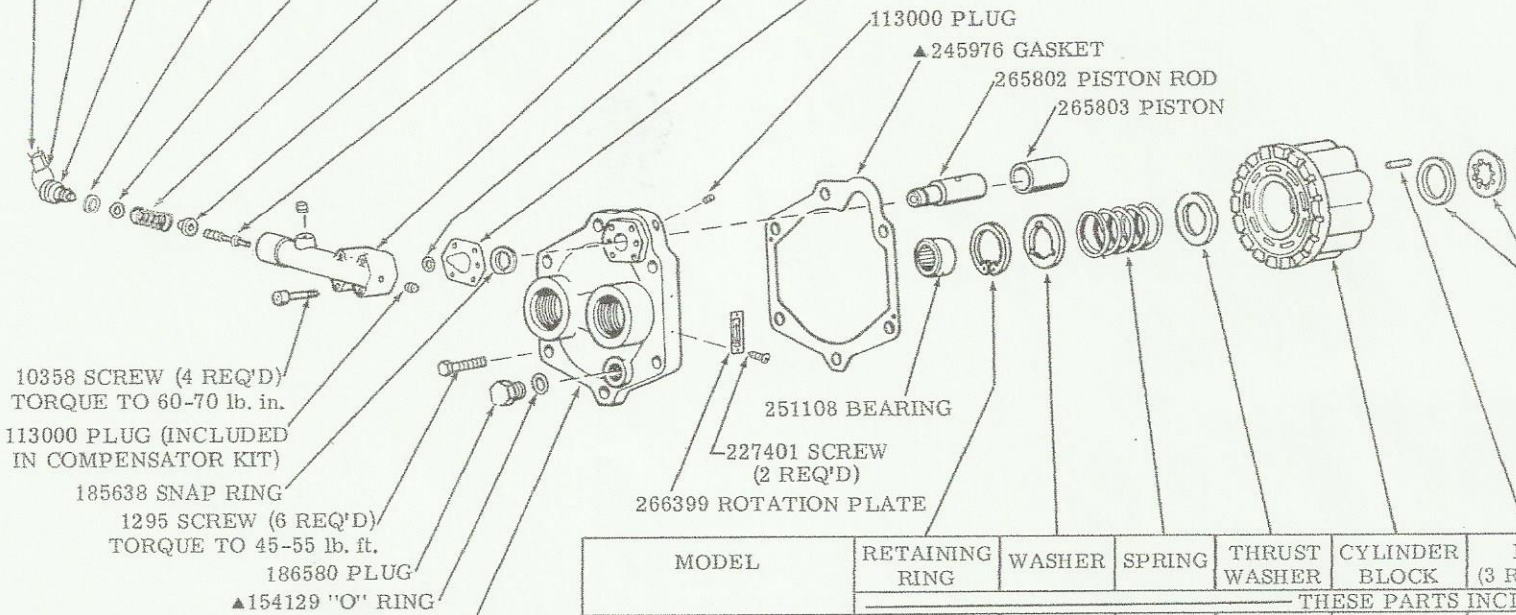

MODEL	RETAINING RING	WASHER	SPRING	THRUST WASHER	CYLINDER BLOCK	F (3 R)
M-PVB20-***-10-*-10	194025	244931	246386	238780	250688	24
M-PVB29-***-10-*-10			263582		259458	

THESE PARTS INCL

MODEL	VALVE PLATE S/A INC. 251108 BEARING
M-PVB20-R**-10-C-10	938400
M-PVB20-L**-10-C-10	938401
M-PVB29-R**-10-C-10	938404
M-PVB29-L**-10-C-10	938405

# EAR MAINTENANCE INFORMATION

## FOOT MOUNTING BRACKET KIT

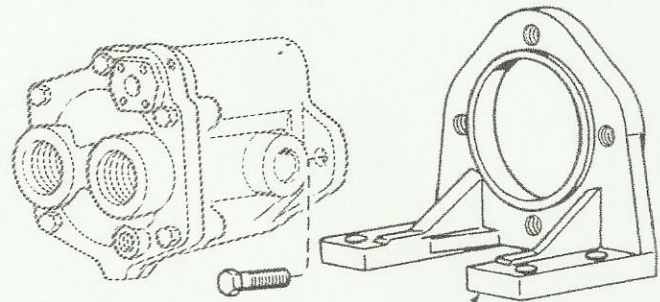

FB-C-10  
(INCLUDES SCREWS)

SEAT	SPRING	PLUG	MODEL
245975	436335	245973	M-PVB2*-***-11-C/CG-*0
306370	306434	306369	M-PVB2*-***-11-CR-10
245975	436335	245973	M-PVB2*-***-11-CV/D-*0

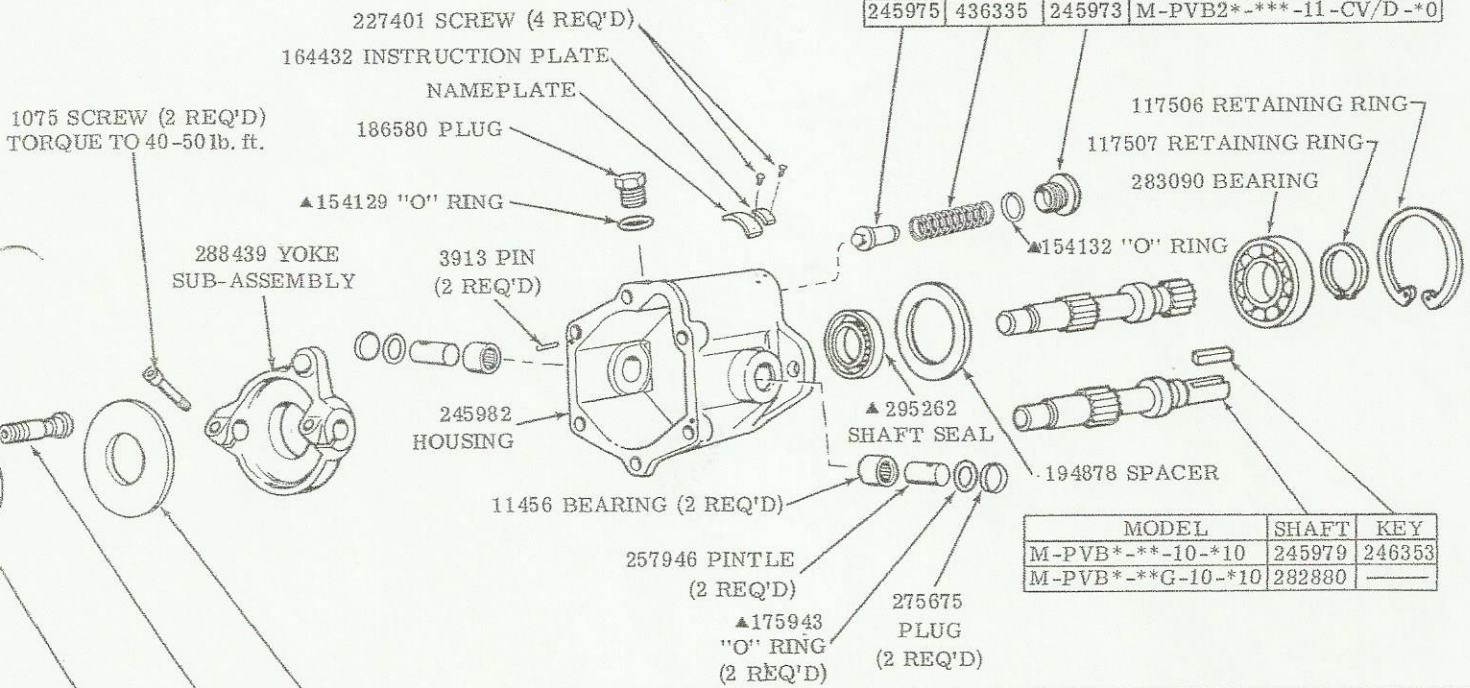

MODEL	SHAFT	KEY
M-PVB*-**-10-*10	245979	246353
M-PVB*-**G-10-*10	282880	

SPHERICAL WASHERS/A	SHOE PLATE	PISTON KIT (9 PISTONS)	SWASH PLATE	ROTATING GROUP KIT
IN ROTATING GROUP KIT				
938392	248609	941883	239335	938280
		941888		938290

▲ INCLUDED IN  
923006 SEAL KIT

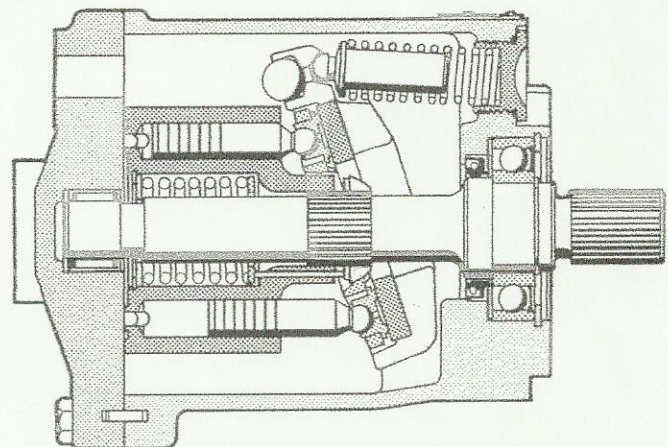

# MODEL CODE BREAKDOWN

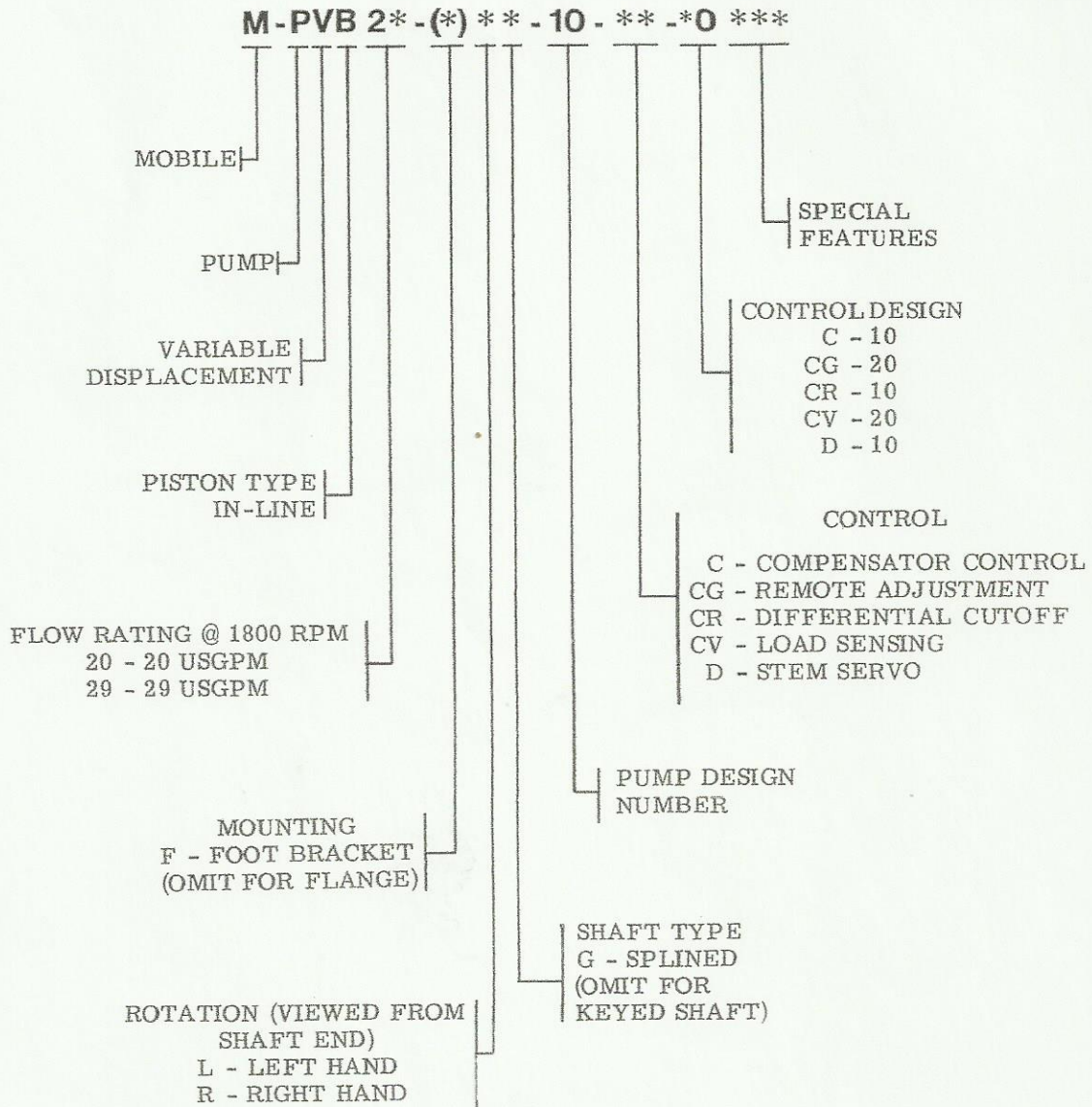

For satisfactory service life of these components, use full flow filtration to provide fluid which meets ISO cleanliness code 16/13 or cleaner. Selections from Vickers OFF, OFR, and OFRS series are recommended.