



INLINE
CHECK
VALVE

Service Parts Information

DS8P1-10/-11

DT8P1-10/-11

BODY - SOLD AS AN ASSEMBLY ONLY.
ORDER BY MODEL NUMBER.

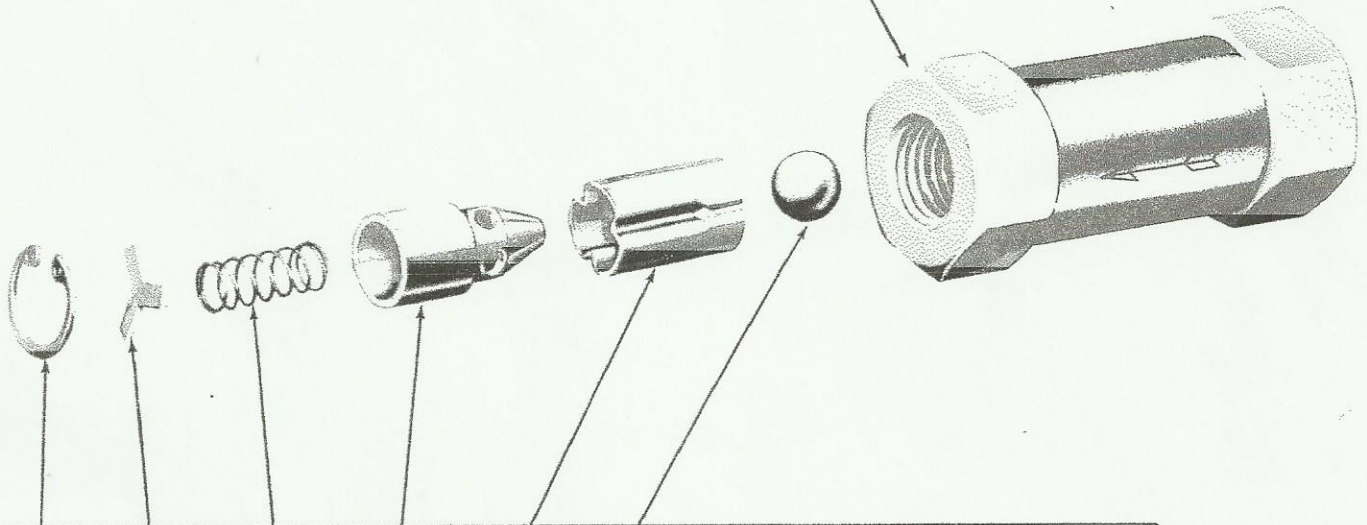

RET. RING	WASHER	SPRING	POPPET	SLEEVE	BALL	PIPE SIZE	CRACKING PRESSURE P. S. I.	MODEL
92733	113714	113559	—	113715	1651	1/4	5	DT8P1-02-5-10
		216999					30	DT8P1-02-30-10
		114094					65	DT8P1-02-65-10
106642	123740	123761	123737	—	—	3/8	5	D*8P1-03-5-10
		217000					30	DT8P1-03-30-10
		123760					65	D*8P1-03-65-10
98702	125673	125779	125674	—	—	3/4	5	D*8P1-06-5-11
		222541					15	D*8P1-06-15-11
		418556					20	DT8P1-06-20-11
		216998					30	D*8P1-06-30-11
		425262					40	DT8P1-06-40-11
		580963					50	DT8P1-06-50-11
		125780					65	D*8P1-06-65-11
113752	125635	125631	125634	—	—	1- $\frac{1}{4}$	5	D*8P1-10-5-11
		312094					15	DT8P1-10-15-11
		216548					30	DT8P1-10-30-11
		257354					50	DT8P1-10-50-11
		125632					65	D*8P1-10-65-11
		582338					95	DT8P1-10-95-11

MODEL CODE BREAKDOWN

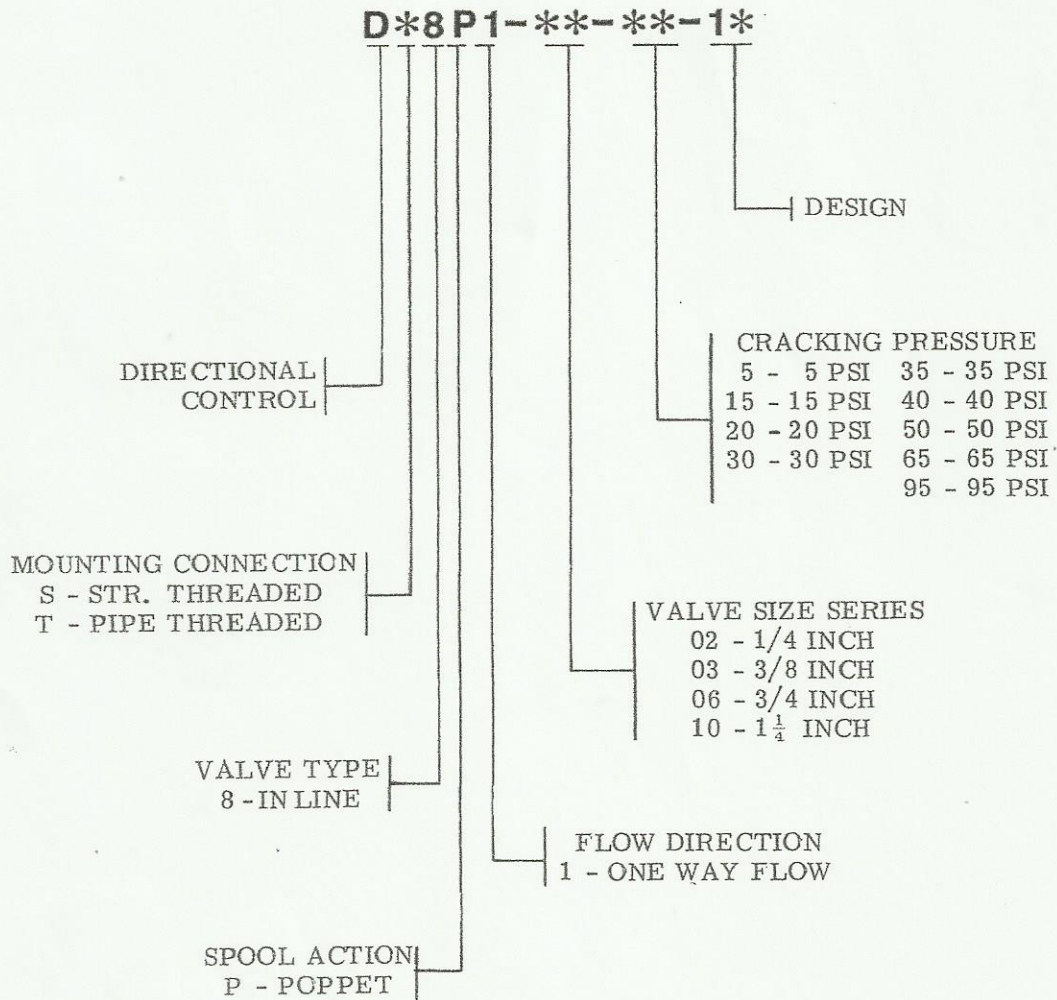

For satisfactory service life of these components in industrial applications, use full flow filtration to provide fluid which meets ISO cleanliness code 18/15 or cleaner. Selections from Vickers OFP, OFR, and OFRS series are recommended.