

| MODEL | BODY |
|-------|--------|
| X | 531434 |
| Y | 531433 |

REPLACEMENT PARTS FOR THIS UNIT ARE AVAILABLE IN SERVICE KITS. PARTS PREFIXED BY AN ◆ CAN BE OBTAINED INDIVIDUALLY. BODIES ARE NOT AVAILABLE FOR SALE.

NOT AVAILABLE FOR SALE

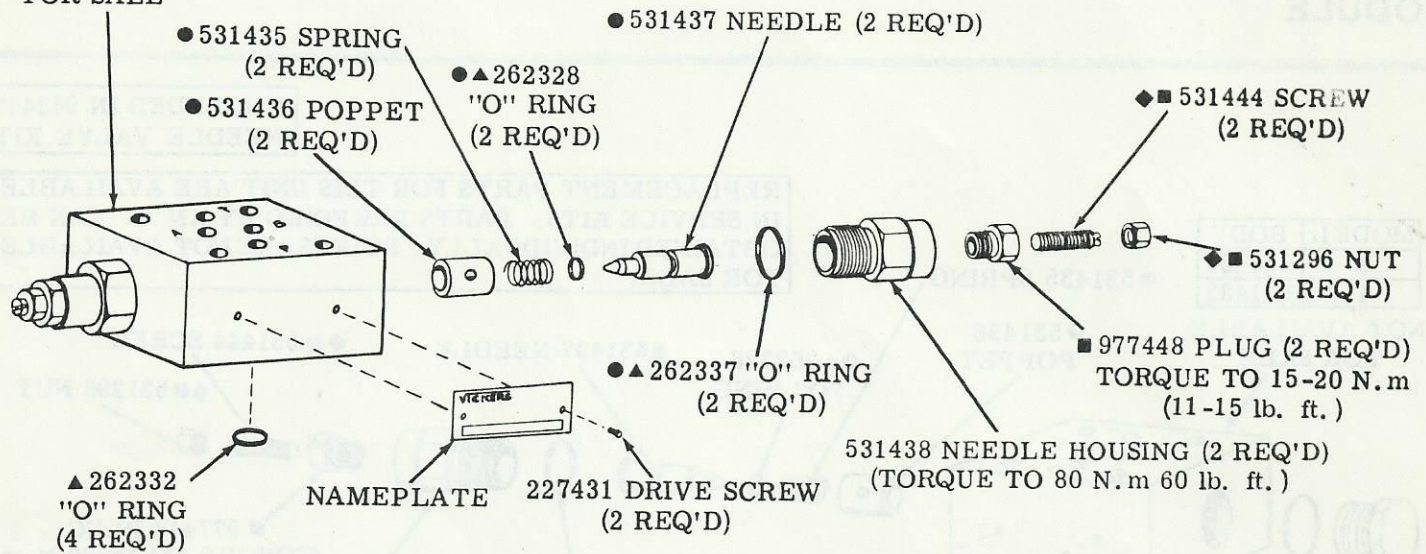

● INCLUDED IN 942447 NEEDLE VALVE KIT

▲ INCLUDED IN 920084 SEAL KIT

■ ONE EACH INCLUDED IN ADJUSTMENT SCREW KIT 942445

MODEL CODE BREAKDOWN

DGM FN-3-* - A 2W-B2W-20

